

MICHIGAN
DEPARTMENT OF CONSERVATION
FORESTRY DIVISION

LAND CORNER RECORD

T. 48-49N N.R. 8W

Luce COUNTY

DESCRIPTION OF CORNER $\frac{1}{4}$ Cor. bet. Secs. 4-33.

CORNER MONUMENT 1" pipe with 4" aluminum cap.

DATE MONUMENT PLACED AND WITNESSED 8-13-70

WITNESSES TO CORNER..... 15" W. Pine ($\frac{1}{4}$ S NBT) S27°E 32.0'

17" R. Pine ($\frac{1}{4}$ S NBT) N24°W 5.2'

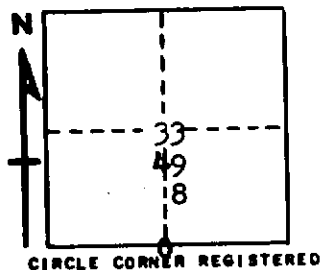

AND

DESCRIPTION IN DETAIL AS TO HOW CORNER WAS LOCATED AND IDENTIFIED OR RESTORED.

This corner replaced as set by H. Lawrence, R.L.S. about 1939. Found wood post in place with a 10" B.Spruce, bearing N68°E 21.3 feet, scribed as a witness tree, at that time.

Corner lies 50' East of a logging trail.

Corner found by L. Rubick, Forestry Aide in 1958.

SURVEYOR'S SEAL

SIGNED *Billy D. Buckler* DATE 8-26-70
REGISTERED LAND SURVEYOR