

✓

MICHIGAN
DEPARTMENT OF CONSERVATION
FORESTRY DIVISION

LAND CORNER RECORD

T. 48-49N N.R. 9W

Luce COUNTY

DESCRIPTION OF CORNER Sec. cor. common to Secs. 5-6-31-32

CORNER MONUMENT 1" pipe with 4" aluminum cap

DATE MONUMENT PLACED AND WITNESSED 9-8-70

WITNESSES TO CORNER... 9" jack pine (S6 NBT) S48°W 21.8'

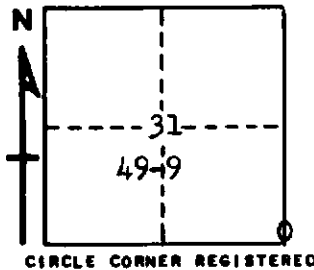

7" jack pine (S31 NBT) N47°W 19.0'

AND

DESCRIPTION IN DETAIL AS TO HOW CORNER WAS LOCATED AND IDENTIFIED OR RESTORED.

This corner replaced from three probable witnesses; a 28" W. Pine stump bearing N84°W, 16 links, a W. Pine stump bearing S50°E, 55 lks and a W. Pine stump bearing S36°W, 49 lks. No positive marks on these stumps. Found several old blazes south and west of corner. Checked north 9.72 chs. to top of ridge. The W. Pine stump, bearing S36°W is recorded as S36°E. Believe this to be a recording error.

SURVEYOR'S SEAL

Billy D. Buckler
SIGNED Billy D. Buckler DATE 9-21-70
REGISTERED LAND SURVEYOR