

**LAND CORNER RECORDATION CERTIFICATE**  
**Filing Requirement of Act 74, Mich. P.A. 1970**

For corners in  
Luce

(County)	Located In:	Corner Code #
1. Public Land Survey	T 49N R 9W	G1
	T 49N R 9W	H1
	T _____ R _____	_____
	T _____ R _____	_____
2. Property Controlling in Section	S _____ T _____ R _____	_____
	S _____ T _____ R _____	_____
3. Miscellaneous Property in Sec.	S _____ T _____ R _____	_____
	S _____ T _____ R _____	_____

Register of Deeds Stamp & File Number

4. Lot No. \_\_\_\_\_, Recorded Plat \_\_\_\_\_  
 5. Private Claims \_\_\_\_\_

Jun 25 2001

I, Stephan J. Szyszkoski, in a field survey on \_\_\_\_\_, 19\_\_\_\_\_, do hereby certify that under requirements of P.A. 74, Michigan P.A. of 1970, the corner points mentioned in lines 1 and 2 above were in conformance with regulations and rules therefore as required in the current manual of survey instructions of the United States Department of the Interior, Bureau of Land Management or by a decree of a Court of Law and/or that the corner points mentioned in lines 3, 4 and 5 above were in conformance with the rules of the Michigan Board of Land Surveyors or by a Decree of a Court of Law; established, re-established, monumented, re-monumented, recovered, found as expressed below:

**NOTE: Not more than 4 corners, all in the same town and range, may be recorded on this certificate.**

	A	B	C	D	E	F	G	H	I	J	K	L	M
2	6		5		4		3		2		1		
3													
4	7		8		9		10		11		12		
5													
6	18		17		16		15		14		13		
7													
8	19		20		21		22		23		24		
9													
10	30		29		28		27		26		25		
11													
12	31		32		33		34		35		36		
13													

A. Description of original monument and accessories and/or subsequent restoration:

G1) Corner common to Sections 3-4 T49N-R9W and 33-34 T50N-R9W. Reestablished by Marcus Schaaf, RLS and perpetuated in 1958 by Billy D. Buckler RLS: 2" iron pipe buried in intersection of N-S-E-W firelanes. 6" Jackpine S35E 43 links, 5" Jackpine N62E 56 links, 8" Jackpine N47W 37.5 links.

H1) Quarter corner common to Section 3 T49NR9W and Section 34 T50NR9W. Corner re-monumented by Marcus Schaaf RLS, and perpetuated by Billy D. Buckler RLS in 1962: 2" iron pipe buried in the center of E-W fire line. 8" Jack Pine S50W 28 links, 8" Jack Pine North 20 links.

B. Description of corner evidence found and/or method applied in restoring or reestablishing corner:

G1) Recovered the 2" iron pipe in good condition and at record bearing and distance from the remains of the 1958 witness trees. The Jack pine S35E is standing but dead. The other two NBTs are cut stumps. Left the monument in place and made new witnesses as described below.

H1) Recovered a 2" ID iron pipe at record bearing and distance from the 1962 NBTs. The Jack pine SW is in good condition. The Jack pine North is a cut stump. Left the monument in place and made new witnesses as described below.

C. Description of monument for corner and accessories established to perpetuate locating the position of the corner:

G1) Found 2" iron pipe. Blazed, scribed, and set measuring nails in:  
 2" R. Pine S80W 60.2' "S4 NBT"  
 2" R. Pine S10W 86.3' do  
 " R. Pine N62W 55.8' "S33 NBT"  
 " R. Pine N25W 68.2' do  
 Bearings are magnetic. Distances are to nails with tags.

H1) Found 2" ID iron pipe. Blazed, scribed, and set measuring nails in:  
 10" J. Pine S55W 18.7' (the 1962 NBT)  
 5" J. Pine S25E 18.9' "1/4S NBT"  
 10" J. Pine N30E 21.8' do  
 8" J. Pine N65E 35.6' do  
 Bearings are magnetic. Distances are to nail with tag.

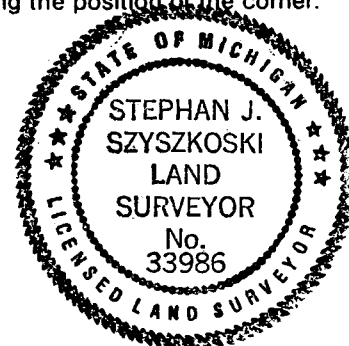

Signed by Stephan J. Szyszkoski Date 7/25/01  
 Surveyor's Michigan License No. 33986