

LAND CORNER RECORDATION CERTIFICATE
Filing Requirement of Act 74, Mich. P.A. 1970

For corners in _____

Luce

(County)

Located In:

Corner Code #

1. Public Land Survey

T 49N R 9W D11
 T _____ R _____
 T _____ R _____
 T _____ R _____

2. Property Controlling in Section

S _____ T _____ R _____
 S _____ T _____ R _____

3. Miscellaneous Property in Sec.

S _____ T _____ R _____
 S _____ T _____ R _____

Register of Deeds Stamp & File Number

4. Lot No. _____, Recorded Plat _____

5. Private Claims _____

May 14 2002

I, Stephan J. Szyszkoski, in a field survey on _____, 20__ do hereby state that under requirements of P.A. 74, Michigan P.A. of 1970, the corner points mentioned in lines 1 and 2 above were in conformance with regulations and rules therefore as required in the current manual of survey instructions of the United States Department of the Interior, Bureau of Land Management or by a decree of a Court of Law and /or that the corner points mentioned in lines 3, 4 and 5 above were in conformance with the rules of the Michigan Board of Land Surveyors or by a Decree of a Court of Law; established, re-established, monumented, recovered, found as expressed below:

NOTE: Not more than 2 corners, all in the same town and range, may be recorded on this certificate.

	A	B	C	D	E	F	G	H	I	J	K	L	M
1													
2	6		5		4		3		2		1		
3													
4	7		8		9		10		11		12		
5													
6	19		17		16		15		14		13		
7													
8	19		20		21		22		23		24		
9													
10	30		29		28		27		26		25		
11													
12	31		32		33		34		35		36		
13													

A. Description of original monument and accessories and/or subsequent restoration:
 (D11) Quarter corner common to Sections 29-32. 1850: Established by Harvey Mellen: "Corrected between Sections 29 & 32...40.22 set qr Section post. Maple 7 N34W 15, W.Pine 12 S40E 34." 1970: Remonumented 9/8/1970 by Billy D. Buckler RLS: "This corner replaced from one possible B.T.; a down W.Pine in poor condition, bearing S40E 34 links. Found no identifying marks but this is the only W.Pine near. Distance checks to cor. 1/2 mile east. Corner lies 30' north of road. Set 1" pipe with 4" aluminum cap. Witnesses to corner: 26" Red Pine (1/4S N8T) S25E 53.1', 20" Red Pine (1/4S N8T) W 5.3'."

B. Description of corner evidence found and/or method applied in restoring or reestablishing corner:

(D11) Found the 1970 monument, a 1" ID iron pipe with 4" aluminum State of Michigan tablet, in good condition and at record bearing and distance from the remaining 1970 witness Red Pine SE, in good condition. The N8T Red Pine to the West has been cut. The original B.T. W.Pine noted in Buckler's record was not recovered. Left the monument in place and made new accessories as described below. Distances to monumented Section corners are 2648.19' to C11 (reestablished from local evidence) and 2661.99' to E11 (a remonumented original corner).

C. Description of monument for corner and accessories established to perpetuate locating the position of the corner:

(D11) Fd. 1" ID I.pipe with 4" dia. aluminum State of MI cap. Blazed, scribed, and set measuring nails in:
 * 34" R.Pine S26E 54.05' "1/4S"
 8" Maple in clump S30E 19.3' "1/4S N8T"
 10" J. Pine S39E 14.05' do
 6" Spruce S76W 11.7' do
 Placed cedar post adjacent. Bearings are magnetic. Distances are to nail with tag. * denotes 1970 N8T.

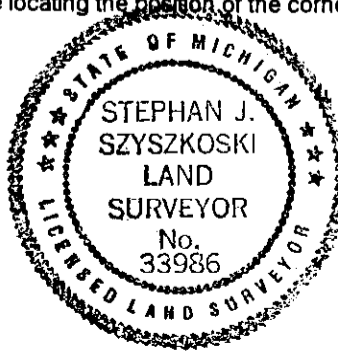

Signed by Stephan J. Szyszkoski
 Surveyor's Michigan License No. 33986

Date 8/19/02