

LAND CORNER RECORDATION CERTIFICATE
Filing Requirement of Act 74, Mich. P.A. 1970

For corners in

<u>Luce</u> (County)	Located In:	Corner Code #	
1. Public Land Survey	T <u>49N</u> R <u>9W</u>	<u>C12</u>	
	T <u> </u> R <u> </u>	<u> </u>	
	T <u> </u> R <u> </u>	<u> </u>	
	T <u> </u> R <u> </u>	<u> </u>	
2. Property Controlling in Section	S <u> </u> T <u> </u> R <u> </u>	<u> </u>	
	S <u> </u> T <u> </u> R <u> </u>	<u> </u>	
3. Miscellaneous Property in Sec.	S <u> </u> T <u> </u> R <u> </u>	<u> </u>	
	S <u> </u> T <u> </u> R <u> </u>	<u> </u>	

Register of Deeds Stamp & File Number

4. Lot No. _____, Recorded Plat _____
 5. Private Claims _____

May 13 2002

I, Stephan J. Szyszkoski, in a field survey on _____, 20____ do hereby state that under requirements of P.A. 74, Michigan P.A. of 1970, the corner points mentioned in lines 1 and 2 above were in conformance with regulations and rules therefore as required in the current manual of survey instructions of the United States Department of the Interior, Bureau of Land Management or by a decree of a Court of Law and /or that the corner points mentioned in lines 3, 4 and 5 above were in conformance with the rules of the Michigan Board of Land Surveyors or by a Decree of a Court of Law; established, re-established, monumented, recovered, found as expressed below:

NOTE: Not more than 2 corners, all in the same town and range, may be recorded on this certificate.

A	B	C	D	E	F	G	H	I	J	K	L	M
1												
2	6	5	4	3	2	1						
3												
4	7	8	9	10	11	12						
5												
6	10	17	16	15	14	13						
7												
8	19	20	21	22	23	24						
9												
10	30	29	28	27	26	25						
11												
12	31	32	33	34	35	36						
13												

A. Description of original monument and accessories and/or subsequent restoration:

(C12) Quarter corner common to Sections 31-32. 1850: Established by Harvey Mellen, D.S.: "N13'E corrected between Sections 31 & 32...39.995 Set qr Section post. Beech 12 N79W 15, Beech 6 S29E 8...79.97 Set post at corner of Sections 29,30,31,32". Found no subsequent record.

B. Description of corner evidence found and/or method applied in restoring or reestablishing corner:

(C12) The original post and accessories were not recovered. Found no acceptable evidence of the position of the original corner on the ground. Reestablished the corner midway and on a line of mean true bearing between Section corners 2629.32' north (previously remonumented from local evidence) and south (probably an original corner, remonumented, according to its 1970 record). The true bearing of the section line is N12°16'W, computed from GPS observations made at the corners.

C. Description of monument for corner and accessories established to perpetuate locating the position of the corner:

(C12) Set 1"IDx36" I.pipe with 4" alum. MDNR cap. Blazed, scribed, and set measuring nails in:
 10" Balsam N48W 7.15' "1/4S NBT"
 10" Maple S74W 7.0' do
 20" Hemlock S52E 49.8' do
 18" Maple N27E 34.4' do
 Set cedar post adjacent. Bearings are magnetic. Distances are to nail with tag.

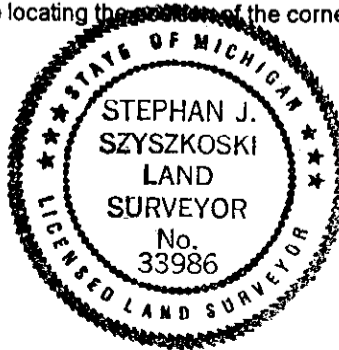

Signed by Stephan J. Szyszkoski
 Surveyor's Michigan License No. 33986

Date 8/19/02