

**LAND CORNER RECORDATION CERTIFICATE**  
**Filing Requirement of Act 74, Mich. P.A. 1970**

For corners in

Luce  
 \_\_\_\_\_  
 (County)

Located In:

Corner Code #

- |                                    |                          |            |
|------------------------------------|--------------------------|------------|
| 1. Public Land Survey              | T <u>49N</u> R <u>9W</u> | <u>C10</u> |
|                                    | T _____ R _____          | _____      |
|                                    | T _____ R _____          | _____      |
|                                    | T _____ R _____          | _____      |
| 2. Property Controlling in Section | S _____ T _____ R _____  | _____      |
|                                    | S _____ T _____ R _____  | _____      |
| 3. Miscellaneous Property in Sec.  | S _____ T _____ R _____  | _____      |
|                                    | S _____ T _____ R _____  | _____      |

Register of Deeds Stamp & File Number

4. Lot No. \_\_\_\_\_, Recorded Plat \_\_\_\_\_  
 5. Private Claims \_\_\_\_\_

Nov 25 2001

I, Stephan J. Szyszkoski, in a field survey on \_\_\_\_\_, 20\_\_\_\_ do hereby state that under requirements of P.A. 74, Michigan P.A. of 1970, the corner points mentioned in lines 1 and 2 above were in conformance with regulations and rules therefore as required in the current manual of survey instructions of the United States Department of the Interior, Bureau of Land Management or by a decree of a Court of Law and /or that the corner points mentioned in lines 3, 4 and 5 above were in conformance with the rules of the Michigan Board of Land Surveyors or by a Decree of a Court of Law, established, re-established, monumented, recovered, found as expressed below:

NOTE: Not more than 2 corners, all in the same town and range, may be recorded on this certificate.

1	A	B	C	D	E	F	G	H	I	J	K	L	M
2		6		5		4		3		2		1	
3													
4		7		8		9		10		11		12	
5													
6		10		17		16		15		14		13	
7													
8		19		20		21		22		23		24	
9													
10		30		29		28		27		26		25	
11													
12		31		32		33		34		35		36	
13													

**A. Description of original monument and accessories and/or subsequent restoration:**

(C10) Quarter corner common to Sections 29 & 30. 1952: Remonumented by Dean C. DeLaMater RLS. One original B.T. still in place, good condition. 1" pipe with 4" brass cap. 12" Cedar S42E 48 links, 6" S.Maple N44W 47 links. 1850: Corner established by Harvey Mellen: N13'E between 29 & 30...39.955 set qr. Section post. Y. Birch 12 S50E 6, Cedar 12 N75W 13...79.91 Set post corner of Sections 19-20-29-30..

**B. Description of corner evidence found and/or method applied in restoring or reestablishing corner:**

(C10) Recovered the 1952 monument in good condition and at record bearing and distance from the 1952 NBTs. The Maple is in good condition, the Cedar a 2' high stump with lower face visible. Recovered the OBT Cedar, N73W, now 22" DBH, in good condition, at record bearing and distance. Measured to adjacent section corners S 23'14" N, 2656.33' and N 00'41"W, 2652.48' (true brgs).

**C. Description of monument for corner and accessories established to perpetuate locating the position of the corner:**

(C10) Fd. 1" ID I.pipe with 4" brass MI Dept. of Conservation tablet. Blazed, scribed, and set measuring nails in:  
 \* 10" Maple N39W 31.0' "1/4S"  
 14" Hemlock S46E 29.1' "1/4S NBT"  
 12" Hemlock S86E 39.4' do  
 10" Y.Birch N30E 26.8' do  
 Bearings are magnetic. Distances are to nail with tag. \* denotes 1952 NBT.

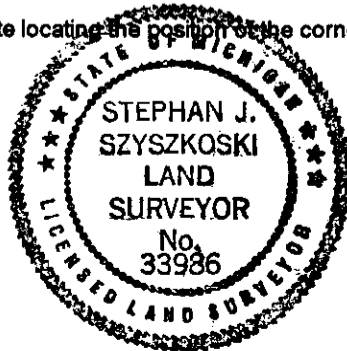

Signed by Stephan J. Szyszkoski  
 Surveyor's Michigan License No. 33986

Date 8/15/02