

MAR 17 2000

FILED

SECTION

LAND CORNER RECORDATION CERTIFICATE  
Filing Requirement of Act 74, Mich. P.A. 1970

For corners in

|                                       |                   |               |
|---------------------------------------|-------------------|---------------|
| <u>LIVINGSTON</u><br>(County)         | Located In:       | Corner Code # |
| 1. Public Land Survey                 | <u>T1N R4E</u>    | <u>1-06</u>   |
|                                       | T ___ R ___       | _____         |
|                                       | T ___ R ___       | _____         |
|                                       | T ___ R ___       | _____         |
| 2. Property Controlling<br>in Section | S ___ T ___ R ___ | _____         |
|                                       | S ___ T ___ R ___ | _____         |
| 3. Miscellaneous<br>Property in Sec.  | S ___ T ___ R ___ | _____         |
|                                       | S ___ T ___ R ___ | _____         |
| 4. Lot No. _____, Recorded Plat _____ |                   |               |
| 5. Private Claims _____               |                   |               |

1999 JUN -4 P 12:55

NANCY HAVILAND  
REGISTER OF DEEDS  
LIVINGSTON COUNTY, MI.  
48843

L.S.C #1024m

Register of Deeds Stamp & File Number

I, JACK K SMITH, in a field survey on MARCH 22, 1999 do hereby state that under requirements of P.A. 74, Michigan P.A. of 1970, the corner points mentioned in lines 1 and 2 above were in conformance with regulations and rules therefore as required in the current manual of survey instructions of the United States Department of the Interior, Bureau of Land Management or by a decree of a Court of Law and/or that the corner points mentioned in lines 3, 4 and 5 above were in conformance with the rules of the Michigan Board of Land Surveyors or by a Decree of a Court of Law, established, re-established, monumented, recovered, found as expressed below:

|    |    |   |    |   |    |   |    |   |    |   |    |   |   |
|----|----|---|----|---|----|---|----|---|----|---|----|---|---|
|    | A  | B | C  | D | E  | F | G  | H | I  | J | K  | L | I |
| 1  |    |   |    |   |    |   |    |   |    |   |    |   |   |
| 2  | 6  |   | 5  |   | 4  |   | 3  |   | 2  |   | 1  |   |   |
| 3  |    |   |    |   |    |   |    |   |    |   |    |   |   |
| 4  | 7  |   | 6  |   | 9  |   | 10 |   | 11 |   | 12 |   |   |
| 5  |    |   |    |   |    |   |    |   |    |   |    |   |   |
| 6  | 18 |   | 17 |   | 16 |   | 15 |   | 14 |   | 13 |   |   |
| 7  |    |   |    |   |    |   |    |   |    |   |    |   |   |
| 8  | 19 |   | 20 |   | 21 |   | 22 |   | 23 |   | 24 |   |   |
| 9  |    |   |    |   |    |   |    |   |    |   |    |   |   |
| 10 | 30 |   | 29 |   | 28 |   | 27 |   | 26 |   | 25 |   |   |
| 11 |    |   |    |   |    |   |    |   |    |   |    |   |   |
| 12 | 31 |   | 32 |   | 33 |   | 34 |   | 35 |   | 36 |   |   |
| 13 |    |   |    |   |    |   |    |   |    |   |    |   |   |

NOTE: Not more than 2 corners, all in the same town and range, may be recorded on this certificate.

A. Description of original monument and accessories and/or subsequent restoration:

GLO 1825 SIBLEY SET POST  
B. OAK 18 S 41 W 15 (9.9)  
W. OAK 12 N 05 W 72 (47.5')

B. Description of corner evidence found and/or method applied in restoring or reestablishing corner:

FOUND A 1" PIPE WITH BENTON CAP INTERSECTION OF FENCE LINES SOUTH AND EAST. COULD NOT FIND RECORD OF THE BENTON SURVEY BUT THIS POSITION IS THE ONLY ONE THAT APPEARS TO HAVE BEEN USED.

C. Description of monument for corner and accessories established to perpetuate locating the position of the corner:

I-06 WEST 1/4 CORNER SECTION 13, EAST 1/4 CORNER SECTION 14, T1N, R4E, PUTNAM TOWNSHIP, LIVINGSTON COUNTY, MICHIGAN:  
RESET FOUND 1" PIPE WITH 1 1/4" X 36" STEEL PIPE WITH LIVINGSTON COUNTY REMONUMENTATION BRASS CAP WITH SURVEYOR #35999 @ 1/2 FOOT ABOVE THE SURFACE OF SURROUNDING GROUND 190 FEET SOUTHERLY OF THE CENTER LINE OF A PRIVATE ACCESS ROAD (GRAVEL) AT THE INTERSECTION OF FENCES SOUTH AND EAST.

S45°E NAIL WITH LIVINGSTON COUNTY REMON TAG IN NORTH SIDE 30" OAK  
SOUTH NAIL WITH LIVINGSTON COUNTY REMON TAG IN WEST SIDE 30" OAK  
N45°W NAIL WITH LIVINGSTON COUNTY REMON TAG IN SOUTH SIDE 8" OAK  
NORTH NAIL WITH LIVINGSTON COUNTY REMON TAG IN EAST SIDE 14" OAK

27.53'  
42.21'  
7.78'  
32.26'

Signed by [Signature]

Date 3-26-1999

Surveyor's Michigan License No. 35999

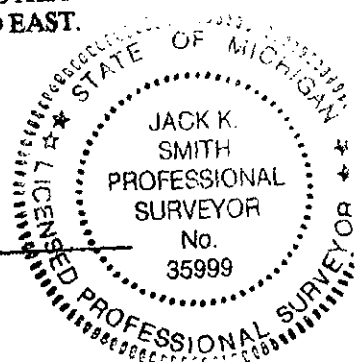

FORM APPROVED BY MICHIGAN STATE BOARD OF PROFESSIONAL SURVEYORS, JAN. 2  
REVISED MAY 14, 1978  
REVISED JAN, 1980  
REVISED OCT, 1995

PA. 345 1990, APPROVED BY LIVINGSTON COUNTY  
PEER GROUP ON 3-3-1999 CO. REP JED