

SURVEY & REMONUMENTATION

FEB 25 1999

SECTION

LAND CORNER RECORDATION CERTIFICATE
Filing Requirement of Act 74, Mich. P.A. 1970

For corners in

<u>LIVINGSTON</u> (County)	Located in:	Corner Code #
1. Public Land Survey	<u>TIN R4E</u> #14 R5E	<u>J-07</u>
	T <u> </u> R <u> </u>	<u> </u>
	T <u> </u> R <u> </u>	<u> </u>
	T <u> </u> R <u> </u>	<u> </u>
2. Property Controlling in Section	§ <u> </u> T <u> </u> R <u> </u>	<u> </u>
	§ <u> </u> T <u> </u> R <u> </u>	<u> </u>
3. Miscellaneous Property in Sec.	§ <u> </u> T <u> </u> R <u> </u>	<u> </u>
	§ <u> </u> T <u> </u> R <u> </u>	<u> </u>

1998 OCT 14 P 2:11

NANCY HAVILAND
REGISTER OF DEEDS
LIVINGSTON COUNTY, MI.
48843

LSC 906M

Register of Deeds Stamp & File Number

4. Lot No. _____, Recorded Plat _____
5. Private Claims _____

I, JACK K. SMITH, in a field survey on SEPTEMBER 17, 1998, do hereby state that, under requirements of D.A. 74, Michigan D.A. of 1970, the corner points mentioned in lines 1 and 2 above were in conformance with regulations and rules therefore as required in the current manual of survey instructions of the United States Department of the Interior, Bureau of Land Management or by a decree of a Court of Law and /or that the corner points mentioned in lines 3, 4 and 5 above were in conformance with the rules of the Michigan Board of Land Surveyors or by a Decree of a Court of Law; established, re-established, monumented, recovered, found as expressed below:

NOTE: Not more than 2 corners, all in the same town and range, may be recorded on this certificate.

	A	B	C	D	E	F	G	H	I	J	K	L	M
1													
2	6		5		4		3		2		1		
3													
4	7		8		9		10		11		12		
5													
6	18		17		16		15		14		13		
7													
8	19		20		21		22		23		24		
9													
10	30		29		28		27		26		25		
11													
12	31		32		33		34		35		36		
13													

A. Description of original monument and accessories and/or subsequent restoration:

GLO 1815 WAMPLER SET POST
BLACK OAK 15 S74W 103 (68')
WHITE OAK 12 N2 1/2W 158 (104.3')

B. Description of corner evidence found and/or method applied in restoring or reestablishing corner:

FOUND A 1/2" PINCH PIPE ON THE EAST SIDE OF A WOODEN FENCE CORNER POST. THIS CORNER POSITION AGREES WELL WITH WITNESSES OF RECORD SINCE 1963.

C. Description of monument for corner and accessories established to perpetuate locating the position of the corner:

J-07 SOUTH 1/4 CORNER SECTION 14 / NORTH 1/4 CORNER SECTION 23, TIN, R4E, PUTNAM TOWNSHIP, LIVINGSTON COUNTY, MICHIGAN:
RESET FOUND 1/2" PINCH PIPE WITH 1 1/4" X 36" STEEL PIPE WITH LIVINGSTON COUNTY REMONUMENTATION BRASS CAP WITH SURVEYOR #35999 @ 1/4 FOOT ABOVE THE SURFACE OF SURROUNDING GROUND IN STONES.

N62°E NAIL WITH LIVINGSTON COUNTY REMON TAG IN WEST SIDE 10" PINE 46.60'
N25°E NAIL WITH LIVINGSTON COUNTY REMON TAG IN EAST SIDE 5" OAK 28.20'
S15°E NAIL WITH LIVINGSTON COUNTY REMON TAG IN EAST SIDE 5" CHERRY 17.19'
N55°W NAIL WITH LIVINGSTON COUNTY REMON TAG IN SOUTH SIDE 6" OAK 12.37'

Signed by [Signature]

Date 9-25-1998

Surveyor's Michigan license No. 35999

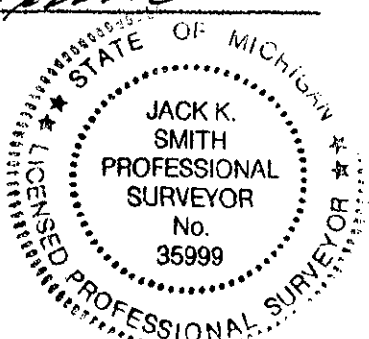

FORM APPROVED BY MICHIGAN STATE BOARD OF PROFESSIONAL SURVEYORS, J.
REVISED MAY 14, 1978 REVISED JAN., 1983 REVISED OCT., 1985

PA. 345 1990, APPROVED BY LIVINGSTON COUNTY
PEER GROUP ON 9-16-98 CO. REP JED