

MAR 17 2000

SECTION

LAND CORNER RECORDATION CERTIFICATE
Filing Requirement of Act 74, Mich. P.A. 1970

FILED

For corners in

<u>LIVINGSTON</u> (County)	Located In:	Corner Code #
1. Public Land Survey	T <u>1</u> N <u>R</u> 4 E	<u>L-03</u>
	T <u> </u> R <u> </u>	<u> </u>
	T <u> </u> R <u> </u>	<u> </u>
	T <u> </u> R <u> </u>	<u> </u>
2. Property Controlling in Section	S <u> </u> T <u> </u> R <u> </u>	<u> </u>
	S <u> </u> T <u> </u> R <u> </u>	<u> </u>
3. Miscellaneous Property in Sec.	S <u> </u> T <u> </u> R <u> </u>	<u> </u>
	S <u> </u> T <u> </u> R <u> </u>	<u> </u>

1999 JUN -4 P 12:56

NANCY HAVILAND
REGISTER OF DEEDS
LIVINGSTON COUNTY, MI.
48843

L.S.C. #1031m

Register of Deeds Stamp & File Number

4. Lot No. _____, Recorded Plat _____
5. Private Claims _____

I, JACK K SMITH, in a field survey on MARCH 22, 1999 do hereby state that under requirements of P.A. 74, Michigan P.A. of 1970, the corner points mentioned in lines 1 and 2 above were in conformance with regulations and rules therefore as required in the current manual of survey instructions of the United States Department of the Interior, Bureau of Land Management or by a decree of a Court of Law and/or that the corner points mentioned in lines 3, 4 and 5 above were in conformance with the rules of the Michigan Board of Land Surveyors or by a Decree of a Court of Law; established, re-established, monumented, recovered, found as expressed below:

NOTE: Not more than 2 corners, all in the same town and range, may be recorded on this certificate.

A	B	C	D	E	F	G	H	I	J	K	L	1
1												
2	6		5		4		3		2		1	
3												
4	7		9		9		10		11		12	
5												
6	19		17		16		15		14		13	
7												
8	19		20		21		22		23		24	
9												
10	30		29		28		27		26		25	
11												
12	31		32		33		34		35		36	
13												

A. Description of original monument and accessories and/or subsequent restoration:

GLO 1825 SIBLEY SET POST
TAM 12 N 14 1/2 E 2 (1.3')
TAM 12 S 83 W 7 (4.6')

B. Description of corner evidence found and/or method applied in restoring or reestablishing corner:

FOUND A 1/2" REROD APPARENTLY SET BY RON LESTER IN NORTH-SOUTH FENCE AND 9 FEET NORTH OF A FENCE LINE TO THE EAST. THIS POSITION AGREES WELL WITH WITNESSES OF RECORD SINCE 1972.

C. Description of monument for corner and accessories established to perpetuate locating the position of the corner:

L-03 SOUTH 1/4 CORNER SECTION 1, NORTH 1/4 CORNER SECTION 12, T1N, R4E, PUTNAM TOWNSHIP, LIVINGSTON COUNTY, MICHIGAN:
RESET FOUND 1/2" REROD WITH 1 1/4" X 36" STEEL PIPE WITH LIVINGSTON COUNTY REMONUMENTATION BRASS CAP WITH SURVEYOR #35999 @ 1/2 FOOT ABOVE THE SURFACE OF SURROUNDING GROUND.

N45°E 1" STEEL PIPE WITH LIVINGSTON COUNTY REMON WITNESS CAP
SOUTH NAIL WITH LIVINGSTON COUNTY REMON TAG IN WEST SIDE FENCE POST
S70°W NAIL WITH LIVINGSTON COUNTY REMON TAG IN NORTH SIDE 6" POPLAR
N05°W NAIL WITH LIVINGSTON COUNTY REMON TAG IN WEST SIDE 12" CEDAR

23.10'
8.95'
10.90'
71.41'

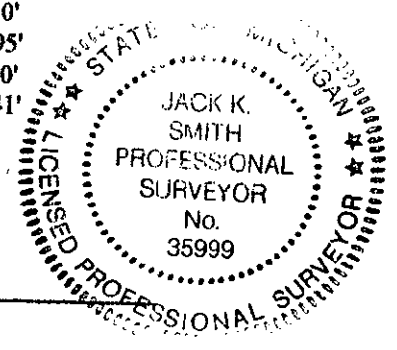

NOTE: THE SWAMP TO THE EAST HAS ABUNDANT POISON SUMAC!

Signed by [Signature]

Date 3-26-1999

Surveyor's Michigan License No. 35999

P.A. 345 1990, APPROVED BY LIVINGSTON COUNTY
PEER GROUP ON 3-3-99, CO. REP JED