

MAR 17 2000

FILED

SECTION

LAND CORNER RECORDATION CERTIFICATE
Filing Requirement of Act 74, Mich. P.A. 1970

1999 NOV 22 A 11:08

For corners in
LIVINGSTON
(County)

Located in: HAMBURG Corner Code #

9

NANCY HAVILAND
REGISTER OF DEEDS
LIVINGSTON COUNTY, MI.
48843

1. Public Land Survey	T	1N	R	5E	D-9
	T		R		
	T		R		
	T		R		
2. Property Controlling in Section	S		T	R	
	S		T	R	
3. Miscellaneous Property in Sec.	S		T	R	
	S		T	R	

LSC# 1115m

Register of Deeds Stamp and File Number

- 4. Lot No. _____, Recorded Plat _____
- 5. Private Claims _____

I, Bryan L. Boss, In a field survey on NOVEMBER 3, 1999, do hereby certify that under requirements of P.A. 74, Michigan P.A. of 1970, the corner points mentioned in lines 1 and 2 above were in conformance with regulations and rules therefor as required in the current manual of survey instructions of the United States Department of the Interior, Bureau of Land Management or by a decree of a Court of Law and/or that the corner points mentioned in lines 3,4 and 5 above were in conformance with the rules of the Michigan Board of Land Surveyors or by a Decree of a Court of Law; established, re-established, monumented, re-monumented, recovered, found as expressed below.

NOTE: Not more than 4 corners, all in the same town and range, may be recorded on this certificate.

A	B	C	D	E	F	G	H	I	J	K	L	M
2	6	5	4	3	2	1						
3												
4	7	8	9	10	11	12						
5												
6	18	17	16	15	14	13						
7												
8	19	20	21	22	23	24						
9												
10	30	29	28	27	26	25						
11												
12	31	32	33	34	35	36						
13												

A. Description of original monument and accessories and/or subsequent restoration:
SET 1/4 SECTION POST AT AVERAGE DISTANCE
12" B. OAK S58°W 1.12

B. Description of corner evidence found and/or method applied in restoring or reestablishing corner:
FOUND 3/4" PIPE WITH 1" HEX HEAD +/- 1' ABOVE GROUND

C. Description of monument for corner and accessories established to perpetuate locating the position of the corner:
SET 1 1/4"X36" PIPE WITH BRASS CAP STAMPED
"LIVINGSTON COUNTY REMONUMENTATION
CORNER" ALONG WITH A CARSONITE MARKER
DUE NORTH 60.34' SET REMON NAIL & TAG
E/SIDE 6" QUAILING ASPEN
N45°E 22.29' SET REMON NAIL & TAG S/SIDE 4" &
10" POPLAR
S65°W 52.30' SET REMON NAIL & TAG N/SIDE 13"
OAK
S45°W 39.95' SET REMON NAIL & TAG N/SIDE 6"
OAK

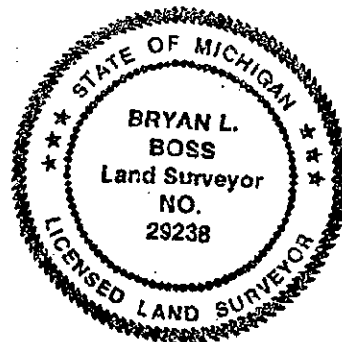

P.A. 345 1990, APPROVED BY LIVINGSTON COUNTY
PEER GROUP ON 7-21-99 CO. REP JEO

Signed by Bryan L. Boss
Surveyor's Michigan License No. 29238

Date NOV. 10, 1999