

**SURVEY & REMONUMENTATION**

**FILED**

APR 28 1995

Nov 16 2 07 PM '94

**LAND CORNER RECORDATION CERTIFICATE**  
Filing Requirement of Act 74, Mich. P.A. 1970

For corners in **COMMISSION**  
Livingston  
(County)

NANCY HAVILAND  
REGISTER OF DEEDS  
LIVINGSTON COUNTY, MI  
48843

	Located In:	Corner Code #
1. Public Land Survey	T <u>1N</u> R <u>5E</u>	<u>D-13</u>
	T _____ R _____	_____
	T _____ R _____	_____
	T _____ R _____	_____
2. Property Controlling In Section	S _____ T _____ R _____	_____
	S _____ T _____ R _____	_____
3. Miscellaneous Property in Sec.	S _____ T _____ R _____	_____
	S _____ T _____ R _____	_____

L.S.C. #375m  
Register of Deeds Stamp & File Number

4. Lot No. \_\_\_\_\_, Recorded Plat \_\_\_\_\_  
5. Private Claims \_\_\_\_\_

	A	B	C	D	E	F	G	H	I	J	K	L	M
2	6	5	4	3	2	1							
3													
4	7	8	9	10	11	12							
5													
6	10	17	16	15	14	13							
7													
8	19	20	21	22	23	24							
9													
10	30	29	28	27	26	25							
11													
12	31	32	33	34	35	36							
13													

I, Bryan Boss, in a field survey on 11-3, 1994, do hereby certify that under requirements of P.A. 74, Michigan P.A. of 1970, the corner points mentioned in lines 1 and 2 above were in conformance with regulations and rules therefore as required in the current manual of survey instructions of the United States Department of the Interior, Bureau of Land Management or by a decree of a Court of Law and/or that the corner points mentioned in lines 3, 4 and 5 above were in conformance with the rules of the Michigan Board of Land Surveyors or by a Decree of a Court of Law; established, re-established, monumented, re-monumented, recovered, found as expressed below:

NOTE: Not more than 4 corners, all in the same town and range, may be recorded on this certificate.

A. Description of original monument and accessories and/or subsequent restoration:

- White Oak 5" N 84 W 10 Links
- White Oak 6" N 47 E 29 Links

Additional data on back.

B. Description of corner evidence found and/or method applied in restoring or reestablishing corner:

Found capped pipe, Atwell-Hicks, encased into a 2" pipe. No occupation. Also found witnesses by others.

C. Description of monument for corner and accessories established to perpetuate locating the position of the corner:

Set 1 1/4" x 36" iron pipe with brass cap marked Livingston County Monument Corner.

- N75°W 8.87' N&T NE/S 40"Oak
- N30°W 36.80' N&T E/S 14"Oak
- East 23.15' N&T N/S Twin 15" Basswood
- South 59.47' N&T N/S 8" Pine

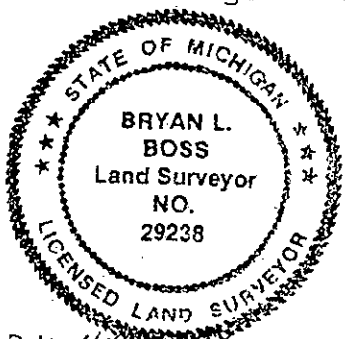

Signed by [Signature] Date 11/16/94  
Surveyor's Michigan License No. 29238

TIN-R5E  
D-13  
Page 1

SUMMARY  
D-13

SOUTH 1/4 CORNER, SECTION 32, T1N-R5E HAMBURG TOWNSHIP, LIVINGSTON COUNTY, MICHIGAN.

Found Atwell-Hicks capped pipe encased into a 2" pipe. No occupation, but found evidence of a recent survey westerly.

Baseline originally surveyed by Edward Tiffin in 1815. Followed by survey in 1823 by Joseph Wampler.

On 9-27-61, Atwell-Hicks survey (page 10) calls for 64.2' jog on baseline between South 1/4 Corner, Section 32, Hamburg Township and the North 1/4 Corner of Section 5, Webster Township. Again on May 2, 1972 Atwell-Hicks survey (page 12) calls for 64.20 feet jog between corners. Measured to witnesses found. Found 4 of 6 Atwell-Hicks witnesses (page 12 of this Dossier). 40" W. Oak government witness 10 links (6.6 feet); now measured 7.3 feet. 8" red oak (now 14"), measured the same. 10" twin bass wood (now 15") measured 0.20 feet long. 64.20 jog measured 64.0± feet to an Atwell-Hicks capped pipe.

Conclusion: We find the North 1/4 corner of Section 5, Webster Township is on a line Northerly from the centerline of Mast Road extended, and that Washtenaw Engineering witnesses (page 15) place this corner at same location. Jog Westerly to South 1/4 corner of Section 32, Hamburg Township, and witnesses by others find the capped Atwell-Hicks pipe to be the correct location of D-13. We recommend accepting this point as D-13.

HSUMD

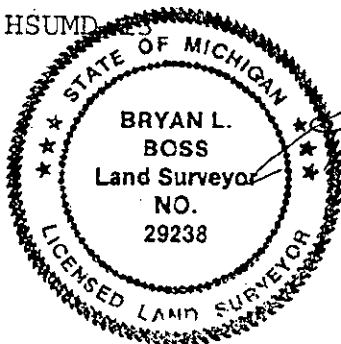

*Bryan L. Boss*