

MAR 17 2000

FILED

SECTION

LAND CORNER RECORDATION CERTIFICATE  
Filing Requirement of Act 74, Mich. P.A. 1970

1999 NOV 22 A 11:09

For corners in  
LIVINGSTON  
(County)

Located in: HAMBURG Corner Code # 9

NANCY HAVILAND  
REGISTER OF DEEDS  
LIVINGSTON COUNTY, MI.  
48843

- 1. Public Land Survey T 1N R 5E G-8  
T \_\_\_\_\_ R \_\_\_\_\_  
T \_\_\_\_\_ R \_\_\_\_\_  
T \_\_\_\_\_ R \_\_\_\_\_
- 2. Property Controlling S \_\_\_\_\_ T \_\_\_\_\_ R \_\_\_\_\_  
in Section S \_\_\_\_\_ T \_\_\_\_\_ R \_\_\_\_\_
- 3. Miscellaneous S \_\_\_\_\_ T \_\_\_\_\_ R \_\_\_\_\_  
Property in Sec. S \_\_\_\_\_ T \_\_\_\_\_ R \_\_\_\_\_
- 4. Lot No. \_\_\_\_\_, Recorded Plat \_\_\_\_\_
- 5. Private Claims \_\_\_\_\_

LSC# 1122m  
Register of Deeds Stamp and File Number

I, Bryan L. Boss, in a field survey on 11-02-99  
do hereby certify that under requirements of P.A. 74, Michigan P.A. of 1970, the corner points mentioned  
in lines 1 and 2 above were in conformance with regulations and rules therefor as required in the  
current manual of survey instructions of the United States Department of the Interior, Bureau of Land  
Management or by a decree of a Court of Law and/or that the corner points mentioned in lines 3, 4 and 5  
above were in conformance with the rules of the Michigan Board of Land Surveyors or by a Decree of a  
Court of Law; established, re-established, monumented, re-monumented, recovered, found as  
expressed below.

	A	B	C	D	E	F	G	H	I	J	K	L	M
2	6	5	4	3	2	1							
3													
4	7	8	9	10	11	12							
5													
6	18	17	16	15	14	13							
7													
8	19	20	21	22	23	24							
9													
10	30	29	28	27	26	25							
11													
12	31	32	33	34	35	36							
13													

NOTE: Not more than 4 corners, all in the same town and range, may be recorded on this certificate.

A. Description of original monument and accessories and/or subsequent restoration:

SET 1/2 MILE POST  
NO WITNESS TIES GIVEN

B. Description of corner evidence found and/or method applied in restoring or reestablishing corner:

FOUND 3/4" IRON PIPE WITH SMASHED CAP BENEATH 4"  
CONCRETE IN DRIVEWAY

C. Description of monument for corner and accessories established to perpetuate locating the position of the corner:

SET BRASS CAP STAMPED "LIVINGSTON COUNTY  
REMONUMENTATION CORNER" IN HOLE DRILLED  
IN CONCRETE DRIVEWAY DIRECTLY ABOVE  
FOUND 3/4" PIPE. BRASS CAP WAS SECURED IN  
PLACED WITH CONCRETE N 40°E 6.40' FOUND 3/4" PIPE IN ASPHALT  
S50°E 16.30' SET REMON NAIL & TAG W/S TWIN  
MAPLE  
N10°E 53.30' SW CORNER OF BUILDING  
N45°E 73.77' SET NAIL & TAG S/S POWER POLE  
S30°E 51.85' NW CORNER 2 STORY HOUSE

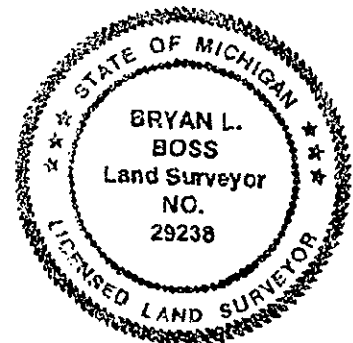

P.A. 345 1990, APPROVED BY LIVINGSTON COUNTY

RECORDED 9-1-99 CO REP JED

Signed by Bryan L. Boss  
Surveyor's Michigan License No. 29238

Date NOV. 9, 1999