

SURVEY & REMONUMENTATION

FILED

Nov 16 2 07 PM '94

APR 28 1995 LAND CORNER RECORDATION CERTIFICATE

NANCY HAVILANG
REGISTER OF DEEDS
LIVINGSTON COUNTY, MI
48843

For corners in Livingston **COMMISSION**
(County) Located In: Corner Code H-13

- 1. Public Land Survey T 1N R 5E H-13
T _____ R _____
T _____ R _____
T _____ R _____
- 2. Property Controlling S _____ T _____ R _____
In Section S _____ T _____ R _____
- 3. Miscellaneous S _____ T _____ R _____
Property in Sec. S _____ T _____ R _____

L.S.C. #384m

Register of Deeds Stamp & File Number

- 4. Lot No. _____, Recorded Plat _____
- 5. Private Claims _____

I, Bryan Boss, in a field survey on 11-3-1994, do hereby certify that under requirements of P.A. 74, Michigan P.A. of 1970, the corner points mentioned in lines 1 and 2 above were in conformance with regulations and rules therefore as required in the current manual of survey instructions of the United States Department of the Interior, Bureau of Land Management or by a decree of a Court of Law and/or that the corner points mentioned in lines 3, 4 and 5 above were in conformance with the rules of the Michigan Board of Land Surveyors or by a Decree of a Court of Law; established, re-established, monumented, re-monumented, recovered, found as expressed below:

NOTE: Not more than 4 corners, all in the same town and range, may be recorded on this certificate.

	A	B	C	D	E	F	G	H	I	J	K	L	M
2	6		5		4		3		2				
3													
4	7		8		9		10		11		12		
5													
6	18		17		16		15		14		13		
7													
8	19		20		21		22		23		24		
9													
10	30		29		28		27		26		25		
11													
12	31		32		33		34		35		36		
13													

A. Description of original monument and accessories and/or subsequent restoration:

- White Oak 36" N32W 60 Links
- White Oak 18" N65E 62 Links

Additional data on back.

B. Description of corner evidence found and/or method applied in restoring or reestablishing corner:

Found a 3/4" pipe 8' feet ± North of fence bent and laying down at edge of plowed field. Set by Atwell-Hicks on 4-7-1970. Extended baseline westerly 471.42' feet from the North 1/4 Corner of Section 3, Webster Township, Washtenaw County and reset South 1/4 Corner, Section 34, Hamburg Township.

C. Description of monument for corner and accessories established to perpetuate locating the position of the corner:

Set 1 1/2" x 36" iron pipe with brass cap marked Livingston County Monument Corner 5' feet ± North of East and West fence line.

- N30°E 211.58' N&T W/S 30" Cherry
- S85°E 13.97' N&T N/S 10" Cherry
- South 3.95' N&T W/S 6" Cherry
- S85°W 19.23' N&T N/S 8" Elm

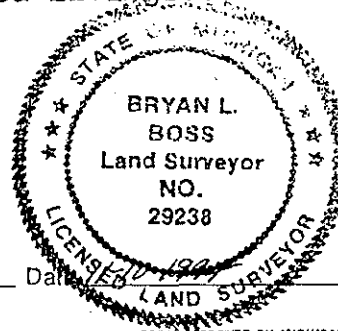

Signed by Bryan L. Boss
Surveyor's Michigan License No. 29238

TIN-R5E

H-13

Page 1

SUMMARY
H-13

SOUTH 1/4 CORNER, SECTION 34, T1N-R5E, HAMBURG TOWNSHIP,
LIVINGSTON COUNTY, MICHIGAN.

Found a 3/4" pipe 8' feet \pm North of fence bent and laying down at edge of plowed field. Also found 3/4" pipe 7 1/2' feet \pm North of fence and 471.42 feet East which is the North 1/4 Corner (page 13) of Section 3, H-1 Webster Township, Washtenaw County.

See Sketch Last Page.

On 10-13-94 Boss Engineering traversed Westerly to G-13. Found 1/2" rod 2 1/2 feet \pm South of 1' Corner post at a 5-way fence intersection in wooded area, page 15 this Dossier. On 10-17-94 continued Traverse Southerly to center of Section 3, Webster Township and checked Washtenaw Engineering Survey page 14, also found North 1/4 Corner, Section 3, per witnesses on said Survey. Calculated distance from G-13 to I-13 to be 5257.72' feet. A straight line produced from I-13 to fence Corner post 2 1/2 feet North of existing threaded rod at G-13 would place H-13 and H-1 in fence and 8' feet \pm South of present location. H-13 when set on midpoint between I-13 and G-13 would move the existing found point 133' \pm East. Not good for G.P.S. in existing fence Right-of-Way.

Note: Common ownership North-South and East-West of South 1/4 Corner, Section 34. There was no existing occupation at the found iron or at the midpoint location. Existing survey was found that used the existing 3/4" pipe for the establishment of property lines.

Conclusion: On 4-7-70, Atwell-Hicks survey on page 13 this Dossier shows extension of Baseline westerly 471.42 feet from North 1/4 corner of Section 3, Webster Township. A bearing and distance along the North & South 1/4 line of Section 34, Hamburg Township was determined and the South 1/4 corner set. We, therefore, find the 3/4" pipe set by Atwell-Hicks to be the South 1/4 Corner of Section 34.

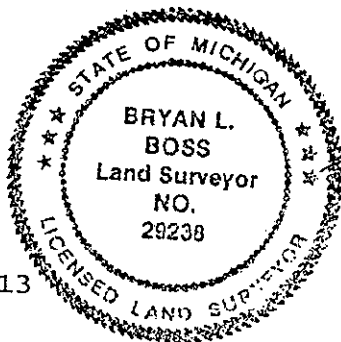

A handwritten signature in cursive script, appearing to read "Bryan L. Boss", written over the right side of the professional seal.

file:summh13