

**SURVEY & REMONUMENTATION**

FEB 25 1999

SECTION

**LAND CORNER RECORDATION CERTIFICATE**

Filing Requirement of Act 74, Mich. P.A. 1970

9-  
**FILED**

1998 OCT 27 P 2:22

For corners in

Livingston  
(County)

Located In:

Corner Code //

1. Public Land Survey	T <u>1N</u> R <u>5E</u>	<u>I-5</u>
	T ___ R ___	_____
	T ___ R ___	_____
	T ___ R ___	_____
2. Property Controlling in Section	S ___ T ___ R ___	_____
	S ___ T ___ R ___	_____
3. Miscellaneous Property in Sec.	S ___ T ___ R ___	_____
	S ___ T ___ R ___	_____

NANCY HAVILAND  
REGISTER OF DEEDS  
LIVINGSTON COUNTY, MI.  
48843

LSC961M

Register of Deeds Stamp & File Number

4. Lot No. \_\_\_\_\_, Recorded Plat \_\_\_\_\_  
5. Private Claims \_\_\_\_\_

I, Bryan L. Boss, in a field survey on Oct. 2, 19 98, do hereby certify that under requirements of P.A. 74, Michigan P.A. of 1970, the corner points mentioned in lines 1 and 2 above were in conformance with regulations and rules therefore as required in the current manual of survey instructions of the United States Department of the Interior, Bureau of Land Management or by a decree of a Court of Law and/or that the corner points mentioned in lines 3, 4 and 5 above were in conformance with the rules of the Michigan Board of Land Surveyors or by a Decree of a Court of Law; established, re-established, monumented, re-monumented, recovered, found as expressed below:

	A	B	C	D	E	F	G	H	I	J	K	L	M
2	6	5	4	3	2	1							
3													
4	7	8	9	10	11	12							
5													
6	18	17	16	15	14	13							
7													
8	19	20	21	22	23	24							
9													
10	30	29	28	27	26	25							
11													
12	31	32	33	34	35	36							
13													

NOTE: Not more than 4 corners, all in the same town and range, may be recorded on this certificate.

A. Description of original monument and accessories and/or subsequent restoration:

Set post 1823 by Wampler  
Black Oak 14" 59W 1.55 chain  
White Oak 5" N 13½ E 1.15 chain

B. Description of corner evidence found and/or method applied in restoring or reestablishing corner:

Found 1" Iron Rod

PA. 345 1980, APPROVED BY LIVINGSTON COUNTY  
PEER GROUP ON 9-16-98 CO. REP. JED

C. Description of monument for corner and accessories established to perpetuate locating the position of the corner:

Set 1½" by 36" Iron pipe and Brass Cap Stamped "Livingston County Monumentation Corner" 6" above ground

- S 70 E Remon N/T Southside 24" Locust 19.07'
- S 10 W Remon N/T Westside 28" Oak 38.25'
- N 66 W Remon N/T Northside 24" Oak 22.21'
- N 10 E Remon N/T Westside 14" Oak 18.60'

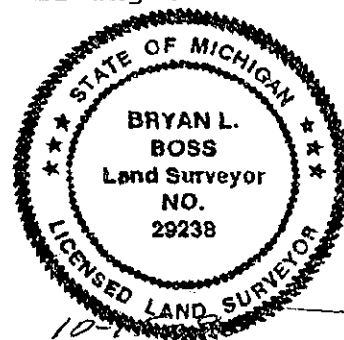

Signed by Bryan L. Boss  
Surveyor's Michigan License No. 29238

Date 10-27-98