

SURVEY & REMONUMENTATION

OCT 21 1999

SECTION

LAND CORNER RECORDATION CERTIFICATE Filing Requirement of Act 74, Mich. P.A. 1970

DEC 28 11 26 AM '93

NANCY HAVILAND REGISTER OF DEEDS LIVINGSTON COUNTY, MI 48843

For corners in

Livingston (County)

Located In:

Corner Code ##

1. Public Land Survey

T 1N R 5E I-11

Seg. # 1 pm

2. Property Controlling in Section

S T R

3. Miscellaneous Property in Sec.

S T R

L.S.C. #182m

Register of Deeds Stamp & File Number

4. Lot No. Recorded Plat
5. Private Claims

Grid table with columns A-M and rows 2-13. A dot is marked at the intersection of column I and row 11.

I, Bryan Boss, in a field survey on December 21, 1993, do hereby certify that under requirements of P.A. 74, Michigan P.A. of 1970, the corner points mentioned in lines 1 and 2 above were in conformance with regulations and rules therefore as required in the current manual of survey instructions of the United States Department of the Interior, Bureau of Land Management or by a decree of a Court of Law and/or that the corner points mentioned in lines 3, 4 and 5 above were in conformance with the rules of the Michigan Board of Land Surveyors or by a Decree of a Court of Law; established, re-established, monumented, re-monumented, recovered, found as expressed below:

NOTE: Not more than 4 corners, all in the same town and range, may be recorded on this certificate.

A. Description of original monument and accessories and/or subsequent restoration:

Unknown

B. Description of corner evidence found and/or method applied in restoring or reestablishing corner:

Found 1 1/2" Pipe 2 feet +/- Deep Raised with 1/2" x 18" Rebar 16.7 South of Centerline Strawberry Lake Road in Shoulder of Road

C. Description of monument for corner and accessories established to perpetuate locating the position of the corner:

Set 1 1/4" x 36" Iron Pipe with Brass Cap (Livingston Co. Monument Corner)

S75°W 36.90' Spike N/Side Power Pole
N45°W 77.70' Spike S/Side 30" Locust
NW Corner House 76.5' SW'ly
NE Corner House 71.2 SE'ly

Approved by Livingston Co. Monumentation Peer Group on September 8, 1993

Signed by [Signature]
Surveyor's Michigan License No. 29238

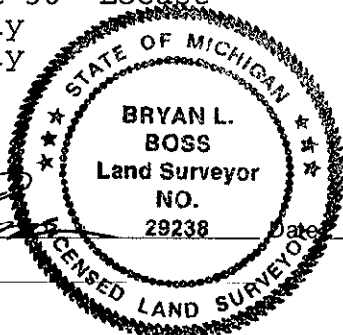

December 28, 1993