

9/2

LAND CORNER RECORDATION CERTIFICATE  
Filing Requirement of Act 74, Mich. P.A. 1970

JUN 14 8 32 AM '94  
NANCY HAVILANE  
REGISTER OF DEEDS  
LIVINGSTON COUNTY, MI  
48843

FILED

L.S.C.# 195m

Register of Deeds Stamp & File Number

For corners in

Livingston  
(County)

Located In:

Corner Code #

1. Public Land Survey	T	<u>1N</u>	R	<u>5E</u>	<u>I-11</u>
	T		R		
	T		R		
	T		R		
2. Property Controlling in Section	S		T		R
	S		T		R
3. Miscellaneous Property in Sec.	S		T		R
	S		T		R

4. Lot No. \_\_\_\_\_, Recorded Plat \_\_\_\_\_  
5. Private Claims \_\_\_\_\_

Bryan Boss, in a field survey on December 21, 1993

do hereby certify that under requirements of P.A. 74, Michigan P.A. of 1970, the corner points mentioned in lines 1 and 2 above were in conformance with regulations and rules therefore as required in the current manual of survey instructions of the United States Department of the Interior, Bureau of Land Management or by a decree of a Court of Law and/or that the corner points mentioned in lines 3, 4 and 5 above were in conformance with the rules of the Michigan Board of Land Surveyors or by a Decree of a Court of Law; established, re-established, monumented, re-monumented, recovered, found as expressed below:

NOTE: Not more than 4 corners, all in the same town and range, may be recorded on this certificate.

A. Description of original monument and accessories and/or subsequent restoration:

Surveyed Feb. 10, 1869 by M. W. Bullock

Witnesses: W. Oak 20 in. Dia. N42E 26 Lks.  
B. Oak 12 in. Dia. S75W 25 Lks.

Additional information on back.

Description of corner evidence found and/or method applied in restoring or reestablishing corner:

Found 1 1/2" Pipe 2 feet ± Deep Raised with 1/2" x 18" Rebar  
16.7 South of Centerline Strawberry Lake Road in Shoulder of Road

	A	B	C	D	E	F	G	H	I	J	K	L	M
2	6		5		4		3		2				
3													
4	7		8		9		10		11		12		
5													
6	18		17		16		15		14		13		
7													
8	19		20		21		22		23		24		
9													
10	30		29		28		27		26		25		
11													
12	31		32		33		34		35		36		
13													

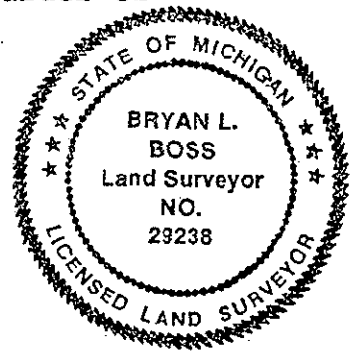

Description of monument for corner and accessories established to perpetuate locating the position of the corner:

Set 1 1/4" x 36" Iron Pipe with Brass Cap  
(Livingston Co. Monument Corner)

S75°W 36.90' Spike N/Side Power Pole  
N45°W 77.70' Spike S/Side 30" Locust  
NW Corner House 76.5' SW'ly  
NE Corner House 71.2 SE'ly

Approved by Livingston Co. Monumentation Peer Group on September 8, 1993

Signed by Bryan L. Boss  
Surveyor's Michigan License No. 29238

Date December 28, 1993

RA. 345 1232, APPROVED BY LIVINGSTON COUNTY  
PEER GROUP ON 8 Sept. 1993 CO. REP Kahl

# BOSS ENGINEERING ENGINEERS & SURVEYORS

## SUMMARY I-11

NW Corner Section 35 Hamburg Township T1N-R5E

Found 1/2" x 18" rebar on top of 1 1/2" pipe 2 feet ± deep in shoulder of road. Centerline of Strawberry Lake Road is 16.7 feet north.

Set February 10, 1869 by M. W. Bullock. Reestablished corner by witnesses of 1967 survey by Munsell & Garlock. Land Corner Recordation certificate dated October 16, 1974 by Oscar Boss locates same corner by witnesses.

In 1991, William Carlson L.S. No. 14759 records same corner.

Bryan L. Boss, P.S. 29238

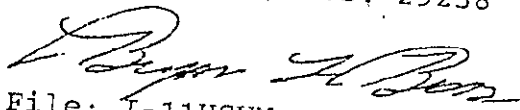

File: I-11HSUM

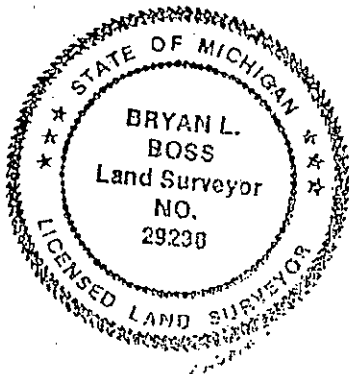

Boss Engineering Company • 3121 East Grand River • Howell Mich  
Phone (517) 546-4836 • Brighton (313) 229-4773 • Fax (517) 5