

FILED

LAND CORNER RECORDATION CERTIFICATE  
Filing Requirement of Act 74, Mich. P.A. 1970

DEC 29 11 26 AM '93  
NANCY HAVILAND  
REGISTER OF DEEDS  
LIVINGSTON COUNTY, MI  
48843

For corners in

Livingston (County) Located In: Corner Code I-13

1. Public Land Survey T 1N R 5E

2. Property Controlling in Section S \_\_\_ T \_\_\_ R \_\_\_

3. Miscellaneous Property in Sec. S \_\_\_ T \_\_\_ R \_\_\_

L.S.C. #183m

Register of Deeds Stamp & File Number

- 4. Lot No. \_\_\_\_\_, Recorded Plat \_\_\_\_\_
- 5. Private Claims \_\_\_\_\_

A	B	C	D	E	F	G	H	I	J	K	L	M
2	6	5	4	3	2	1						
3												
4	7	8	9	10	11	12						
5												
6	18	17	16	15	14	13						
7												
8	19	20	21	22	23	24						
9												
10	30	29	28	27	26	25						
11												
12	31	32	33	34	35	36						
13												

I, Bryan Boss, in a field survey on December 21, 1993, do hereby certify that under requirements of P.A. 74, Michigan P.A. of 1970, the corner points mentioned in lines 1 and 2 above were in conformance with regulations and rules therefore as required in the current manual of survey instructions of the United States Department of the Interior, Bureau of Land Management or by a decree of a Court of Law and/or that the corner points mentioned in lines 3, 4 and 5 above were in conformance with the rules of the Michigan Board of Land Surveyors or by a Decree of a Court of Law; established, re-established, monumented, re-monumented, recovered, found as expressed below:

NOTE: Not more than 4 corners, all in the same town and range, may be recorded on this certificate.

A. Description of original monument and accessories and/or subsequent restoration:

Surveyed by Grant Dunning 1929

B. Description of corner evidence found and/or method applied in restoring or reestablishing corner:

Found 1" Pipe 34.5 Feet West of Fence Corner Post

SURVEY &  
REMONUMENTATION  
1993  
COMMISSION

C. Description of monument for corner and accessories established to perpetuate locating the position of the corner:

Set 1 1/4" x 36" Iron Pipe with Brass Cap (Livingston Co. Monument Corner)

- N5°W 7.45' Spike E/Side 20" Oak
- N80°E 8.12' Spike S/Side 10" Oak
- S70°E 26.17' Spike N/Side 24" Oak
- S75°W 8.45' Spike E/Side 12" Oak

Approved by Livingston Co. Monumentation Peer Group on September 29, 1993

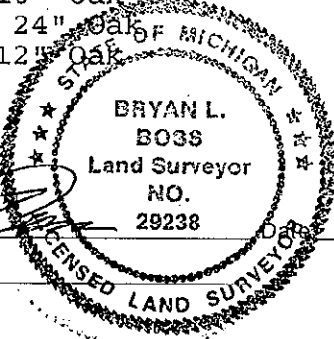

Signed by [Signature]  
Surveyor's Michigan License No. 29238

December 28, 1993