

1996 NOV 25 A 9:39

LAND CORNER RECORDATION CERTIFICATE
Filing Requirement of Act 74, Mich. P.A. 1970

For corners in

Livingston
(County)

Located in:

Corner Code #

- 1. Public Land Survey T 1N R 5E K-4
 T _____ R _____
 T _____ R _____
 T _____ R _____
- 2. Property Controlling S _____ T _____ R _____
 in Section S _____ T _____ R _____
- 3. Miscellaneous S _____ T _____ R _____
 Property in Sec. S _____ T _____ R _____

L.S.C. #610m

Register of Deeds Stamp & File Number

- 4. Lot No. _____, Recorded Plat _____
- 5. Private Claims _____

I, Bryan Boss, in a field survey on July 29, 1996, do hereby certify that under requirements of P.A. 74, Michigan P.A. of 1970, the corner points mentioned in lines 1 and 2 above were in conformance with regulations and rules therefore as required in the current manual of survey instructions of the United States Department of the Interior, Bureau of Land Management or by a decree of a Court of Law and/or that the corner points mentioned in lines 3, 4 and 5 above were in conformance with the rules of the Michigan Board of Land Surveyors or by a Decree of a Court of Law; established, re-established, monumented, re-monumented, recovered, found as expressed below:

NOTE: Not more than 4 corners, all in the same town and range, may be recorded on this certificate.

A. Description of original monument and accessories and/or subsequent restoration:

White oak 36" N 83° E .73
Black oak 23" S 19½° W 1.27

B. Description of corner evidence found and/or method applied in restoring or reestablishing corner:

Found "T" fence post set by Lyle Munsell in 1957.

C. Description of monument for corner and accessories established to perpetuate locating the position of the corner:

Set 1½"x36" Iron pipe with Brass Cap stamped
Livingston County Remonumentation Corner
West 21.20' Nail & Tag Southside 36" Oak
N 10° W 5.00' Nail & Tag Westside 6" Oak
S 80° E 17.70' Nail & Tag Northside 12" Twin Oak
S 35° W 23.67' Nail & Tag Northwest side 8" Oak

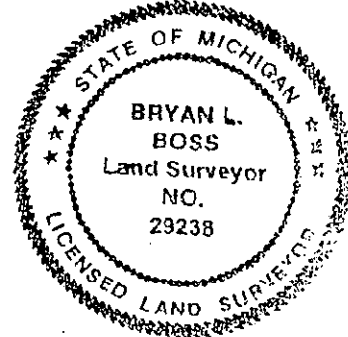

Signed by Bryan L. Boss Date Sept. 26, 1996
Surveyor's Michigan License No. 29238

SUMMARY

K-4

West ¼ Corner, Section 12, T1N-R5E, Hamburg Township, Livingston County, Michigan

Found "T" fence post 2 feet ± above ground. On page 14 of this dossier, Lyle Munsell surveyed in 1957 denotes 4½ foot steel fence post set at west ¼ corner, section 12, and measured 2014.6 feet east to centerline of Hamburg Road (corrected by C.E. Garlock to 1993.0 feet on 3-27-91).

On 10-13-71, Douglas L. Tredinnick R.L.S. #13602 set ¾" iron pipe, witnessed same and measured 2014.60 feet to P.K.. nail set in centerline of Hamburg Road. All trees were blazed. Tredinnick also set ¾" iron pipe at northwest corner of Section 12, T1N-R5E and measured 2649.46 feet. This is comparable to Grant Dunnings measurement of 2648 feet. Douglas Tredinnick also filed an Act 74 certificate on October 11, 1971.

On August 22, 1973, Boss Engineering surveyed and recorded distance of 2650.67 feet from West ¼ Corner, Section 12, to the Southwest Corner of said Section but we find no comparisons. On March 27,, 1991, Charles E. Garlock and on 2-29-96 Boss Engineering found and used "T" fence post found or set by Lyle Munsell.. We presume that Douglas Tredinnick recorded and measured 2014.60 feet off Lyle Munsells survey on page 14, this dossier, which Charles Garlock found in error by 21.6 feet. This would likely account for Garlock witness on page 20, N 71° W, 23.05 feet ¾" pipe. On 2-29-96, Boss Engineering found Tredinnick blazed witness trees, but the ¾" iron pipe was not found utilizing witnesses, his witnesses or Garlock witness.

Therefore, we find the "T" fence post set by Munsell on 11-25-57 to be the West ¼, Section 12.

file: SUMMK-4

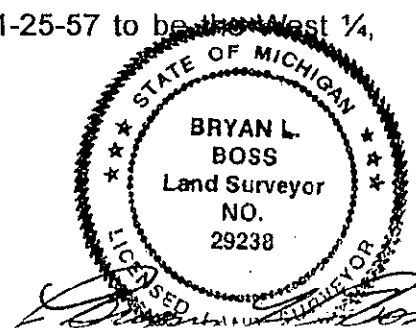

T1N-R5E
K-4 Pg. 4