

SUMMARY

K-5

Southwest Corner, Section 12, T1N-R5E, Hamburg Township, Livingston County,
Michigan

Found ½" iron rod in concrete monument at new split rail fence South and West of
corner. Difficult G.P.S. Station to occupy. No original witnesses found (see page 14,
Clay Gordon field notes).

On August 22, 1973, Boss Engineering surveyed and recorded an Act 74 on 2-15-74
(see page 19). Oscar Boss's description of corner evidence found and/or method
applied in restoring or re-establishing corner was a ½" iron set at old fence intersection.
This was followed by a Patrick L. Benton survey on October 13, 1980. Note that the
witnesses coincide with Boss Engineering witnesses.

On August 19, 1985, Patrick Benton measured 1595.05 feet from SW ~~X~~ of Section 12,
Easterly to the centerline of Hamburg Road and on 3-29-89, Boss Engineering again
measured 1595.05 feet (see page 21 & 22 of this dossier).

Two of the 1973 witnesses were found and they checked.

We find that the ½" iron set by Oscar Boss at old fence intersection on May 4, 1973 is
same as found and recommend its acceptance.

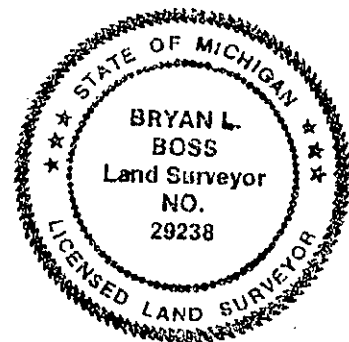

A handwritten signature in cursive script, appearing to read "Bryan L. Boss", written below the professional seal.