

OCT 26 1995

COMMISSION

LAND CORNER RECORDATION CERTIFICATE

Filing Requirement of Act 74, Mich. P.A. 1970

HANCI HAVILANI, REGISTER OF DEEDS, LIVINGSTON COUNTY, MI 48843

OCT 4 3 19 PM '95

FILED

For corners in

Livingston (County)	Located in:	Corner Code =#
1. Public Land Survey	T 1N R 5E	K-8
	T R	
	T R	
	T R	
2. Property Controlling in Section	S T R	
	S T R	
3. Miscellaneous Property in Sec.	S T R	
	S T R	

L.S.C. #45 1m

Register of Deeds Stamp & File Number

4. Lot No. \_\_\_\_\_, Recorded Plat \_\_\_\_\_  
5. Private Claims \_\_\_\_\_

	A	B	C	D	E	F	G	H	I	J	K	L	M
2	5		5		4		3		2				
3													
4	7		8		9		10		11		12		
5													
6	18		17		16		15		14		13		
7													
8	19		20		21		22		23		24		
9													
10	30		29		28		27		26		25		
11													
12	31		32		33		34		35		36		
13													

1. Bryan Boss in a field survey on 8-21, 19 95 do hereby certify that under requirements of P.A. 74, Michigan P.A. of 1970, the corner points mentioned in lines 1 and 2 above were in conformance with regulations and rules therefore as required in the current manual of survey instructions of the United States Department of the Interior, Bureau of Land Management or by a decree of a Court of Law and/or that the corner points mentioned in lines 3, 4 and 5 above were in conformance with the rules of the Michigan Board of Land Surveyors or by a Decree of a Court of Law; established, re-established, monumented, re-monumented, recovered, found as expressed below:

NOTE: Not more than 4 corners, all in the same town and range, may be recorded on this certificate.

A. Description of original monument and accessories and/or subsequent restoration:

- Black Oak 8" S 26 1/2 W 16
- Black Oak 7" N 67 1/2 E 18
- White Oak 6" S 60 1/2 E .08 (1872)

B. Description of corner evidence found and/or method applied in restoring or reestablishing corner:

Found nail set by Patrick Benton R.L.S. No. 19826 on top centerline fence corner post.  
N 45° E 6.03' nail West side 14" Hickory  
S 45° E 29.80' Nail West side 14" Hickory  
South 34.00' nail West side 12" Oak  
S 70° W 18.39' nail South side 15" oak

C. Description of monument for corner and accessories established to perpetuate locating the position of the corner:

Set brass cap in 36" pipe at Grade surface.  
6.18' N 40° E nail & tag Northwest side 15" Ash  
34.32' South nail & tag West side 15" Oak  
17.99' S 60° W nail & tag Southeast side 24" Oak  
11.13' N 75° W nail & tag North side 6" Ash

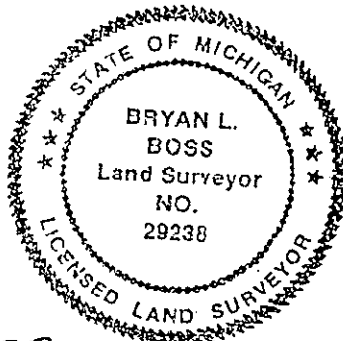

Signed by Bryan L. Boss Date Sept. 28, 1995

Surveyor's Michigan License No. 29238

SUMMARY

K-8

West 1/4 Corner, Section 24, T1N-R5E, Hamburg Township.

Found nail on top of 8" fence post in wooded area. Occupational fence lines North and West. Difficult point for G.P.S..

Bureau of Land Management notes on page 9 this dossier calls for 40.15 chains (2649.9 feet) circa 1880s.

On October 4, 1977, Patrick L. Benton set nail at C/L fence corner post. Note distance from N.W. corner of section measures 2649.93 feet to West  $\frac{1}{4}$  corner.

In 1982, Norman Fahrner accepted same nail in top of 8" corner fence post and filed an Act 74 certificate. Again in 1989, Tri-County Surveys utilized same nail in top of fence post when the Southwest  $\frac{1}{4}$  of section 24 was broken down. Boss Engineering submitted two plats referenced to same nail in top of post.

Conclusion:

We recommend removal of corner post (which has begun to rotten) and place permanent monument at existing location.

summk-8

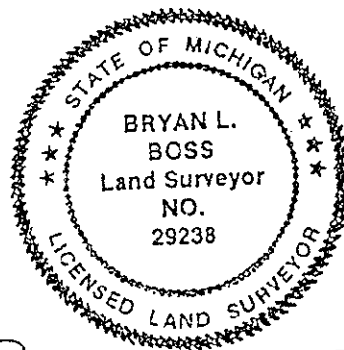

*Bryan L. Boss*