

OCT 26 1995

COMMISSION

LAND CORNER RECORDATION CERTIFICATE  
Filing Requirement of Act 74, Mich. P.A. 1970

OCT 6 11 55 AM 1995  
MAYOR HAYLANE  
REGISTER OF DEEDS  
LIVINGSTON COUNTY, MI  
48843

corners in Livingston	Located In:	Corner Code #/
(County)		
Public Land Survey	T <u>1N</u> R <u>5E</u>	<u>L-7</u>
	T _____ R _____	_____
	T _____ R _____	_____
	T _____ R _____	_____
Property Controlling in Section	S _____ T _____ R _____	_____
	S _____ T _____ R _____	_____
Miscellaneous Property in Sec.	S _____ T _____ R _____	_____
	S _____ T _____ R _____	_____

L. S. C. #474m

Register of Deeds Stamp & File Number

Lot No. \_\_\_\_\_, Recorded Plat \_\_\_\_\_  
Private Claims \_\_\_\_\_

	A	B	C	D	E	F	G	H	I	J	K	L	M
2	6	5	4	3	2	1							
3													
4	7	8	9	10	11	12							
5													
6	18	17	16	15	14	13							
7													
8	19	20	21	22	23	24							
9													
10	30	29	28	27	26	25							
11													
12	31	32	33	34	35	36							
13													

Bryan Boss 8-21 95

I, Bryan Boss, in a field survey on 8-21, 1995, hereby certify that under requirements of P.A. 74, Michigan P.A. of 1970, the corner points mentioned in lines 1 and 2 above were in conformance with regulations and rules therefore as required in the present manual of survey instructions of the United States Department of the Interior, Bureau of Land Management or by a decree of a Court of Law and/or that the corner points mentioned in lines 3, 4 and 5 above were in conformance with the rules of the Michigan Board of Land Surveyors or by a Decree of a Court of Law; established, re-established, monumented, re-monumented, recovered, found as recited below:

Note: Not more than 4 corners, all in the same town and range, may be recorded on this certificate.

Description of original monument and accessories and/or subsequent restoration:

- Black Oak 14" N 19 1/2 E 9 links
- White Oak 12" S 54° W 20 1/2 links
- White Oak 20" N 37 W 30 (1872)

Description of corner evidence found and/or method applied in restoring or reestablishing corner:

- Found 1/2" capped pipe (unidentifiable R.L.S numbers)
- 20 feet ± north of Ore Lake Road
- West 34.04' nail southside 13" Oak
- South 39.82' nail west side utility pole
- N 5° E 25.00' S.W. corner of house

Description of monument for corner and accessories established to perpetuate locating the position of the corner:

- Set brass cap in 36" pipe 2" below surface
- 0.80' north and 0.40' east of existing location
- 25.02' N 30° E southwest corner of house
- 80.08' S 45° E nail & tag west side 10" Cedar
- 39.62' S 10° W nail & tag west side power pole
- 33.91' west nail & tag south side 20" Oak

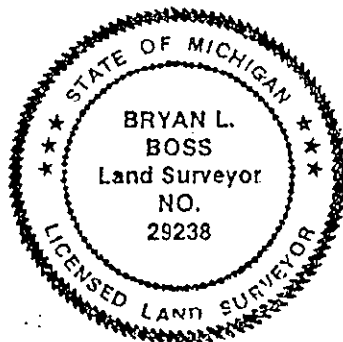

Witnessed by Bryan L. Boss Date Oct. 4, 1995  
Surveyor's Michigan License No. 29238

SUMMARY  
L-7

North 1/4 Corner, Section 24, T1N-R5E, Hamburg Township,  
Livingston County, Michigan.

Found 1/2" I.D. Capped pipe (unidentifiable R.L.S. numbers)  
0.4 feet below surface. Centerline of Ore Lake Road is 20  
feet  $\pm$  South and chain link fence is 0.4 feet west of  
existing location.

Clay Gordon's 1934 "Shannon Shores" plat and Earl Fullers  
1936 "Ore Lake Little Farms " measure 1317.2 feet west to  
centerline of Hamburg Road. Grant Dunnings survey in 1918  
(see page 11) calls out 20.04 chains (1322.64 feet).

Bernard Feldhauser plat on page 19 and Patrick Benton survey  
on page 20 calls for 1947.2 feet and 1947.50 feet  
respectively on tie-in distance from North 1/4 Corner to  
"Winans View" plat Corner.

Conclusion:

Patrick Benton Witnesses on 4-17-76 and 10-4-77 do not agree  
with the present location. Therefore, we recommend  
placement of North 1/4 Corner of Section 24 ~~0.08~~ feet North  
and 0.40 feet East of existing location.

HAML-7S

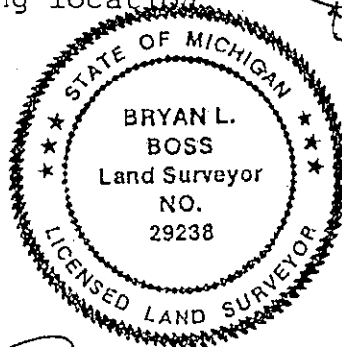

*Bryan L. Boss*