

OCT 26 1995

COMMISSION

LAND CORNER RECORDATION CERTIFICATE
Filing Requirement of Act 74, Mich. P.A. 1970

For corners in

<u>Livingston</u> (County)	Located In:	Corner Code \neq
1. Public Land Survey	T <u>1N</u> R <u>5E</u>	<u>L-9</u>
	T _____ R _____	_____
	T _____ R _____	_____
	T _____ R _____	_____
2. Property Controlling in Section	S _____ T _____ R _____	_____
	S _____ T _____ R _____	_____
3. Miscellaneous Property in Sec.	S _____ T _____ R _____	_____
	S _____ T _____ R _____	_____

HANCOCK HAVILAND
 REGISTER OF DEEDS
 LIVINGSTON COUNTY, MI
 48843

Oct 4 3 19 PM '95
 RECORDED

L.S.C. #452m

Register of Deeds Stamp & File Number

4. Lot No. _____, Recorded Plat _____
 5. Private Claims _____

A	B	C	D	E	F	G	H	I	J	K	L	M
2	6	5	4	3	2	1						
3												
4	7	8	9	10	11	12						
5												
6	18	17	16	15	14	13						
7												
8	19	20	21	22	23	24						
9												
10	30	29	28	27	26	25						
11												
12	31	32	33	34	35	36						
13												

I, Bryan Boss, in a field survey on 8-23, 19 95, do hereby certify that under requirements of P.A. 74, Michigan P.A. of 1970, the corner points mentioned in lines 1 and 2 above were in conformance with regulations and rules therefore as required in the current manual of survey instructions of the United States Department of the Interior, Bureau of Land Management or by a decree of a Court of Law and/or that the corner points mentioned in lines 3, 4 and 5 above were in conformance with the rules of the Michigan Board of Land Surveyors or by a Decree of a Court of Law; established, re-established, monumented, re-monumented, recovered, found as expressed below:

NOTE: Not more than 4 corners, all in the same town and range, may be recorded on this certificate.

A. Description of original monument and accessories and/or subsequent restoration:

- Black Oak 20" S 83 1/2 E 14
- Koy 4" N 26 1/2 E 21
- Hickory 5" N 50 W 71 1/2 links
- Hickory 10" S 43 1/2 E 57 links

B. Description of corner evidence found and/or method applied in restoring or reestablishing corner:

- Found 1/2 inch pipe in monument box on Centerline of Hamburg Road
- S 65° W T. Pole 98.99'
- N 40° W P. Pole 106.56'
- S 25° E P. Pole 86.20'

C. Description of monument for corner and accessories established to perpetuate locating the position of the corner:

- Set brass cap on 1/2 inch pipe in monument box.
- 21.23' N 80° E arrow sign post
- 86.53' S 45° E nail & tag northeast side power pole
- 74.93' S 15° W nail & tag West side light pole
- 77.84' N 85° W Northeast corner brick pump house
- 106.48' N 30° W Nail & tag East side power pole



Signed by Bryan L. Boss

Date Sept 28, 1995

Surveyor's Michigan License No. 29238

SUMMARY
L-9

North 1/4 Corner, Section 25, T1N-R5E, Hamburg Township,
Livingston County, Michigan.

Found 1/2" I.O. pipe in monument box on centerline of
Hamburg Road. Clean sweep of area revealed no other
corners. This area is also open for G.P.S.

This dossier contains evidence that seven (7) surveyors have
utilized this corner. All, with the exception of surveyor
number 3, concur with the present location, see pages 6 and
7.

Conclusion:

We conclude that the 1/2" pipe in cased in a monument box is
the accepted corner.

HAML-9S

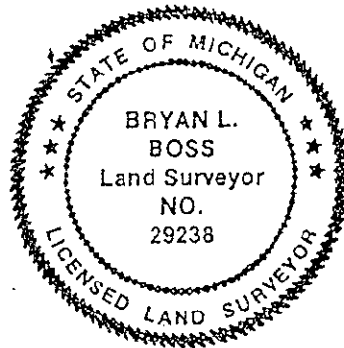

Bryan L. Boss