

FILED

9/2

JUN 14 8 32 AM '94

LAND CORNER RECORDATION CERTIFICATE  
Filing Requirement of Act 74, Mich. P.A. 1970

NANCY HAVILAND  
REGISTER OF DEEDS  
LIVINGSTON COUNTY, MI  
48843

For corners in Livingston

(County)	Located In:	Corner Code #
	1N 5E	L-13
1. Public Land Survey	T ___ R ___	_____
	T ___ R ___	_____
	T ___ R ___	_____
	T ___ R ___	_____
2. Property Controlling in Section	S ___ T ___ R ___	_____
	S ___ T ___ R ___	_____
3. Miscellaneous Property in Sec.	S ___ T ___ R ___	_____
	S ___ T ___ R ___	_____

L.S.C.# 194m

Register of Deeds Stamp & File Number

4. Lot No. \_\_\_\_\_, Recorded Plat \_\_\_\_\_  
5. Private Claims \_\_\_\_\_

	A	B	C	D	E	F	G	H	I	J	K	L	M
2	6	5	4	3	2	1							
3													
4	7	8	9	10	11	12							
5													
6	18	17	16	15	14	13							
7													
8	19	20	21	22	23	24							
9													
10	30	29	28	27	26	25							
11													
12	31	32	33	34	35	36							
13													

Bryan Boss December 21 93

I, Bryan Boss, in a field survey on December 21, 1993, do hereby certify that under requirements of P.A. 74, Michigan P.A. of 1970, the corner points mentioned in lines 1 and 2 above were in conformance with regulations and rules therefore as required in the current manual of survey instructions of the United States Department of the Interior, Bureau of Land Management or by a decree of a Court of Law and/or that the corner points mentioned in lines 3, 4 and 5 above were in conformance with the rules of the Michigan Board of Land Surveyors or by a Decree of a Court of Law; established, re-established, monumented, re-monumented, recovered, found as expressed below:

NOTE: Not more than 4 corners, all in the same town and range, may be recorded on this certificate.

A. Description of original monument and accessories and/or subsequent restoration:

G. L. O. December 14, 1815  
Witnesses B. O. 16" S 9 E. 47  
D. O. 7" N 86 W. 42

Additional information on back.

B. Description of corner evidence found and/or method applied in restoring or reestablishing corner:

Found 1 1/2" Iron Rod 153.45' West of N 1/4 Sec. 1 Webster Township, Washtenaw Co.

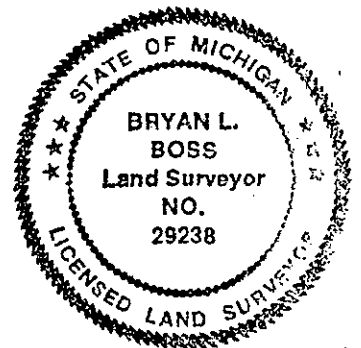

C. Description of monument for corner and accessories established to perpetuate locating the position of the corner:

Set 1 1/4" x 36" Iron Pipe with Brass Cap (Livingston Co. Monument Corner)

N80°E 76.50' Spike S/Side 18' Oak  
S45°E 83.10' Spike W/Side 16" Oak  
S58°E 21.45' Spike S/Side 8" Box Elder  
N62°W 34.20' Spike S/Side 10" Oak

Approved by Livingston Co. Monumentation Peer Group on \_\_\_\_\_

Signed by Bryan L. Boss Date June 8, 1994

Surveyor's Michigan License No. 29238

PA 345 1990, APPROVED BY LIVINGSTON COUNTY  
PEER GROUP ON 2 Sept. '93, CO. REP

**BOSS ENGINEERING**  
**ENGINEERS & SURVEYORS**

SUMMARY L-13

S 1/4 Corner    Section 36    Hamburg Township    T1N-R5E

Found a 1 1/2" iron pipe in east and west fence row, 153.45 west of north 1/4 corner of Section 1, Webster Township, Washtenaw County. This 1/4 corner located in centerline of Old Hamburg Road. Witnesses in field concur with 1979 Ros Kelly, Jekabson and Associates survey. Also Boss Engineering recorded surveys Liber 1396, page 0504, and Liber 1549, page 0609.

Bryan L. Boss, P.S. 29238

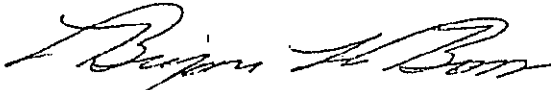

File: L-13HSUM

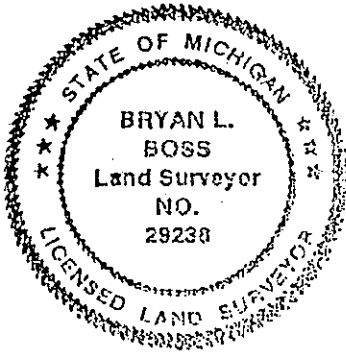

Boss Engineering Company • 3121 East Grand River • Howell Michigan 48843  
Phone (517) 546-4836 • Brighton (313) 229-4773 • Fax (517) 548-1670

1111 VOR 2111111111

NOT RECORDED BY REGISTERED COUNTY CLERK