

1996 NOV 25 A 9:39

LAND CORNER RECORDATION CERTIFICATE
Filing Requirement of Act 74, Mich. P.A. 1970

HANCY HAVILAND
REGISTER OF DEEDS
LIVINGSTON COUNTY, MI.
48843

For corners in

Livingston (County)	Located in:	Corner Code #/
1. Public Land Survey	T 1N R 5E	M-4
	T R	
	T R	
	T R	
2. Property Controlling in Section	S T R	
	S T R	
3. Miscellaneous Property in Sec.	S T R	
	S T R	

L.S.C.#615m

Register of Deeds Stamp & File Number

- 4. Lot No. _____, Recorded Plat _____
- 5. Private Claims _____

	A	B	C	D	E	F	G	H	I	J	K	L	M
2	6	5	4	3	2	1							
3													
4	7	8	9	10	11	12							
5													
6	18	17	16	15	14	13							
7													
8	19	20	21	22	23	24							
9													
10	30	29	28	27	26	25							
11													
12	31	32	33	34	35	36							
13													

I, Bryan Boss, in a field survey on July 29, 1996, do hereby certify that under requirements of P.A. 74, Michigan P.A. of 1970, the corner points mentioned in lines 1 and 2 above were in conformance with regulations and rules therefore as required in the current manual of survey instructions of the United States Department of the Interior, Bureau of Land Management or by a decree of a Court of Law and/or that the corner points mentioned in lines 3, 4 and 5 above were in conformance with the rules of the Michigan Board of Land Surveyors or by a Decree of a Court of Law; established, re-established, monumented, re-monumented, recovered, found as expressed below:

NOTE: Not more than 4 corners, all in the same town and range, may be recorded on this certificate.

A. Description of original monument and accessories and/or subsequent restoration:

Corner in pond.

B. Description of corner evidence found and/or method applied in restoring or reestablishing corner:

Found 1/2" capped iron in frozen swamp R.L.S. number obliterated.

C. Description of monument for corner and accessories established to perpetuate locating the position of the corner:

Set 1 1/2"x36" Iron pipe with Brass Cap stamped Livingston County Remonumentation Corner.
 North 41.22 Nail & Tag East side 3" Tamarack
 S 80° E 20.25 Nail & Tag South side 4" Tamarack
 S 10° W 19.68 Nail & Tag East side 5" Tamarack
 N 80° W 57.50 Nail & Tag North side 4" Tamarack

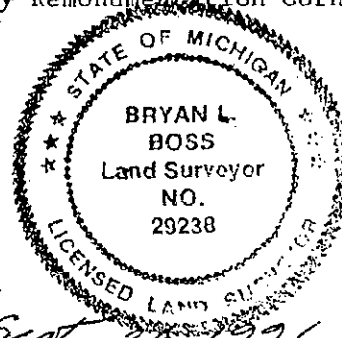

Signed by Bryan L. Boss Date Sept 26 1996
 Surveyor's Michigan License No. 29238

SUMMARY

M-4

East ¼ Corner, Section 12, T1N-R5E, Hamburg Township, Livingston County, Michigan

Found ½" capped iron 0.3 feet± deep in frozen swamp. R.L.S. # was obliterated.

Original survey in 1823 calls for 30.00 chains pond; 40.00 chains comes into pond; 46.00 chains left pond.

On July 17 & 18, 1925, Grant Dunning measured 530' south to the West ¼ Corner of Section 7, T1N-R6E. On 8-16-74, Patrick L. Benton notes 530.00 feet recorded (deed) but measures 540.23 feet per description on Pages 13-14, this dossier. Benton set both corners in 1974 and makes reference to survey by George E. Kattouah on 12-14-71.

Again in 1976, Patrick Benton measured West to center of Section from found East ¼ Corner, a distance of 2641.37 feet. George Kattouah measured 2641.4, Charles Garlock measured 2641.38 feet, and Progressive measured 2642.05 feet. 3 of 4 witnesses compare among 4 surveyors. The February 1996 witnesses are the same as those set by Patrick Benton in 1974.

The corner found is in a swamp but open to G.P.S.

We recommend accepting the ½" iron as found to be the East ¼ Corner, Section 12.

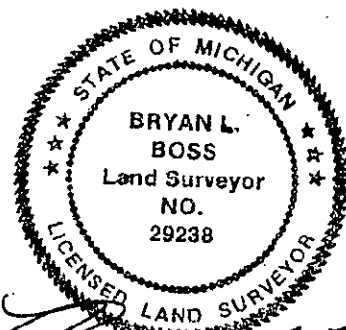

Bryan L. Boss

T1N-R5E
M-4
Pg. 4
PAGE 4