

FILED

DEC 29 11 26 AM '93

LAND CORNER RECORDATION CERTIFICATE
Filing Requirement of Act 74, Mich. P.A. 1970

NANCY HAVILAND
REGISTER OF DEEDS
LIVINGSTON COUNTY, MI
48843

For corners in

Livingston (County) Located In: Corner Code # M-13
1. Public Land Survey T 1N R 5E
2. Property Controlling in Section S T R
3. Miscellaneous Property in Sec. S T R
4. Lot No. , Recorded Plat
5. Private Claims

L.S.C. #190m
Register of Deeds Stamp & File Number

I, Bryan Boss, in a field survey on December 21, 1993, do hereby certify that under requirements of P.A. 74, Michigan P.A. of 1970, the corner points mentioned in lines 1 and 2 above were in conformance with regulations and rules therefore as required in the current manual of survey instructions of the United States Department of the Interior, Bureau of Land Management or by a decree of a Court of Law and/or that the corner points mentioned in lines 3, 4 and 5 above were in conformance with the rules of the Michigan Board of Land Surveyors or by a Decree of a Court of Law; established, re-established, monumented, re-monumented, recovered, found as expressed below:

NOTE: Not more than 4 corners, all in the same town and range, may be recorded on this certificate.

A. Description of original monument and accessories and/or subsequent restoration:

Survey by Grand Dunning 1929

B. Description of corner evidence found and/or method applied in restoring or reestablishing corner:

Found 1/2" Pipe With Cap 1.5 feet South of Centerline 8 Mile Road

C. Description of monument for corner and accessories established to perpetuate locating the position of the corner:

Set 1/2" x 30" Iron Rod and Raised with 1 1/4" x 6" Iron Pipe with Brass Cap Marked Livingston Co. Monument Corner Set in Monument Box

S70°E 112.17' Spike N/Side Power Pole
S65°W 81.70' Spike N/Side Power Pole
North 28.58' Spike Top of Corner Post
N45°W 88.10 Spike S/Side 8" Elm
S20°W 47.00 Spike E/Side Tri...

Approved by Livingston Co. Monumentation Peer Group on September 8, 1993

Signed by Bryan L. Boss Date December 28, 1993

Surveyor's Michigan License No. 29238

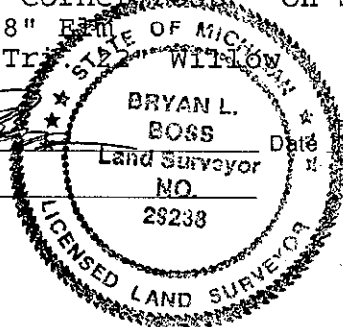

Grid table with columns A-M and rows 2-13. Numbers 1-36 are placed in the grid cells.

SURVEY &
REMONUMENTATION
1993
COMMISSION