

4-

LAND CORNER RECORDATION CERTIFICATE
Filing Requirement of Act 74, Mich. P.A. 1970

FILED

For Corners in GREEN OAK TWP.

LIVINGSTON (COUNTY)	Located In	Corner Code #
1. Public Land Survey	T1N R6E	A-7
	T__ R__	_____
	T__ R__	_____
	T__ R__	_____
2. Property Controlling in Section	S__ T__ R__	_____
	S__ T__ R__	_____
3. Miscellaneous Property in Sec.	S__ T__ R__	_____
	S__ T__ R__	_____
4. Lot No. _____, Recorded Plat _____		
5. Private Claims _____		

1996 DEC -3 P 3:00 RA

NANCY HAVILAND
REGISTER OF DEEDS
LIVINGSTON COUNTY, MI.
48843

L.S.C. #624m

REGISTER OF DEEDS STAMP & FILE NUMBER

	A	B	C	D	E	F	G	H	I	J	K	L	M
2	6	5	4	3	2	1							
3													
4	7	8	9	10	11	12							
5													
6	18	17	16	15	14	13							
7													
8	19	20	21	22	23	24							
9													
10	30	29	28	27	26	25							
11													
12	31	32	33	34	35	36							
13													

I, BRYAN L. BOSS in a field survey on NOVEMBER 12, 1996, do hereby certify that under requirements of P.A. 74, Michigan P.A. of 1970, the corner points mentioned in lines 1 and 2 above were in conformance with regulations and rules therefore as required in the current manual of survey instructions of the United States Department of the Interior, bureau of Land Management or by a decree of a Court of Law and/or that the corner points mentioned in lines 3, 4 and 5 above were in conformance with the rules of the Michigan Board of Land Surveyors or by a Decree of a Court of Law, established, re-established, monumented, re-monumented, recovered, found as expressed below:

NOTE: Not more than 4 corners, all in the same town and range, may be recorded on this certificate.

A. Description of original monument and accessories and/or subsequent restoration:

WHITE OAK 15" N 78° E .68
WHITE OAK 13" S 51° E .88

B. Description of corner evidence found and/or applied in restoring or reestablishing corner:

FOUND CONCRETE MONUMENT 1 FOOT ± EAST OF FENCE AND 563.20 FEET SOUTH OF NORTHEAST CORNER SECTION 24, T1N-R5E, HAMBURG TOWNSHIP.

C. Description of monument for corner and accessories established to perpetuate location the position of the corner:

SET 1 1/4" X 36" IRON PIPE WITH BRASS CAP STAMPED "LIVINGSTON COUNTY REMONUMENTATION CORNER" 0.20' SOUTH AND 2.92' EAST OF FOUND CONCRETE MONUMENT.

N 10° E NAIL & TAG WEST SIDE 6" OAK 63.81'
EAST NAIL & TAG SOUTH SIDE 15" OAK 14.66'
S 20° E NAIL & TAG EAST SIDE 8" OAK 56.62'
N 50° W NAIL & TAG NORTHEAST SIDE 8" OAK 16.74'
N 86° W MONUMENT SOUTHEAST CORNER "HURON OAKS SUBDIVISION" 2.92'

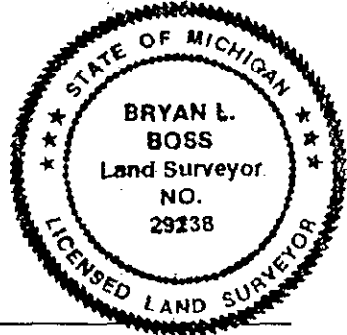

Signed by Bryan L. Boss
Surveyor's Michigan License No. 29238

Date 11-22-1996

FORM APPROVED BY MICHIGAN STATE BOARD OF LAND SURVEYORS, JAN. 28, 1971

REVISED MAY 14, 1975
REVISED JAN. 1983

PA. 345 1990, APPROVED BY LIVINGSTON COUNTY
DEED GROUP ON 7-17-96 CO. REP JED

ORD

**SUMMARY
A-7**

REV 7/16/96

Northwest corner, Section 19, T1N-R6E, Green Oak Township, Livingston County, Michigan

Found concrete monument with ¼ iron, 1 foot ± East of fence and 563.20 feet South of M-7 Hamburg Township.

Government land office notes call for 8.75 chains (577.5 feet) record from the Northwest Corner of Section 19 to the Northeast Corner of Section 24, T1N-R5E, Hamburg Township.

Clay Gordon's survey in February 1934 (page 18), found an Iron Wedge at G.L.O. distance. After a thorough search of the area (14 ± feet South of existing monument) no monumentation of any kind was found. Careful review of this survey raises a question if Clay Gordon actually measured this distance (NOTE: distances of 577.5 and 2640 are record distances and the 2640 dimension is not correct).

The Huron-Clinton Metropolitan Authority measured 563.59 feet between the Northeast Corner of said Section 24, Hamburg Township and the Northwest Corner of Section 19, Green Oak Township where they found a "Cold Cutter" and replaced with an Iron Pipe per field notes of 11/6/1950. A sketch of survey was prepared by N. E. Baldwin and dated December 1950. A copy of this sketch, on file at the HCMA offices, bear a notation that a Concrete Monument was set at this point on 8/5/1953. (Surveys in 1956, 1966 and the latest being completed by Walter S Newman in 1979). Excepting the Gordon survey, these are the only surveys that establish corner A-7.

Boss Engineering Survey (page 12) measured 563.2 feet to a found Monument.

To verify monumentation Easterly, Government Land Office notes on Page 8, call for intersection of range line at 53.84 chains (3553.44 feet) from the North ¼ Corner of Section 19. This same line was measured at 3552.0 feet by Lyle Munsell in 1960.

Therefore, using the same method to establish this corner as was used to establish A-9 (hold previous survey over the G.L.O. falling distance) we recommend setting corner on line between Hamburg Township M-7 & M-8 corners, 563.79 feet South of M-7, Hamburg (this location will be 0.20 feet South and 2.92 feet East of existing Monument).

This corner is in a fence row and wooded area. Resulting in a difficult G.P.S. Station.

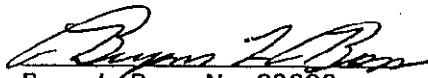
Bryan L. Boss No. 29238

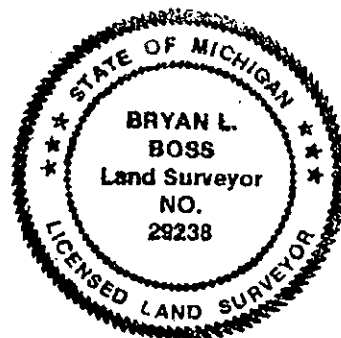

FILE: SUMMA-7A

1