

LAND CORNER RECORDATION CERTIFICATE  
Filing Requirement of Act 74, Mich. P.A. 1970

For Corners in GREEN OAK TWP.

FILED

LIVINGSTON  
(COUNTY)

Located In

Corner Code #

1. Public Land Survey

T1N R6E

A-11

T\_\_ R\_\_

T\_\_ R\_\_

T\_\_ R\_\_

2. Property Controlling  
In Section

S\_\_ T\_\_ R\_\_

S\_\_ T\_\_ R\_\_

3. Miscellaneous  
Property in Sec.

S\_\_ T\_\_ R\_\_

S\_\_ T\_\_ R\_\_

1996 DEC 19 A 11:27

NANCY HAVILAND  
REGISTER OF DEEDS  
LIVINGSTON COUNTY, MI.  
48843

L.S.C.#642m

REGISTER OF DEEDS STAMP & FILE NUMBER

4. Lot No. \_\_\_\_\_, Recorded Plat \_\_\_\_\_

5. Private Claims \_\_\_\_\_

I, BRYAN L. BOSS in a field survey on NOVEMBER 11, 1996, do hereby certify that under requirements of P.A. 74, Michigan P.A. of 1970, the corner points mentioned in lines 1 and 2 above were in conformance with regulations and rules therefore as required in the current manual of survey instructions of the United States Department of the Interior, bureau of Land Management or by a decree of a Court of Law and/or that the corner points mentioned in lines 3, 4 and 5 above were in conformance with the rules of the Michigan Board of Land Surveyors or by a Decree of a Court of Law, established, re-established, monumented, re-monumented, recovered, found as expressed below:

	A	B	C	D	E	F	G	H	I	J	K	L	M
2	6	5	4	3	2	1							
3													
4	7	8	9	10	11	12							
5													
6	18	17	16	15	14	13							
7													
8	19	20	21	22	23	24							
9													
10	30	29	28	27	26	25							
11													
12	31	32	33	34	35	36							
13													

NOTE: Not more than 4 corners, all in the same town and range, may be recorded on this certificate.

A. Description of original monument and accessories and/or subsequent restoration:

WHITE OAK 22" S 15° E .80  
WHITE OAK 18" N 56½° W .76

B. Description of corner evidence found and/or applied in restoring or reestablishing corner:

FOUND 3/8" ROD IN CONCRETE MONUMENT 1 FOOT ± ABOVE GROUND (BROKEN) AMENDED MONUMENT

N 89°43'06" W 20.63 FEET FROM AMENDED CORNER

C. Description of monument for corner and accessories established to perpetuate location the position of the corner:

AMENDED CORNER

SET CAP STAMPED AMENDED CORNER ON EXISTING MONUMENT

CLOSING CORNER

SET 1¼ X 36" PIPE WITH BRASS CAP STAMPED "LIVINGSTON COUNTY MONUMENT CORNER"

S 30° E NAIL & TAG WEST SIDE 8" APPLE 86.00'  
S 10° W NAIL & TAG WEST SIDE 6" ELM 22.39'  
WEST NAIL & TAG NORTH SIDE 3" ELM 48.30'  
NORTH SOUTHERLY EDGE OF CREEK 88'  
N 45° E SOUTHERLY EDGE OF CREEK 44'

N 06° W NAIL & TAG EAST SIDE 15" BOX ELDER 162.27  
N 35° W NAIL & TAG EAST SIDE 10" BOX ELDER 54.64'  
S 72° E NAIL & TAG NORTH SIDE 3" ELM 5.91'  
S 35° E NAIL & TAG WESTH SIDE 8" APPLE 96.74'  
S 89° 43' 06" E. 20.63 AMENDED MONUMENT

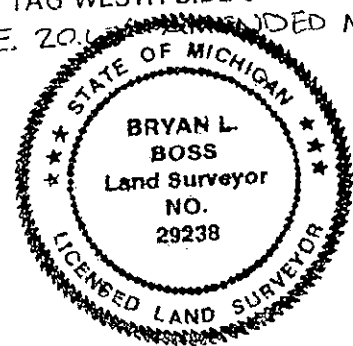

Signed by Bryan L. Boss  
Surveyor's Michigan License No. 29238

Date 12-17-1996

FORM APPROVED BY MICHIGAN STATE BOARD OF LAND SURVEYORS, JAN. 28, 1971  
REVISED MAY 14, 1975  
REVISED JAN., 1983

P.A. 345 1960, APPROVED BY LIVINGSTON COUNTY  
PEER GROUP ON 3-6-96, CO. REP JED

**SUMMARY  
A-11**

Northwest Corner, Section 31, T1N-R6E, Green Oak Township, Livingston County, Michigan

Found concrete monument 90' ± South and 40' ± West of creek.

On July 2, 1935, L.A. Smith documents measured distance of 3516.3' to North ¼ Corner of Section 31, Clay Gordon's survey in 1936 utilized Grant Dunning's measured and recorded distance of 3514.50 feet.

On November 12, 1975, Arvin Butterfield finds a 3/8" rod in 6" concrete monument and records a distance of 3530.60 feet to the North ¼ Corner of Section 31.

Subsequent surveys by Patrick L. Benton in 1979, Boss Engineering in 1987, Timothy Tietsemsa R.L.S. #20712, and Christopher Newman in 1992 all agree to existing location.

We find this existing monument 20.63 feet East of the Hamburg Township line between M-12 and M-11. We also find no evidence to justify relocating monument as found. Perhaps the peer group should reconsider the placement of M-11.

This corner is in a wooded area and not conducive for G.P.S.

We recommend accepting the concrete monument as found and utilized since 1975 as the Northwest Corner of Section 31.

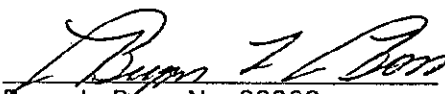
  
Bryan L. Boss No. 29238

