

1996 NOV 25 A 9:40

LAND CORNER RECORDATION CERTIFICATE
Filing Requirement of Act 74, Mich. P.A. 1970

NANCY HAVILAND
REGISTER OF DEEDS
LIVINGSTON COUNTY, MI.
48843

For Corners in GREEN OAK TWP.

LIVINGSTON (COUNTY)	Located In	Corner Code #
1. Public Land Survey	T <u>1</u> N R <u>6</u> E	<u>C-8</u>
	T ___ R ___	_____
	T ___ R ___	_____
	T ___ R ___	_____
2. Property Controlling in Section	S ___ T ___ R ___	_____
	S ___ T ___ R ___	_____
3. Miscellaneous Property in Sec.	S ___ T ___ R ___	_____
	S ___ T ___ R ___	_____
4. Lot No. _____, Recorded Plat _____		
5. Private Claims _____		

L. S. C. #619m

REGISTER OF DEEDS STAMP & FILE NUMBER

	A	B	C	D	E	F	G	H	I	J	K	L	M
2	6	5	4	3	2	1							
3													
4	7	8	9	10	11	12							
5													
6	18	17	16	15	14	13							
7													
8	19	20	21	22	23	24							
9													
10	30	29	28	27	26	25							
11													
12	31	32	33	34	35	36							
13													

I, BRYAN L. BOSS In a field survey on OCTOBER 24, 1996, do hereby certify that under requirements of P.A. 74, Michigan P.A. of 1970, the corner points mentioned in lines 1 and 2 above were in conformance with regulations and rules therefore as required in the current manual of survey instructions of the United States Department of the Interior, bureau of Land Management or by a decree of a Court of Law and/or that the corner points mentioned in lines 3, 4 and 5 above were in conformance with the rules of the Michigan Board of Land Surveyors or by a Decree of a Court of Law, established, re-established, monumented, re-monumented, recovered, found as expressed below:

NOTE: Not more than 4 corners, all in the same town and range, may be recorded on this certificate.

A. Description of original monument and accessories and/or subsequent restoration:

SET 1/2 MILE POST
WHITE OAK 20" N 14° W 2.32
WHITE OAK 19" N 27° E 2.95

B. Description of corner evidence found and/or applied in restoring or reestablishing corner:

FOUND IRON WITH DAMAGED CAP BELOW ASPHALT SURFACE
1 1/2 FEET ± EAST OF CENTERLINE RICKETT ROAD AND 4 FEET ± SOUTH OF CENTERLINE OF WINANS LAKE ROAD.

C. Description of monument for corner and accessories established to perpetuate location the position of the corner:

SET 1 1/4 X 30" PIPE WITH A BRASS CAP MARKED "LIVINGSTON COUNTY MONUMENT CORNER." IN A MONUMENT BOX.

N 30° E NAIL & TAG WEST SIDE 40" MAPLE 91.52
S 50° E NAIL & TAG NORTH SIDE 30" STUMP 38.09
SOUTH NAIL & TAG WEST SIDE 14" MAPLE 21.17
S 70° W NAIL & TAG NORTH SIDE 14" MAPLE 45.00

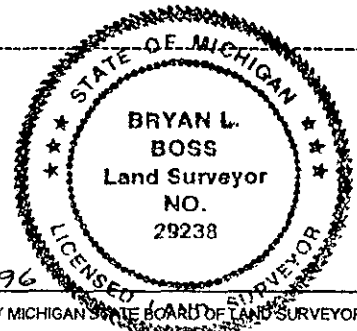

Signed by Bryan L. Boss
Surveyor's Michigan License No. 29238

Date 11-15-1996

FORM APPROVED BY MICHIGAN STATE BOARD OF LAND SURVEYORS, JAN. 28, 1971

REVISED MAY 14, 1975
REVISED JAN., 1983

**SUMMARY
C-8**

East 1/4 Corner, Section 19, T1N-R6E, Green Oak Township, Livingston County, Michigan.

Iron with damaged cap found below asphalt surface 1 ½ feet ± East of Centerline Rickett Road and 4 feet ± South of Centerline Winans Lake Road. Corner is open for G.P.S.

A 3/4" Pipe was found at Intersection and a 1/2" Capped Iron was set above this pipe by Gary Boss on February 6, 1980 (see Act 74 on page 12, this dossier).

It is apparent that Wolverine Engineers utilized same corner because measurements Northerly were 2645.27 feet (Boss Engineering) and 2645.39 feet (Wolverine Engineers). Both companies also call for Damaged Cap on 1/2" Rerod (see pages 20 & 23 this dossier), and we also find Witness South 21.19 feet checks.

We recommend accepting 1/2" Capped Iron set above a 3/4" Pipe as the East 1/4 Corner of Section 19.

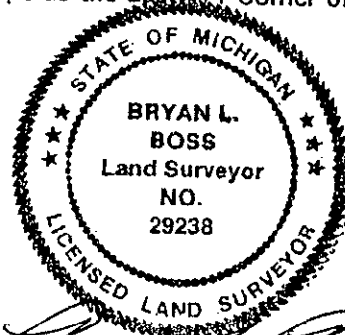

Bryan L. Boss
Bryan L. Boss No. 29238