

SURVEY & REMONUMENTATION

FEB 25 1999

FILED 9-

SECTION

LAND CORNER RECORDATION CERTIFICATE 1998 OCT 27 P 2:22
 Filing Requirement of Act 74, Mich. P.A. 1970

For corners in

Livingston (County)

Located In:

Corner Code //

NANCY HAVILAND
 REGISTER OF DEEDS
 LIVINGSTON COUNTY, MI.
 40843

- 1. Public Land Survey T 1N R 6E K-5
 T R
 T R
 T R
- 2. Property Controlling S T R
 in Section S T R
- 3. Miscellaneous S T R
 Property in Sec. S T R

LSC973M

Register of Deeds Stamp & File Number

- 4. Lot No. _____, Recorded Plat _____
- 5. Private Claims _____

I, Bryan L. Boss, in a field survey on September 28, 1998, do hereby certify that under requirements of P.A. 74, Michigan P.A. of 1970, the corner points mentioned in lines 1 and 2 above were in conformance with regulations and rules therefore as required in the current manual of survey instructions of the United States Department of the Interior, Bureau of Land Management or by a decree of a Court of Law and/or that the corner points mentioned in lines 3, 4 and 5 above were in conformance with the rules of the Michigan Board of Land Surveyors or by a Decree of a Court of Law; established, re-established, monumented, re-monumented, recovered, found as expressed below:

NOTE: Not more than 4 corners, all in the same town and range, may be recorded on this certificate.

	A	B	C	D	E	F	G	H	I	J	K	L	M
2	6	5	4	3	2	1							
3													
4	7	8	9	10	11	12							
5													
6	13	17	16	15	14	13							
7													
8	19	20	21	22	23	24							
9													
10	30	29	28	27	26	25							
11													
12	31	32	33	34	35	36							
13													

A. Description of original monument and accessories and/or subsequent restoration:

Black Oak 7" S 52 W 3 chains
 Black Oak 5" N 22 E 28 links

B. Description of corner evidence found and/or method applied in restoring or reestablishing corner:

Found 1/2' iron rod 0.70 feet East of chain link fence

PA. 345 1990, APPROVED BY LIVINGSTON COUNTY
 PEER GROUP ON 9-2-98 CO. REP JED

C. Description of monument for corner and accessories established to perpetuate locating the position of the corner:

Set 1 1/4 by 3/8" pipe with Brass cap Stamped "Livingston County Monumentation Corner"
 N 35 E 17.85 N/T Southeast side 64" Black Oak
 N 05 E 52.92 N/T Westside 18" Cherry
 West 15.86 N/T Northside 16" Black Oak
 S 30 W 26.28 N/T Norhtwest side 12" twin White Oak

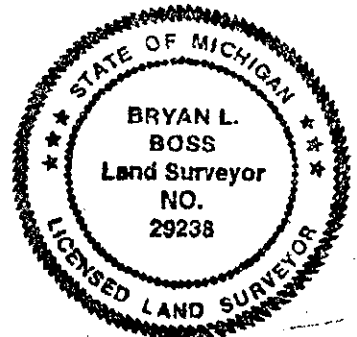

Signed by [Signature] Date 10-14-98
 Surveyor's Michigan License No. 29238