

OCT 26 1995

Oct 6 11 56 AM '95

COMMISSION LAND CORNER RECORDATION CERTIFICATE
Filing Requirement of Act 74, Mich. P.A. 1970

NANCY HAVILAND
REGISTER OF DEEDS.
LIVINGSTON COUNTY, MI
48843

For corners in

Livingston (County)	Located In:	Corner Code ##
1. Public Land Survey	T 1N R 6E	K-8
	T R	
	T R	
	T R	
2. Property Controlling in Section	S T R	
	S T R	
3. Miscellaneous Property in Sec.	S T R	
	S T R	

L.S.C. #465m

Register of Deeds Stamp & File Number

- 4. Lot No. _____, Recorded Plat _____
- 5. Private Claims _____

	A	B	C	D	E	F	G	H	I	J	K	L	M
2	6		5		4		3		2		1		
3													
4	7		8		9		10		11		12		
5													
6	16		17		16		15		14		13		
7													
8	19		20		21		22		23		24		
9													
10	30		29		28		27		26		25		
11													
12	31		32		33		34		35		36		
13													

I, Bryan Boss, in a field survey on 8-22, 19 95, do hereby certify that under requirements of P.A. 74, Michigan P.A. of 1970, the corner points mentioned in lines 1 and 2 above were in conformance with regulations and rules therefore as required in the current manual of survey instructions of the United States Department of the Interior, Bureau of Land Management or by a decree of a Court of Law and/or that the corner points mentioned in lines 3, 4 and 5 above were in conformance with the rules of the Michigan Board of Land Surveyors or by a Decree of a Court of Law; established, re-established, monumented, re-monumented, recovered, found as expressed below:

NOTE: Not more than 4 corners, all in the same town and range, may be recorded on this certificate.

A. Description of original monument and accessories and/or subsequent restoration:

- White Oak 13" S 41° E 98 links
- White Oak 20" N 40½ W 1.30
- White Oak N 78 E .20½

B. Description of corner evidence found and/or method applied in restoring or reestablishing corner:

- Spike found in 3/4" inch pipe ½ foot below surface four feet West of Centerline Peer Road.
- 1" iron pipe raised with boat spike
- power pole N 12° W 119.3'
- 24" Oak S 86° W 97.9'
- power pole S 6° W 29.00'
- 3/4" iron pipe Westerly 33.0'

C. Description of monument for corner and accessories established to perpetuate locating the position of the corner:

- Set brass cap in 30" pipe 6" inches below grade with additional 6" breakaway.
- 159.15' S 30° W nail & tag West side power pole
- 151.32' S 5° W nail & tag West side power pole
- 97.56' East nail & tag South side 40" Oak
- 119.54' N 10° W nail & tag South side power pole

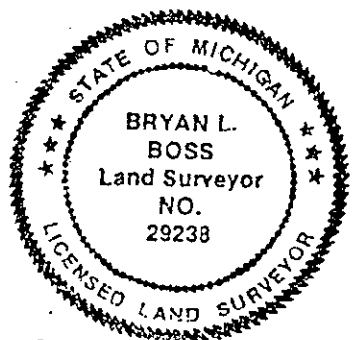

Signed by Bryan L. Boss Date OCT. 4, 1995
 Surveyor's Michigan License No. 29238

SUMMARY
K-8

West 1/4 Corner, Section 24, T1N-R6E, Green Oak Township,
Livingston County, Michigan.

Found spike in 3/4" I.D. Pipe 1/2 foot \pm below gravel
surface and 4 feet \pm west of centerline of Peer Road. This
corner is open for G.P.S. There is no evidence of other
corners.

This corner was set by Atwell-Hicks on November 19, 1952
(see pages 11 thru 14). Note witness on field notes Page 11.
A 24" B. Oak west 97.9 feet coincides with Washtenaw
Engineering witness S 86° W 97.9 feet 24" Oak on page 7 of
this dossier. There may be some confusion on witnesses
documented by Norman Fahrner's Act 74's and Washtenaw
Engineering surveys, but all evidence points to 1" iron pipe
raised with boat spike as the west 1/4 of Section 24.

Conclusion:

We find the boat spike set by Norman Fahrner in the 1" pipe
which was set by Atwell-Hicks to be the west 1/4 corner of
said Section 24 and recommend its approval.

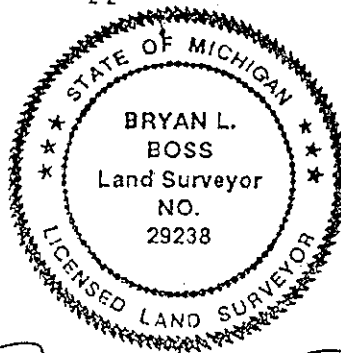

Bryan L. Boss

GOK-8S