

OCT 26 1995

COMMISSION

LAND CORNER RECORDATION CERTIFICATE
Filing Requirement of Act 74, Mich. P.A. 1970

For corners in
Livingston

(County)

Located In:

Corner Code #

1. Public Land Survey	T	1N	R	6E	K-9
	T		R		
	T		R		
	T		R		
2. Property Controlling in Section	S		T	R	
	S		T	R	
3. Miscellaneous Property in Sec.	S		T	R	
	S		T	R	

OCT 6 11 56 AM '95
 FILED
 HARRY HAYLAND
 REGISTER OF DEEDS
 LIVINGSTON COUNTY, MI
 48843

L.S.C. #466m

Register of Deeds Stamp & File Number

4. Lot No. _____, Recorded Plat _____
 5. Private Claims _____

I, Bryan Boss, in a field survey on 8-23, 1995, do hereby certify that under requirements of P.A. 74, Michigan P.A. of 1970, the corner points mentioned in lines 1 and 2 above were in conformance with regulations and rules therefore as required in the current manual of survey instructions of the United States Department of the Interior, Bureau of Land Management or by a decree of a Court of Law and/or that the corner points mentioned in lines 3, 4 and 5 above were in conformance with the rules of the Michigan Board of Land Surveyors or by a Decree of a Court of Law; established, re-established, monumented, re-monumented, recovered, found as expressed below:

NOTE: Not more than 4 corners, all in the same town and range, may be recorded on this certificate.

A. Description of original monument and accessories and/or subsequent restoration:

- White Oak 10" S 46° E 1.98 chains
- White Oak 18" N 1° E 2.06 chains

B. Description of corner evidence found and/or method applied in restoring or reestablishing corner:

Found 3/4" iron pipe two feet south of centerline Ten Mile Road and three feet west of centerline Peer Road
 S 40° E 28.4' tag #21566 West side power pole
 N 50° E 70.4' Southwest corner Michigan Bell pad
 N 10° W 130.0' tag #21566 east side power pole
 N 60° W 44.5' P.K. nail in top/curb

C. Description of monument for corner and accessories established to perpetuate locating the position of the corner:

- Set brass cap on 1/2" iron in monument box
- 44.52' N 45° E to P.K. in curb
- 28.46' S 45° E nail & tag north side power pole
- 46.50' N 75° W to P.K. in curb
- 133.30' N 30° W nail & tag east side power pole

A	B	C	D	E	F	G	H	I	J	K	L	M
2	6	5	4	3	2	1						
3												
4	7	8	9	10	11	12						
5												
6	13	17	16	15	14	13						
7												
8	19	20	21	22	23	24						
9												
10	30	29	28	27	26	25						
11												
12	31	32	33	34	35	36						
13												

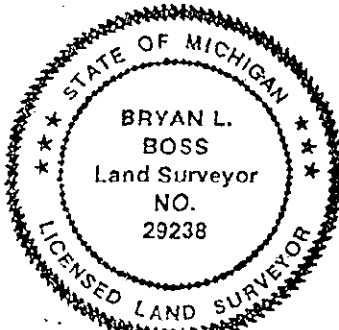

Surveyed by Bryan L. Boss

Date Oct. 4, 1995

Surveyor's Michigan License No. 29238

SUMMARY
K-9

Northwest corner of Section 25, T1N-R6E, Green Oak Township,
Livingston County, Michigan.

Found 3/4" O.D. pipe at surface of asphalt two feet \pm south
of centerline Ten Mile Road and three feet \pm west of
centerline of Peer Road. Clean sweep of area found no
evidence of other corners. Intersection is open for G.P.S.
This corner was set on 11-19-1952 by Atwell-Hicks Inc. See
field notes on page 13 of this dossier.

Subsequent distances measured by others confirm a close
tolerance (see page 6). The original witnesses, which have
been copied by others, have all been destroyed. New
witnesses were set by Huston Kennedy and used by Defenderfer
in 1992 and again by Hughes in 1993.

Conclusion: 3/4"
We find the ~~1/4~~" x 24" pipe set in 1952 is the same as found
by others to this date, and recommend its acceptance.

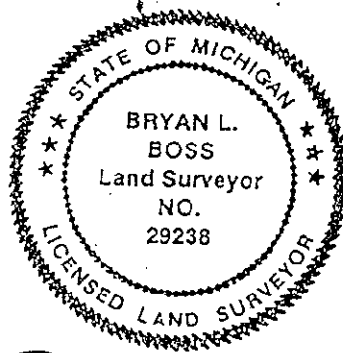

Bryan L. Boss

GOK-9S