

**LAND CORNER RECORDATION CERTIFICATE**  
**Filing Requirement of Act 74, Mich. P.A. 1970**

For corners in

Livingston  
 (County)

Located In:

Corner Code ≠#

1. Public Land Survey	T <u>IN</u> R <u>6E</u>	<u>L-13</u>
	T _____ R _____	_____
	T _____ R _____	_____
	T _____ R _____	_____
2. Property Controlling in Section	S _____ T _____ R _____	_____
	S _____ T _____ R _____	_____
3. Miscellaneous Property in Sec.	S _____ T _____ R _____	_____
	S _____ T _____ R _____	_____

NANCY HAVILLAND  
 REGISTER OF DEEDS  
 LIVINGSTON COUNTY, MI  
 48843

DEC 27 11 24 AM '93

FILED

L.S.C.# 106m

Register of Deeds Stamp & File Number

4. Lot No. \_\_\_\_\_, Recorded Plat \_\_\_\_\_
5. Private Claims \_\_\_\_\_

	A	B	C	D	E	F	G	H	I	J	K	L	M
2	6		5		4		3		2		1		
3													
4	7		8		9		10		11		12		
5													
6	18		17		16		15		14		13		
7													
8	19		20		21		22		23		24		
9													
10	30		29		28		27		26		25		
11													
12	31		32		33		34		35		36		
13													

I, H. Lawrence O'Donnell, a field surveyor on December 20, 19 93, do hereby certify that under requirements of P.A. 74, Michigan P.A. of 1970, the corner points mentioned in lines 1 and 2 above were in conformance with regulations and rules therefore as required in the current manual of survey instructions of the United States Department of the Interior, Bureau of Land Management or by a decree of a Court of Law and/or that the corner points mentioned in lines 3, 4 and 5 above were in conformance with the rules of the Michigan Board of Land Surveyors or by a Decree of a Court of Law; established, re-established, monumented, re-monumented, recovered, found as expressed below:

**NOTE: Not more than 4 corners, all in the same town and range, may be recorded on this certificate.**

A. Description of original monument and accessories and/or subsequent restoration:

GLO Survey November 1815 by Joseph Wampler  
 Set qr. post  
 W. Oak 18 N6W 16 lks  
 R. Oak 18 S8W 45 lks

(Additional historical data on back of sheet)

B. Description of corner evidence found and/or method applied in restoring or reestablishing corner:

Found 3/4" Iron Pipe

LCS #832 by C. Garlock references 2 witnesses as established by Atwell-Hicks in 1957. LCS #560 by C. Wilson references 3 witnesses as established by Atwell-Hicks in 1957 including the N 1/4 corner Sec. 1, T1S, R6E

C. Description of monument for corner and accessories established to perpetuate locating the position of the corner:

Set 1 1/4" x 42" breakway Iron Pipe with Brass Cap  
 6" below grade of road

14" Hickory N02°W 34.00' nail w/flasher  
 24" Walnut S75°E 60.68' nail w/flasher  
 14" Ash S50°E 34.20' nail w/flasher  
 10" Walnut S40°W 52.06' nail w/flasher

N 1/4 Corner Sec. 1, T1S, R6E West 134.43'

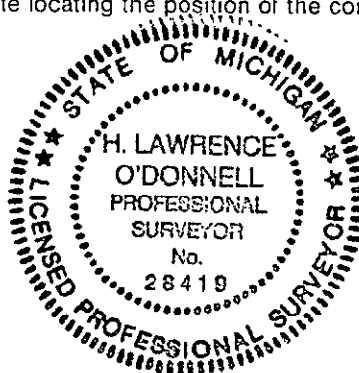

Signed by H. Lawrence O'Donnell  
 Surveyor's Michigan License No. 28419

Date December 22, 1993

Approved by Livingston County Monumentation Peer Group October 30, 1993

Civil Engineering • Surveying  
Planning • Environmental Services

# A T W E L L - H I C K S , I N C .

540 Avis Drive  
P.O. Box 2981  
Ann Arbor, Michigan 48106  
313 994 4000 • FAX: 313 994 1599

## RESEARCH SUMMARY

L-13, S-1/4 Corner Section 36, T1N, R6E  
Found a 3/4" Iron pipe at the S-1/4 corner location.

Corner referenced in 1957 survey by Atwell-Hicks, Inc.; 1972 PA 74 by C. Garlock; 1971 survey by Geo. Kattouah; 1972 survey and PA 74 by C. Wilson; 1973 survey by C. Garlock; 1978 3 surveys by C. Garlock; 1973 survey by Geo. Kattouah; 1980 survey by W.E. Co.; 1969 survey by Munsell & Garlock.

A search of the area found no other irons. An iron marking the N 1/4 Corner Section 1, T1S, R6E was found 134.66 ft. West as reported in a 1957 survey by Atwell-Hicks, Inc.

I conclude that the iron found marks the S 1/4 corner Section 36.



Mary A. Borkowski, RLA • William C. Henderson • Robert J. Jagow Jr., PE, PS • Robert G. Macomber, PE, PS  
John L. Snyder, PE, PS • Allen R. Suggitt, PE • Richard G. Timmons, PE, PS