

FEB 24 1998

9-

SECTION

LAND CORNER RECORDATION CERTIFICATE
Filing Requirement of Act 74, Mich. P.A. 1970

FILED

For corners in

LIVINGSTON
(County)

Located In:
GREEN OAK TWP.

Corner Code //

1997 NOV 25 A 11: 13

NANCY HAVILAND
REGISTER OF DEEDS
LIVINGSTON COUNTY, MI.
48843

L.S.C. #823m

Register of Deeds Stamp & File Number

- 1. Public Land Survey T IN R 6E M-2
 T R
- T R
- I R
- 2. Property Controlling S T R
in Section S T R
- 3. Miscellaneous S T R
Property in Sec. S T R

- 4. Lot No. _____, Recorded Plat _____
- 5. Private Claims _____

	A	B	C	D	E	F	G	H	I	J	K	L	M
2	6		5		4		3		2				
3													
4	7		8		9		10		11		12		
5													
6	18		17		16		15		14		13		
7													
8	19		20		21		22		23		24		
9													
10	30		29		28		27		26		25		
11													
12	31		32		33		34		35		36		
13													

I, BRYAN L. BOSS, in a field survey on NOVEMBER 5, 19 97, do hereby certify that under requirements of P.A. 74, Michigan P.A. of 1970, the corner points mentioned in lines 1 and 2 above were in conformance with regulations and rules therofore as required in the current manual of survey instructions of the United States Department of the Interior, Bureau of Land Management or by a decree of a Court of Law and/or that the corner points mentioned in lines 3, 4 and 5 above were in conformance with the rules of the Michigan Board of Land Surveyors or by a Decree of a Court of Law; established, re-established, monumented, re-monumented, recovered, found as expressed below:

NOTE: Not more than 4 corners, all in the same town and range, may be recorded on this certificate.

A. Description of original monument and accessories and/or subsequent restoration:

WHITE OAK 16" S 31 E 67 LINKS
WHITE OAK 12" N 72 W 1.05 CHAINS

B. Description of corner evidence found and/or method applied in restoring or reestablishing corner:

CORNER OBLITERATED.
SPLIT DISTANCE BETWEEN M-3 AND M-1 (5305.60 FEET)
2652.80' / 2652.80'
SET MONUMENT 315.06 FEET NORTH OF A-2 LYON TOWNSHIP
AND 6.17 FEET EAST OF STRAIGHT LINE BETWEEN M-1 & M-3.

C. Description of monument for corner and accessories established to perpetuate locating the position of the corner:

SET 1 1/4" X 30" PIPE WITH A 6" BREAK OFF & BRASS CAP STAMPED "LIVINGSTON COUNTY MONUMENTATION CORNER". IN A MONUMENT BOX 3 FEET ± SOUTH OF CENTERLINE ISLAND LAKE RECREATION AREA ACCESS ROAD.
N 14° W 136.91' NAIL & TAG EAST SIDE 12" MAPLE
S 76° E 40.15' NAIL & TAG NORTH SIDE 10" OAK
S 43° W 49.10' NAIL & TAG NORTHWEST SIDE 14" MAPLE
N 85° W 79.74' NAIL & TAG NORTH SIDE 28" OAK

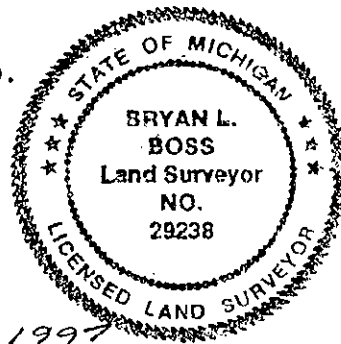

Signed by Bryan L. Boss Date NOV. 11, 1997

Surveyor's Michigan License No. 29238

Approved July 12, 2011

SUMMARY
M-2

East 1/4 Corner, Section 1, Green Oak Township, Livingston County, Michigan.

Corner set by Alex Holmes in 1816. G.L.O. Field notes record post set 40.0 chains south of Northeast corner Section 1, Green Oak Township. In June 1936, Clay Gordon surveyed 150.84 acres of part of N.E. fractional 1/4 and part of S.E. Corner of Section 7, The GLO notes (pg 3) show 1699.5 feet to the center of the Huron River. Clay Gordon records 1688.4 feet.

An iron was set at 2744.4 feet (Boss 2739.04) south of said N.E. Corner Section 1, and Clay Gordon then measured 695 feet (Boss 693.27) to a fence corner.

In June, 1955, Omar McNutt survey measured from S.E. Corner of Section 1 Northerly to the West 1/4 Corner of Section 6, Lyon Township but does not reference to M-2, East 1/4 Corner, Section 1. These measurements and points match Postiff survey(pg.15)

In that same year, the Michigan Department of Transportation highway plans (pg. 16) records 2972.71 feet from NE Cor Sec. 1 to E 1/4 Cor Sec. 1 (This is only survey reference to M-2 in dossier. Boss measures (2967.86) from NE Cor. Sec. 1, to the West 1/4 corner, Section 6, Lyon Township (A-2)

In November 1969, Postiff Company measured 2338.09(Boss 2337.79) from the S.E. Corner Section 1, to the West 1/4 corner of Section 6, Lyon Township.

The Gordon , McNutt, and Postiff Surveys agree. Most of the points along the Section Line were found by Boss and the measurements agree with these surveys.

M-2 does not appear on any surveys we were able to obtain excepting the MDOT survey, . No property corners in this area appear to use this corner to control or establish property lines.

Boss used GPS to complete this survey, the area is open.

M-2 is in a grassy area between an asphalt parking lot and the asphalt entrance Road in the Island Lake Rec. Area. The entire area was searched, however this entire area was changed from its natural state to construct the Road and Parking area.

RECOMMENDATION

We recommend splitting the distance between M-3 and M-1 (5305.60) (2652.80 and 2652.80). The Holmes' GLO notes (pg. 3) show the 1/4 Post was set at the split.

We would also recommend that the line from M-3 be extended through the established and recognized A-2 Lyon Twp. to the split distance of 2652.80 feet. Using this method will place all of the points found on the previous surveys to remain on the established Section Line.

This point will be 315.06 feet (GLO 287.76) North of A-2 Lyon and 6.17 feet East of the straight line between M-1 and M-3.

The Island Lake Rec Area surrounds this Corner (N-S-E-W)

File: Summ-2 (rev. 7-97)

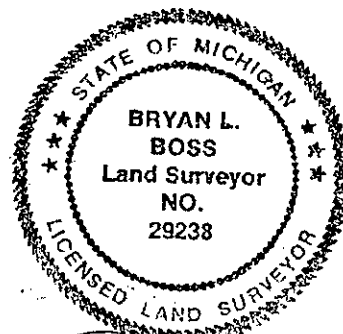

Bryan L. Boss