

SURVEY & REMONUMENTATION

FEB 24 1998

FILED

SECTION

LAND CORNER RECORDATION CERTIFICATE
 Filing Requirement of Act 74, Mich. P.A. 1970

1997 NOV 25 A 11: 13

NANCY HAVILAND
 REGISTER OF DEEDS
 LIVINGSTON COUNTY, MI.
 48843

For corners in

<u>LIVINGSTON</u> <small>(County)</small>	Located In: GREEN OAK TWP.	Corner Code #/
Public Land Survey	T <u>1N</u> R <u>6E</u>	<u>M-4</u>
	T _____ R _____	_____
	T _____ R _____	_____
	T _____ R _____	_____
Property Controlling in Section	S _____ T _____ R _____	_____
Miscellaneous Property in Sec.	S _____ T _____ R _____	_____

L.S.C. #825m

Register of Deeds Stamp & File Number

Lot No. _____, Recorded Plat _____
 Private Claims _____

	A	B	C	D	E	F	G	H	I	J	K	L	M
2	0	5	4	3	2								
3													
4	7	8	9	10	11	12							
5													
6	18	17	16	15	14	13							
7													
8	19	20	21	22	23	24							
9													
10	30	29	28	27	26	25							
11													
12	31	32	33	34	35	36							
13													

BRYAN L. BOSS, in a field survey on SEPTEMBER 9, 1997,
 hereby certify that under requirements of P.A. 74, Michigan P.A. of 1970, the corner points mentioned in lines 1 and 2 above were in conformance with regulations and rules therefore as required in the current manual of survey instructions of the United States Department of the Interior, Bureau of Land Management or by a decree of a Court of Law and/or that the corner points mentioned in lines 3, 4 and 5 above were in conformance with the rules of the Michigan Board of Land Surveyors or by a Decree of a Court of Law; established, re-established, monumented, re-monumented, recovered, found as expressed below:

NOTE: Not more than 4 corners, all in the same town and range, may be recorded on this certificate.

Description of original monument and accessories and/or subsequent restoration:

WHITE OAK 12" WEST 95 LINKS 62.7 FEET
 WHITE OAK 14" N 12 W 51 LINKS 33.66 FEET

Description of corner evidence found and/or method applied in restoring or reestablishing corner:

FOUND SQUARE BOAT SPIKE 1/2 FOOT BELOW GRAVEL SURFACE.
 (DIXBORO ROAD).

Description of monument for corner and accessories established to perpetuate locating the position of the corner:

SET 1 1/4" X 30" IRON PIPE ONE FOOT BELOW GRAVEL SURFACE WITH 6" BREAKAWAY & BRASS CAP STAMPED LIVINGSTON COUNTY MONUMENTATION CORNER.
 N 20° E 65.64' NAIL & TAG EAST SIDE 30" BOX ELDER
 S 75° W 24.73' CENTER OF STREET SIGN
 N 40° W 90.04' NAIL & TAG NORTHEAST SIDE UTILITY POLE
 N 12° W 97.97' NAIL & TAG EAST SIDE 30" STUMP
 S 15° W 237.60' NAIL & TAG EAST SIDE 36" OAK

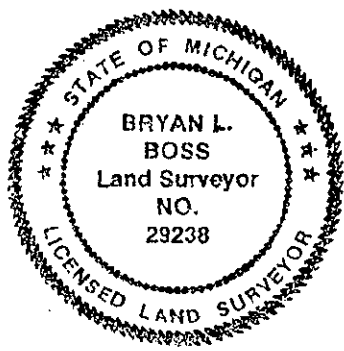

Signed by Bryan L. Boss Date Sept. 22, 1997
 Surveyor's Michigan License No. 29238

FORM APPROVED BY MICHIGAN STATE BOARD OF LAND SURVEYORS, JAN. 28, 1971
 REVISED MAY 14, 1975
 REVISED JAN., 1983

P.A. 345 1980, APPROVED BY LIVINGSTON COUNTY
 OFFER GROUP ON 6-18-97 CO REP JED

SUMMARY

M-4

East 1/4 Corner, Section 12, Green Oak Township, Livingston County, Michigan.

Alex Holmes set post in a wet place in 1816 (See G.L.O. Notes).

1889 county surveyor field notes log stake, large stone, crockery & brick were set by I.T. before Grant Dunning in 1920.

In June of 1955, Omar E. McNutt survey records jog of 248.6 feet between A-3 and M-3, but does not record distance to or jog at A-4 and M-4.

On July 7, 1964, Wynn Wakenhut P.S. #8897 set 3/4" rod at East 1/4 Corner on fence line extended from the West. He also set 5/8" iron 11.79 feet S 67°51'45" W from found railroad spike in centerline of Silver Lake Road.

In 1969, Washtenaw Engineering found iron pipes at the East 1/4 Corner of Section 12, Green Oak Township, and West 1/4 Corner of Section 7, Lyon Township. The township jog measured 223.44 feet G.L.O. Notes record 239.58 feet.

1972 survey by Tredinnick shows the two jog irons set by Wakenhut in the Centerline of Silver Lake Road, however he did not show or use the M-4 as set by Wakenhut.

1988 plat by Ash uses the point set by Wakenhut, and the distance to M-3 measures the same as Wakenhut also.

In 1997, Boss Engineering found Square Boat Spike 0.4 tenths below gravel surface (Dixboro Road). This point is the same as used by Wakenhut, Washtenaw, Munzel and Ash based on exiting witnesses and the distances to the North (M-3, and the iron in Silver Lake Road,) and distances to the the South (M-5, and A-5)

WITNESSES:

Act 74 by Munzel in 1978 is same point as used by all previos surveys based on witnesses.

1889 County Surveyor - Oak 14" N 12°20' W 51 LKS (33.66 ft)
1964 Wakenhut NW 98.02 Nail NE/S tree
1978 Herbert Munzel Oak 30" N 13° W 98.4 feet
1997 Boss Engineering 30" stump N 12° W 97.82
found 3/4" square boat spike in centerline Dixboro Road Old
Fence occupation to west.

This corner if in centerline of Dixboro Road and open for G.P.S.

RECOMMENDATION

We find occupation to the West viable evidence to perpetuate original monument, and that all surveys and witnesses in area use this as the only point for M-4. Therefore, we and recommend acceptance as found.

Summ-4

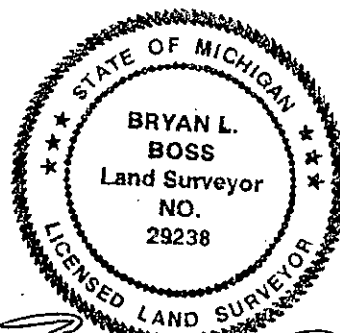

Bryan L. Boss