

SURVEY & REMONUMENTATION

FEB 24 1998

9/

FILED

SECTION

LAND CORNER RECORDATION CERTIFICATE
Filing Requirement of Act 74, Mich. P.A. 1970

For corners in

<u>LIVINGSTON</u> (County)	Located In: GREEN OAK TWP.	Corner Code: //
1. Public Land Survey	T <u>1N</u> R <u>6E</u>	<u>M-5</u>
	T _____ R _____	_____
	T _____ R _____	_____
	T _____ R _____	_____
2. Property Controlling in Section	S _____ T _____ R _____	_____
	S _____ T _____ R _____	_____
3. Miscellaneous Property in Sec.	S _____ T _____ R _____	_____
	S _____ T _____ R _____	_____

1997 DEC -5 A 11:42

NANCY HAVILAND
REGISTER OF DEEDS
LIVINGSTON COUNTY, MI.
48843

L.S.C. #829m

Register of Deeds Stamp & File Number

4. Lot No. _____, Recorded Plat _____
5. Private Claims _____

A	B	C	D	E	F	G	H	I	J	K	L	M
2	6	5	4	3	2	1						
3												
4	7	8	9	10	11	12						
5												
6	18	17	16	15	14	13						
7												
8	19	20	21	22	23	24						
9												
10	30	29	28	27	26	25						
11												
12	31	32	33	34	35	36						
13												

I, BRYAN L. BOSS, in a field survey on SEPTEMBER 19, 1997, do hereby certify that under requirements of P.A. 74, Michigan P.A. of 1970, the corner points mentioned in lines 1 and 2 above were in conformance with regulations and rules therefore as required in the current manual of survey instructions of the United States Department of the Interior, Bureau of Land Management or by a decree of a Court of Law and/or that the corner points mentioned in lines 3, 4 and 5 above were in conformance with the rules of the Michigan Board of Land Surveyors or by a Decree of a Court of Law; established, re-established, monumented, re-monumented, recovered, found as expressed below:

NOTE: Not more than 4 corners, all in the same town and range, may be recorded on this certificate.

A. Description of original monument and accessories and/or subsequent restoration:

- BLACK OAK 12" S 76 E 98 LINKS
- WHITE OAK 12" S 53 W 4 LINKS
- YELLOW OAK 14" S 39 E 53 LINKS
- YELLOW OAK 18" S 53 W 71 1/2 LINKS

THIS CORNER IS MARKED STAKE, PLOW POINT, MONKEY WRENCH, BRICK & CROCKERY.

B. Description of corner evidence found and/or method applied in restoring or reestablishing corner:

TWO POINTS HAVE BEEN LABLED & ESTABLISHED AS M-5
SOUTHERLY POINT: 1 1/2" X 6" PIPE RMOVED AND 1 1/4" X 30" PIPE SET ONE FOOT BELOW GRAVEL SURFACE WITH 1" X 6" BREAKAWAY & BRASS CAP STAMPED LIVINGSTON COUNTY MONUMENTATION CORNER.
NORTHERLY POINT: 15.32 FEET NORTH FOUND 3/4" PIPE IN CENTERLINE DIXBORO ROAD ON LINE WITH FENCE LINE WEST, HOWEVER THIS FENCE IS 16.5 FEET NORTH OF MATURE TREE ROW & FENCELINE.

C. Description of monument for corner and accessories established to perpetuate locating the position of the corner:

- SET 1 1/4" X 30" PIPE WITH BRASS CAP STAMPED "LIVINGSTON COUNTY MONUMENTATION CORNER".
- WEST 40.53' NAIL & TAG NORTH SIDE 42" OAK
- N 45 E 22.82' NAIL & TAG SOUTH SIDE 18" CHERRY
- S 40 E 39.55' NAIL & TAG WEST SIDE 26" CHERRY
- N 20 W 74.00' NAIL & TAG EAST SIDE 10" OAK

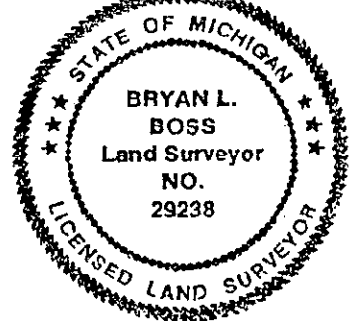

Signed by Bryan L. Boss
Surveyor's Michigan License No. 29238

Date Sept. 25, 1997

P.A. 345 1990, APPROVED BY LIVINGSTON COUNTY
PEER GROUP ON 7-16-97 CO. REP JEP

SUMMARY

M-5

Northeast Corner, Section 13, Green Oak Township, Livingston County, Michigan.

Original corner set by Alex Holmes in 1816.

1889 County Survey Records log N.E. Corner, Section 13, marked by stake, plow point, monkey wrench, brick and crockery.

M-5 is in center of Gravel Road and open for G.P.S. The point is in a 5 ft deep cut section of the road so no original point is recoverable.

There are 2 points that have been used as M-5, and they are 15.32 apart(north and South)

SOUTHERLY POINT

In 1969, Washtenaw Engineering found iron pipe at S.E. Corner, Section 12, and measured southerly 200.18 feet to S.W. Corner, Section 7, Lyon Township.

This corner was also found by James Potts on May 11, 1989, and Munzel Engineering on July 19, 1995 during resurveys of the original Washtenaw survey of 1969. . All three of these surveys are in Lyon Twp. and do not use this Corner to control surveys in Green Oak Twp.

On June 11, 1997 Boss Eng. found a 1 1/2" x 6" long Pipe at this location, this point was removed and a through search was made for further evidence, none found. A 1/2" iron was placed and witnessed. This point is on line with a mature tree row and fence line to the West.(NOTE: there is an additional fence line one rod North of this tree row.

Distances M-4(2662.78) M-6(2665.29) A-3(200.18)

NORTHERLY POINT

On March 24, 1972, Douglas Tredinnick records act 74. He set a 3/4" iron pipe in centerline of Dixboro Road by establishing a straight line from M-6 to M-3 and setting it at the occupation line to the west.(see pg. 13 and 13A)

In June of 1997 Boss confirms these measurements. This point is on line with fence line to the West, however this fence is the North fence of a one rod wide lane. The mature tree row and a fence line is South 16.5 feet.

Subsequent surveys by Tredinnick and Kattouah in 1972 use this point to parcel the S 1/2 of the SE 1/4 of Sec. 12.

Plat by Greg Ash in 1988 of the N 1/2 of the SE 1/4 of Sec. 12 uses this point.

Boss survey in 1990 of the NE 1/4 of Sec. 13 uses this point.

Distances M-4(2647.46) M-6(2680.61) A-3(215.5)

WITNESSES:

Note 18" oak s 53° W 71 1/2 links (47.19 ft) Witness by Teller in 1889.

38" maple S 65°16' W 45.00 feet by Tredinnick in 1972.

42" oak S 70° W 44.12 feet by Boss Engineering in 1997.

SUMMARY

There are two points that have been labeled and established as M-5.

1) The Tredinnick Cor. has been used by all surveys in this dossier that are in Green Oak Twp. Distances North to M-4 and South to M-6 check with these surveys and the Plat of record.

2) The Southerly point is 200.18 feet North of the well established point at A-5 Lyon Twp. and is 15.32 feet South of the Corner set by Tredinnick. No surveys in Green Oak Twp. appear to have used this Cor.

RECOMMENDATION

We recommend using the Southerly-most Corner, based on Tredinneck's earliest evidence.

Summ-5 (REV. 7/97)



Bryan L. Boss