

OCT 26 1995

COMMISSION

LAND CORNER RECORDATION CERTIFICATE
Filing Requirement of Act 74, Mich. P.A. 1970

FILED
OCT 6 11 52 AM 1995
NANCY HAVILAND
REGISTER OF DEEDS
LIVINGSTON COUNTY, MI

For corners in Livingston (County)

Located In: Corner Code ##

Public Land Survey	T 1N R 6E	M-10
Property Controlling in Section	S T R	
Miscellaneous Property in Sec.	S T R	

L.S.C. #471m

Register of Deeds Stamp & File Number

Lot No. _____, Recorded Plat _____

Private Claims _____

Bryan Boss in a field survey on 8-22 1995

I hereby certify that under requirements of P.A. 74, Michigan P.A. of 1970, the corner points mentioned in lines 1 and 2 above were in conformance with regulations and rules therefore as required in the current manual of survey instructions of the United States Department of the Interior, Bureau of Land Management or by a decree of a Court of Law and/or that the corner points mentioned in lines 3, 4 and 5 above were in conformance with the rules of the Michigan Board of Land Surveyors or by a Decree of a Court of Law; established, re-established, monumented, re-monumented, recovered, found as expressed below:

NOTE: Not more than 4 corners, all in the same town and range, may be recorded on this certificate.

- Description of original monument and accessories and/or subsequent restoration:
Black Oak 12" N 62° W 19 links
White Oak 16" S 54° W 47 links
Elm 12" S 21¼ W 1.62 chains

	A	B	C	D	E	F	G	H	I	J	K	L	M
2	6		5		4		3		2		1		
3													
4	7		8		9		10		11		12		
5													
6	18		17		16		15		14		13		
7													
8	19		20		21		22		23		24		
9													
10	30		29		28		27		26		25		
11													
12	31		32		33		34		35		36		
13													

- Description of corner evidence found and/or method applied in restoring or reestablishing corner:
Found capped rod one foot below surface
five feet ± west of centerline Dixboro Road
and eight feet ± north of occupied fence line westerly.
½" RAW iron west 32.9 feet
4" Ø monument south 57.02 feet
Power pole S 20° E 95.1 feet to P.K. nail in N.N.E face
18" Cherry northwesterly 34.2 feet to 20° SPK in northeast side

Description of monument for corner and accessories established to perpetuate locating the position of the corner:

- Set brass cap in 30" pipe 8" below surface
67.87' S 30° E to corner fence post
95.12' S 15° E nail & tag northside power pole
56.62' south to ½" iron
32.57' west to 1" pipe

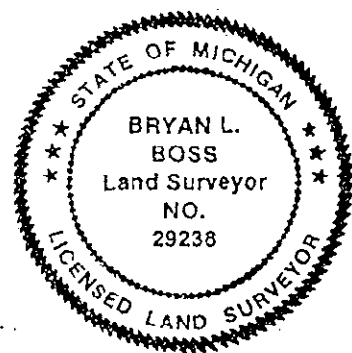

Signed by Bryan L. Boss Date OCT 4, 1995
Surveyor's Michigan License No. 29238

SUMMARY

M-10

EAST $\frac{1}{4}$ CORNER, SECTION 25, TIN-R6E, GREEN OAK TOWNSHIP, LIVINGSTON COUNTY, MICHIGAN

Found an iron rod with a damaged cap one foot \pm below gravel surface and five (5) feet \pm West of centerline Dixboro Road. Location is also Eight (8) feet \pm North of fence line Westerly. This corner is open for G.P.S.

In 1879, Miles Bullock calls for 2662.90 feet for split of East line Section 25. Recent surveys call for 2661 feet $\frac{1}{4}$ for split. Washtenaw Engineering survey on 3-3-69 notes fence Westerly is 8.5 feet South of East & West $\frac{1}{4}$ line. On 1-13-95 Boss Engineering field notes designate same fence line 8.4 feet South of East $\frac{1}{4}$ corner.

Jog Southerly to West $\frac{1}{4}$ corner of Section 19, Lyon Township, measured within 0.40 feet by three (3) surveyors.

Conclusion:

The 1" iron pipe set by Washtenaw Engineering on 3-3-69, which was found and reset with a 3/4" x 18" pipe on 8-30-78 by Arvin Butterfield and found again on 1-3-90 by Greg L. Ash L.S #28400 of Dietrich, Bailey & Associates of Plymouth, Michigan, who set a capped iron, is the same point as found by Boss Engineering on 1-13-95. Therefore, we recommend it's approval as the East $\frac{1}{4}$ Corner of Section 25.

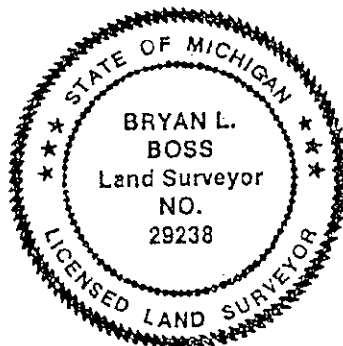

Bryan L. Boss