

LAND CORNER RECORDATION CERTIFICATE
Filing Requirement of Act 74, Mich. P.A. 1970

For corners in

Livingston (County) Located In: Corner Code ##

- 1. Public Land Survey T 1N R 6E M-11
- T R
- T R
- T R
- 2. Property Controlling S T R
- in Section S T R
- 3. Miscellaneous S T R
- Property in Sec. S T R

- 4. Lot No. , Recorded Plat
- 5. Private Claims

DEC 27 11 14 AM '93
 NANCY HAYLAND
 REGISTER OF DEEDS
 LIVINGSTON COUNTY, MI
 48843

FILED

L.S.C.# 107m
Register of Deeds Stamp & File Number

I, H. Lawrence O'Donnell survey on December 20, 1993, do hereby certify that under requirements of P.A. 74, Michigan P.A. of 1970, the corner points mentioned in lines 1 and 2 above were in conformance with regulations and rules therefore as required in the current manual of survey instructions of the United States Department of the Interior, Bureau of Land Management or by a decree of a Court of Law and/or that the corner points mentioned in lines 3, 4 and 5 above were in conformance with the rules of the Michigan Board of Land Surveyors or by a Decree of a Court of Law; established, re-established, monumented, re-monumented, recovered, found as expressed below:

NOTE: Not more than 4 corners, all in the same town and range, may be recorded on this certificate.

A. Description of original monument and accessories and/or subsequent restoration:

GLO survey November 1815 by Joseph Wampler set post in swamp for 25 & 36 Tamarack 16 North 154 lks Tamarack 16 North 84 lks (Additional historical data on back of sheet)

B. Description of corner evidence found and/or method applied in restoring or reestablishing corner:

Found 1" iron pipe in monument box. Iron pipe set in March 1957 by Atwell-Hicks. LCS #557 by C. Wilson in December 1972. LCS #1117 by A. Butterfield in October 1978.

C. Description of monument for corner and accessories established to perpetuate locating the position of the corner:

Set brass cap in 1" Iron pipe in monument box.
20" Oak East 190.21' to nail w/flasher
8" Ash S55°E 106.37' to nail w/flasher
8" Ash S20°E 125.89' to nail w/flasher
Utility pole N20°W 93.41' to nail w/flasher

Approved by Livingston County Monumentation Peer Group October 20, 1993.

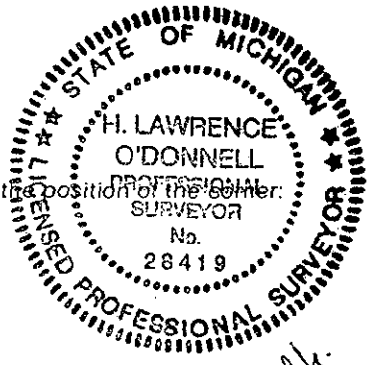

Signed by H. Lawrence O'Donnell Date December 22, 1993
Surveyor's Michigan License No. 28419

	A	B	C	D	E	F	G	H	I	J	K	L	M
2	6		5		4		3		2		1		
3													
4	7		8		9		10		11		12		
5													
6	18		17		16		15		14		13		
7													
8	19		20		21		22		23		24		
9													
10	30		29		28		27		26		25		
11													
12	31		32		33		34		35		36		
13													

SURVEY & RECOVERY
1993
COMMISSION

Civil Engineering • Surveying
Planning • Environmental Services

A T W E L L - H I C K S , I N C .

540 Avis Drive
P.O. Box 2981
Ann Arbor, Michigan 48106
313 994 4000 • FAX: 313 994 1599

RESEARCH RECORD

M-11 NE Corner Section 36, T1N, R6E

Fd. 1" Iron pipe set by Atwell-Hicks, Inc. in 1957 at the NE corner location.

Corner referenced in 1969 survey by W.E. Co.; 1972 PA 74 by C. Wilson; 1973 survey by W.E. Co.; 1977 survey by Roskelly Jekabson; 1978 PA 74 by A. Butterfield; 1979 survey by Roskelly Jekabson; and (2) 1987 surveys by W.E. Co.

A search of the area found no other irons. An iron marking the NW Corner Section 31, T1N, R7E was found 41.67 feet south.

I conclude that the iron found marks the NE Corner Section 36, T1N, R6E.



Mary A. Borkowski, RLA • William C. Henderson • Robert J. Jagow Jr., PE, PS • Robert G. Macomber, PE, PS
John L. Snyder, PE, PS • Allen R. Suggitt, PE • Richard G. Timmons, PE, PS