

MAR 17 2000

FILED

LAND CORNER RECORDATION CERTIFICATE  
Filing Requirement of Act 74, Mich. P.A. 1970

SECTION

For corners in

<u>LIVINGSTON</u> (County)	Located In:	Corner Code #
1. Public Land Survey	<u>T 2 N R 4 E</u>	<u>H-09</u>
	T <u>   </u> R <u>   </u>	<u>   </u>
	T <u>   </u> R <u>   </u>	<u>   </u>
	T <u>   </u> R <u>   </u>	<u>   </u>
2. Property Controlling in Section	S <u>   </u> T <u>   </u> R <u>   </u>	<u>   </u>
	S <u>   </u> T <u>   </u> R <u>   </u>	<u>   </u>
3. Miscellaneous Property in Sec.	S <u>   </u> T <u>   </u> R <u>   </u>	<u>   </u>
	S <u>   </u> T <u>   </u> R <u>   </u>	<u>   </u>

1999 MAY 21 A 9 23

NANCY HAVILAND  
REGISTER OF DEEDS  
LIVINGSTON COUNTY, MI.  
40843

L.S.C.#1021m

Register of Deeds Stamp & File Number

4. Lot No. \_\_\_\_\_, Recorded Plat \_\_\_\_\_  
5. Private Claims \_\_\_\_\_

I, JACK K SMITH, in a field survey on APRIL 30, 1999 do hereby state that under requirements of P.A. 74, Michigan P.A. of 1970, the corner points mentioned in lines 1 and 2 above were in conformance with regulations and rules therefore as required in the current manual of survey instructions of the United States Department of the Interior, Bureau of Land Management or by a decree of a Court of Law and/or that the corner points mentioned in lines 3, 4 and 5 above were in conformance with the rules of the Michigan Board of Land Surveyors or by a Decree of a Court of Law; established, re-established, monumented, recovered, found as expressed below:

NOTE: Not more than 2 corners, all in the same town and range, may be recorded on this certificate.

A	B	C	D	E	F	G	H	I	J	K	L	M
1												
2	6	5	4	3	2	1						
3												
4	7	8	9	10	11	12						
5												
6	19	17	16	15	14	13						
7												
8	19	20	21	22	23	24						
9												
10	30	29	28	27	26	25						
11												
12	31	32	33	34	35	36						
13												

A. Description of original monument and accessories and/or subsequent restoration:

GLO 1825 SIBLEY SET POST  
WHITE OAK 14 S 47 1/2° W 4.0'  
WHITE OAK 22 N 9 1/2° W 16.5'

B. Description of corner evidence found and/or method applied in restoring or reestablishing corner:

FOUND 1/2" REROD 6' NORTH OF THE CENTER LINE OF COON LAKE ROAD. THIS POSITION IS THE ONLY ONE THAT APPEARS TO HAVE BEEN USED.

C. Description of monument for corner and accessories established to perpetuate locating the position of the corner:

H-09 SOUTH 1/4 CORNER SECTION 22 AND NORTH 1/4 CORNER SECTION 27, T2N, R4E, MARION TOWNSHIP, LIVINGSTON COUNTY, MICHIGAN:

SET 1 1/4" X 36" STEEL PIPE WITH 6" BREAK OFF SECTION AND LIVINGSTON COUNTY REMONUMENTATION BRASS CAP WITH SURVEYOR #35999 IN MONUMENT BOX.

S10°E NAIL WITH LIVINGSTON COUNTY REMON TAG IN WEST SIDE DBL. 36" OAK 115.64'  
S45°E NAIL WITH LIVINGSTON COUNTY REMON TAG IN WEST SIDE 24" OAK 101.10'  
NORTH NAIL WITH LIVINGSTON COUNTY REMON TAG IN WEST SIDE 24" OAK 42.42'  
N45°W NAIL WITH LIVINGSTON COUNTY REMON TAG IN WEST SIDE UTIL. POLE 48.73'

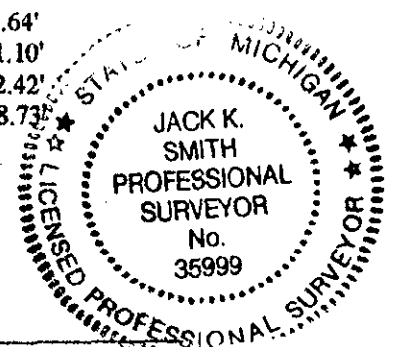

Signed by [Signature]

Date 5-10-1999

Surveyor's Michigan License No. 35999