

FEB 25 1999

SECTION

LAND CORNER RECORDATION CERTIFICATE  
Filing Requirement of Act 74, Mich. P.A. 1970

For corners in

Located In:	Corner Code //
1. Public Land Survey	T <u>2N</u> R <u>5E</u> <u>E-11</u>
	T _____ R _____
	T _____ R _____
	T _____ R _____
2. Property Controlling in Section	S _____ T _____ R _____
	S _____ T _____ R _____
3. Miscellaneous Property in Sec.	S _____ T _____ R _____
	S _____ T _____ R _____

4. Lot No. \_\_\_\_\_, Recorded Plat \_\_\_\_\_  
 5. Private Claims \_\_\_\_\_

I, Bryan L. Boss, in a field survey on Oct. 2, 1998, do hereby certify that under requirements of P.A. 74, Michigan P.A. of 1970, the corner points mentioned in lines 1 and 2 above were in conformance with regulations and rules therefore as required in the current manual of survey instructions of the United States Department of the Interior, Bureau of Land Management or by a decree of a Court of Law and/or that the corner points mentioned in lines 3, 4 and 5 above were in conformance with the rules of the Michigan Board of Land Surveyors or by a Decree of a Court of Law; established, re-established, monumented, re-monumented, recovered, found as expressed below:

NOTE: Not more than 4 corners, all in the same town and range, may be recorded on this certificate.

A. Description of original monument and accessories and/or subsequent restoration:  
 Corner Set in 1823 by S. Sibley Deputy Surveyor Set Post  
 Black Oak 16" N. 32W 4 links  
 Black Oak 10" S. 24E. 1.12 chains

B. Description of corner evidence found and/or method applied in restoring or reestablishing corner:

FD Boss Iron 2' South of  
 North edge of Brighton Rd.

P.A. 345 1990, APPROVED BY LIVINGSTON COUNTY

9-16-98 CO REP JED

C. Description of monument for corner and accessories established to perpetuate locating the position of the corner:  
 Set 1 1/2 by 30" Steel Pipe with a 6" long by 1 1/4 Steel Break away top W/Brass Cap Stamped "Livingston County Monumentation Corner  
 N. 20 W 38.31 Fd Remon N/T E side 24" Oak  
 Due East 31.85 Fd Remon N/T N side twin Oak  
 S 20 W 46.61 Fd Remon N/T E side 18" Oak  
 S 70 W 62.25 Fd Remon N/T S. E. side twin Oak

9  
 FILED  
 1998 OCT 22 P 1:18

NANCY HAVILAND  
 REGISTER OF DEEDS  
 LIVINGSTON COUNTY, MI.  
 48843

LSC955M

Register of Deeds Stamp & File Number

	A	B	C	D	E	F	G	H	I	J	K	L	M
2	6	5	4	3	2	1							
3													
4	7	8	9	10	11	12							
5													
6	18	17	16	15	14	13							
7													
8	19	20	21	22	23	24							
9													
10	30	29	28	27	26	25							
11													
12	31	32	33	34	35	36							
13													

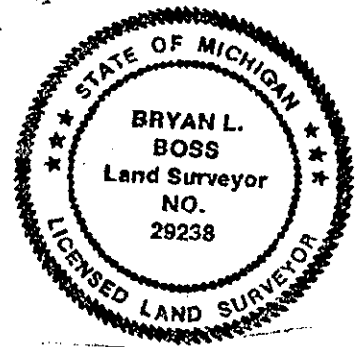

Signed by Bryan L. Boss  
 Surveyor's Michigan License No. 29238

Date 10-14-1998