

FEB 24 1998

FILED 9

SECTION

LAND CORNER RECORDATION CERTIFICATE 1997 NOV 25 A 11: 13
Filing Requirement of Act 74, Mich. P.A. 1970

NANCY HAVILAND
REGISTER OF DEEDS
LIVINGSTON COUNTY, MI.
48843

L.S.C.#820m

Register of Deeds Stamp & File Number

LIVINGSTON (County)	Located In: GENOA TWP.	Corner Code: //
Public Land Survey	T 2N R 5E	E-13
	T _____ R _____	_____
	T _____ R _____	_____
	T _____ R _____	_____
Property Controlling in Section	S _____ T _____ R _____	_____
Miscellaneous	S _____ T _____ R _____	_____
Property in Sec.	S _____ T _____ R _____	_____

Lot No. _____, Recorded Plat _____
Private Claims _____

A	B	C	D	E	F	G	H	I	J	K	L	M
2	6	5	4	3	2	1						
3												
4	7	8	9	10	11	12						
5												
6	18	17	16	15	14	13						
7												
8	19	20	21	22	23	24						
9												
10	30	29	28	27	26	25						
11												
12	31	32	33	34	35	36						
13												

BRYAN L. BOSS, in a field survey on SEPTEMBER 21, 1997, hereby certify that under requirements of P.A. 74, Michigan P.A. of 1970, the corner points mentioned in lines 1 and 2 above were in conformance with regulations and rules therefore as required in the present manual of survey instructions of the United States Department of the Interior, Bureau of Land Management or by a decree of a Court of Law and/or that the corner points mentioned in lines 3, 4 and 5 above were in conformance with the rules of the Michigan Board of Land Surveyors or by a Decree of a Court of Law; established, re-established, monumented, re-monumented, recovered, found as pressed below:

NOTE: Not more than 4 corners, all in the same town and range, may be recorded on this certificate.

Description of original monument and accessories and/or subsequent restoration:

- WHITE OAK 30" N 15 E 1.17' CHAINS
- WHITE OAK 12" N 63 W 47 LINKS
- BLACK OAK 9" N 15 E 23 LINKS

Description of corner evidence found and/or method applied in restoring or reestablishing corner:

FOUND 1 1/2" X 12" INCH PIPE IN OLD ROCK ROW EAST & WEST
THE DEPARTMENT OF NATURAL RESOURCES WITNESSES CHECKED WHEN
CORNER WAS SET IN 1948.

Description of monument for corner and accessories established to perpetuate localing the position of the corner:

- SET 1 1/4" X 36" PIPE WITH BRASS CAP STAMPED "LIVINGSTON COUNTY MONUMENTATION CORNER".
- N 05 W 6.40' WOOD POST
- N 25 E 17.22' NAIL & TAG SOUTHEAST SIDE 18" OAK
- N 85 E 10.82' NAIL & TAG NORTH SIDE 10" OAK
- E 40 W 31.48' NAIL & TAG EAST SIDE 18" OAK



by Bryan L. Boss Date Sept. 25, 1997
Surveyor's Michigan License No. 29238

**SUMMARY
E-13**

Southeast Corner, Section 32, Genoa Township,

This corner was set in December of 1815 by Alex Holmes.

In 1948, S.J. Higgins from the department of Natural Resources, set a 1 1/4" pipe at the intersection of fence North-South & West. (See pages 11-12 & 13). This Southeast corner of Section 32 Genoa Township was found on May 17, 1972, by Oscar Boss and recorded as E-13, see Act 74 on page 15, this dossier and Boss survey on page 16. Witnesses check.

On 8-9-73, Raymond Kostecke found 2" pipe and his witnesses check Oscar Boss recorded survey. This indicates Kostecke had also accepted E-13.

Subsequent surveys by Boss Engineering in 1974-1976-1977 record 1 1/4" pipe found and log same witnesses.

On 7-31-97, Boss Engineering checked witnesses but found 1 1/2" iron pipe 1 foot above ground and 6 ft ± South & 1 ft ± East of corner post.

The 7-31-97 Pipe found by Boss Engineering is in old rock fence East and West and the witnesses check the 1948 Department of Natural Resources 1 1/4" pipe set at intersection of fences North-South & West. Further reconnaissance found fence remnants 32 ft ± westerly. G.L.O. Map records 53 Links (34.98 feet), westerly.

This corner is in woods and will be difficult for G.P.S..

We find the consistency in witness points from the date the D.N.R. set this corner, and the occupation to the falling distance to the Northeast corner of Section 5, Hamburg Township evidence to substantiate acceptance as found.

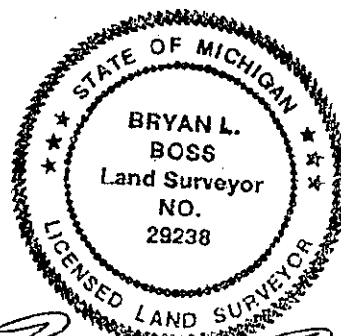

Bryan L. Boss

SUMME-13