

OCT 26 1995

COMMISSION

LAND CORNER RECORDATION CERTIFICATE

Filing Requirement of Act 74, Mich. P.A. 1970

For corners in

Livingston (County)

Located In:

Corner Code #/

1. Public Land Survey	T <u>2N</u> R <u>5E</u>	<u>I-9</u>
	T ___ R ___	___
	T ___ R ___	___
	T ___ R ___	___
2. Property Controlling in Section	S ___ T ___ R ___	___
	S ___ T ___ R ___	___
3. Miscellaneous Property in Sec.	S ___ T ___ R ___	___
	S ___ T ___ R ___	___

HANGY ILLIAND REGISTER OF DEEDS LIVINGSTON COUNTY MI 48843

OCT 4 3 20 PM 1995

FILED

L.S.C.#458m

Register of Deeds Stamp & File Number

4. Lot No. _____, Recorded Plat _____

5. Private Claims _____

A	B	C	D	E	F	G	H	I	J	K	L	M
2	6		5		4		3		2		1	
3												
4	7		8		9		10		11		12	
5												
6	18		17		16		15		14		13	
7												
8	19		20		21		22		23		24	
9												
10	30		29		28		27		26		25	
11												
12	31		32		33		34		35		36	
13												

I, Bryan Boss, in a field survey on 8-24, 1995, do hereby certify that under requirements of P.A. 74, Michigan P.A. of 1970, the corner points mentioned in lines 1 and 2 above were in conformance with regulations and rules therefore as required in the current manual of survey instructions of the United States Department of the Interior, Bureau of Land Management or by a decree of a Court of Law and/or that the corner points mentioned in lines 3, 4 and 5 above were in conformance with the rules of the Michigan Board of Land Surveyors or by a Decree of a Court of Law; established, re-established, monumented, re-monumented, recovered, found as expressed below:

NOTE: Not more than 4 corners, all in the same town and range, may be recorded on this certificate.

A. Description of original monument and accessories and/or subsequent restoration:

- Set post common to Sections 22, 23, 26 & 27
- Black Oak 10" N 32 W 11 links
- White Oak 10" S 29 1/2 W 52 links
- Yellow Oak 25" S 11 1/2 E .31
- Black Cherry 16" S 43 W 29.5'
- Hickory 20" S 25 E 32.9'
- White Oak 22" S 57 1/2 E 44'
- White Oak 24" N 66 1/2 E 58.4'

B. Description of corner evidence found and/or method applied in restoring or reestablishing corner:

- Found 1/2" iron rod in monument box,
- Centerline Dorr Road and Centerline Challis Road
- 48.60 N 45° W 18" Hickory
- 25.23 S 10° W 20" Walnut (out)
- 41.6 S 45° E 36" Oak
- 75.1 S 45° W 18" Walnut

C. Description of monument for corner and accessories established to perpetuate locating the position of the corner:

- Set brass cap on 1/2" iron in monumnet box
- 40.48 N 45° E Southwest corner catch basin
- 40.52 S 45° E nail & tag West side 36" Oak
- 55.43 South nail & tag East side 40" Walnut
- 75.03 S 50° W nail & tag North side 18" Walnut
- 55.88 N 30° W nail & tag East side 15" Oak

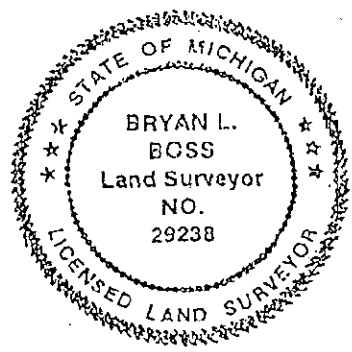

Signed by [Signature] Date 3pt. 28, 1995

Surveyor's Michigan License No. 29238

SUMMARY

I-9

Northwest Corner, Section 26, T2N-R5E Genoa Township,
Livingston County, Michigan.

Found ½" Iron rod in monument box at centerline of Dorr Road
and centerline of Challis Road. Questionable corner for
G.P.S. due to over hanging branches.

Southwest ¼ of section 23 split by Miles Bullock (page 8)
and west ¼ of section 26 surveyed by Dunning, see pages 9-10
the dossier.

The witnesses from Garlock Act 74 (page 15) are all gone.

The witnesses from Pangas survey (pages 24-25) are 2 of 4
found and they checked.

The Livingston County Road Commission notes and witnesses
(page 30) are 3 of 3 witnesses found and they all checked ½"
iron in monument box.

All surveys in dossier ((14-34) use the point that is now a
½" iron rod in a monument box.

We recommend using the ½" iron rod in monument box as I-9.

GENI-9S

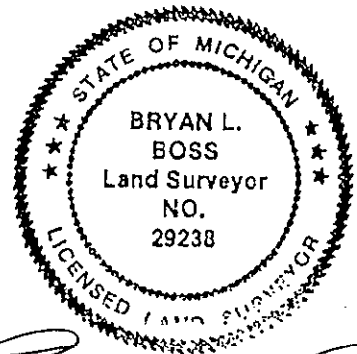

Bryan L. Boss