

SURVEY & REMONUMENTATION

FILED

APR 28 1995

Nov 16 2 06 PM '94

COMMISSION

LAND CORNER RECORDATION CERTIFICATE
Filing Requirement of Act 74, Mich. P.A. 1970

NANCY HAVILAND
REGISTER OF DEEDS
LIVINGSTON COUNTY, MI
48843

For corners in
Livingston
(County)

Located In: Corner Code #

1. Public Land Survey	T	<u>2N</u>	R	<u>5E</u>	<u>K-6</u>	
	T	_____	R	_____	_____	
	T	_____	R	_____	_____	
	T	_____	R	_____	_____	
2. Property Controlling In Section	S	_____	T	_____	R	_____
	S	_____	T	_____	R	_____
3. Miscellaneous Property in Sec.	S	_____	T	_____	R	_____
	S	_____	T	_____	R	_____

L.S.C. #358m

Register of Deeds Stamp & File Number

4. Lot No. _____, Recorded Plat _____
5. Private Claims _____

	A	B	C	D	E	F	G	H	I	J	K	L	M
2	6	5	4	3	2	1							
3													
4	7	8	9	10	11	12							
5													
6	18	17	16	15	14	13							
7													
8	19	20	21	22	23	24							
9													
10	30	29	28	27	26	25							
11													
12	31	32	33	34	35	36							
13													

I, Bryan Boss, in a field survey on 10-27-1994, do hereby certify that under requirements of P.A. 74, Michigan P.A. of 1970, the corner points mentioned in lines 1 and 2 above were in conformance with regulations and rules therefore as required in the current manual of survey instructions of the United States Department of the Interior, Bureau of Land Management or by a decree of a Court of Law and/or that the corner points mentioned in lines 3, 4 and 5 above were in conformance with the rules of the Michigan Board of Land Surveyors or by a Decree of a Court of Law; established, re-established, monumented, re-monumented, recovered, found as expressed below:

NOTE: Not more than 4 corners, all in the same town and range, may be recorded on this certificate.

A. Description of original monument and accessories and/or subsequent restoration:

Black Oak	20"	N 41 W	125 Links
Black Oak	15"	N 30 E	130 Links
Cedar	10"	N 48 W	48 Links
White Oak	16"	N 21 W	93 Links

Additional data on back.

B. Description of corner evidence found and/or method applied in restoring or reestablishing corner:

Found 5/8" inch pipe 2 feet ± West of centerline Hubert Road.

C. Description of monument for corner and accessories established to perpetuate locating the position of the corner:

Set 1 1/4" x 30" iron pipe and raised 1 1/4" x 6" iron pipe with brass cap marked Livingston County Monument Corner.

- N20° 116.23' N&T E/S 24"Oak
- N20°E 85.46' N&T W/S 42"Oak
- S85°W 29.79' N&T S/S 8"Cottonwood
- S30°E 92.68 N&T W/S 6"Ash

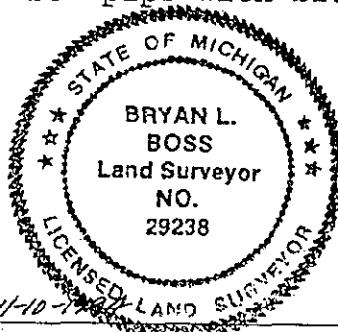

Signed by Bryan L. Boss
Surveyor's Michigan License No. 29238

Date 11-10-1994

BOSS ENGINEERING **ENGINEERS & SURVEYORS**

SUMMARY

K-6 WEST 1/4 CORNER SECTION 13, T2N-R5E, GENOA TOWNSHIP, LIVINGSTON COUNTY, MICHIGAN.

Found 5/8" inch Iron Pipe .80 deep and 2' feet ± West of Centerline Hubert Road (24' Gravel).

Measured to Witnesses found. Found 2 of 3 of Herbert Munzel Witnesses and they checked.

Page 15 of this Dossier. Found 4 of 4 of Boss Engineering witnesses and they checked pages 36, 33, 29, and 3 of 3 witnesses pages 26, 24, 20, 18, 16 and 12. Found 2 of 3 Charles Garlock witnesses and they checked page 22 this Dossier. Found 4 of 4 of Desine Witnesses and they checked, page 32.

Distances from the Northwest Corner of Section 13 to the West 1/4 Corner is 2663.43' feet, page 12 and 2664.06' feet, page 21, Boss Engineering Surveys.

Distances from the Southwest Corner of Section 13 to the West 1/4 corner is 2665.95' feet, page 23 and 2665.78' feet page 30, 31, 35 Boss Engineering Surveys.

No additional Irons found.

Large pond to the West and water retention area Easterly. Hubert Road (24' feet Gravel) runs North and South.

We can conclude that the 5/8" inch Iron is the correct West 1/4 Corner of Section 13.

summary2

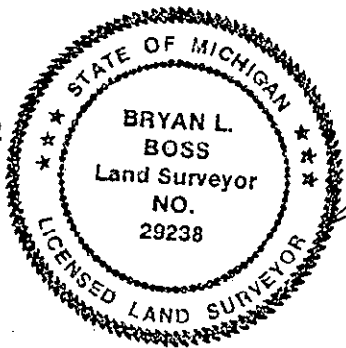

A handwritten signature in black ink, appearing to read "Bryan L. Boss", written over the right side of the professional seal.