

**SURVEY & REMONUMENTATION**

APR 28 1995

**COMMISSION**

For corners in  
Livingston  
(County)

**LAND CORNER RECORDATION CERTIFICATE**  
Filing Requirement of Act 74, Mich. P.A. 1970

Nov 16 2 06 PM '94  
NANCY HAVILAND  
REGISTER OF DEEDS  
LIVINGSTON COUNTY, MI  
48843

Located In: Corner Code #

1. Public Land Survey	T <u>2N</u> R <u>5E</u>	<u>K-10</u>
	T _____ R _____	_____
	T _____ R _____	_____
	T _____ R _____	_____
2. Property Controlling In Section	S _____ T _____ R _____	_____
	S _____ T _____ R _____	_____
3. Miscellaneous Property in Sec.	S _____ T _____ R _____	_____
	S _____ T _____ R _____	_____

L.S.C. #362m

Register of Deeds Stamp & File Number

4. Lot No. \_\_\_\_\_, Recorded Plat \_\_\_\_\_  
5. Private Claims \_\_\_\_\_

	A	B	C	D	E	F	G	H	I	J	K	L	M
2	6	5	4	3	2								
3													
4	7	8	9	10	11	12							
5													
6	18	17	16	15	14	13							
7													
8	19	20	21	22	23	24							
9													
10	30	29	28	27	26	25							
11													
12	31	32	33	34	35	36							
13													

I, Bryan Boss, in a field survey on 10-27, 19 94, do hereby certify that under requirements of P.A. 74, Michigan P.A. of 1970, the corner points mentioned in lines 1 and 2 above were in conformance with regulations and rules therefor as required in the current manual of survey instructions of the United States Department of the Interior, Bureau of Land Management or by a decree of a Court of Law and/or that the corner points mentioned in lines 3, 4 and 5 above were in conformance with the rules of the Michigan Board of Land Surveyors or by a Decree of a Court of Law; established, re-established, monumented, re-monumented, recovered, found as expressed below:

NOTE: Not more than 4 corners, all in the same town and range, may be recorded on this certificate.

A. Description of original monument and accessories and/or subsequent restoration:

- White Oak 36" N 56 W 140 Links
- White Oak 16" S 52 1/2 E 134 Links
- Black Oak 10" N 77 1/4 W 32 1/2
- White Oak 10" N 24 3/4 W 50 1/4

Additional data on back.

B. Description of corner evidence found and/or method applied in restoring or reestablishing corner:

Found 1/2" iron rered in monument box in centerline of Bauer Road.

C. Description of monument for corner and accessories established to perpetuate locating the position of the corner:

Set 1 1/2" x 30" iron pipe in monument box with brass cap marked Livingston County monument corner.  
S15°W 119.56' N&T W/S Power Pole  
S30°E 66.47' N&T E/S 26" Oak  
EAST 50.68' N&T S/S 20" Oak  
S45°W 50.20' N&T SW/S Power Pole

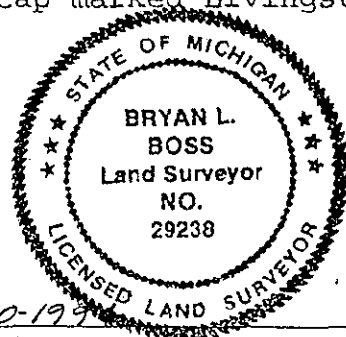

Signed by [Signature]  
Surveyor's Michigan License No. 29238

Date 11-10-1994

31 August 1994

# **BOSS ENGINEERING** ENGINEERS & SURVEYORS

## SUMMARY

K-10 West 1/4 CORNER SECTION 25, T2N-R5E GENOA TOWNSHIP, LIVINGSTON COUNTY, MICHIGAN.

Found 1/2" inch Iron Rerod in Monument Box in Centerline of Bauer Road (30' feet wide asphalt with curb).

Originally surveyed in 1878 by E.W.G. subsequent surveys by M.W. Bullock in 1892 and 1898 and by Grant H. Dunning in 1915, (field notes page 9 this Dossier), show North and South Section Line to be 80.61 chains (5320.26feet). G.L.O. distances computes 2660.13 for 1/2 mile.

Distances from the West 1/4 Corner to the Northwest Corner of said Section 25 is 2659.64' feet Munsell and Garlock Survey, page 11, 12 of this Dossier; 2659.70' feet Munsell and Garlock Survey, page 18, 2659.46' feet Boss Engineering Survey, pages 13, 19 of this Dossier and 2660.18' feet Larry A. Bryan Survey, page 21 of this Dossier.

Distances from the Southwest Corner of Section 25 to the West 1/4 Corner is 2653.75' feet Boss Engineering Survey, page 13; 2661.41' feet Boss Engineering Survey pages 17, 23, 25, 27, 29, 33 of this Dossier.

Found 2 of 4 Witnesses, Munsell & Garlock, page 10, and they checked. Found 4 of 4 Boss Engineering Witnesses pages 14, 15, 16, 17, 20, 24, 26, 28, 30, 32, 34, 35 and 36. They all checked corner.

Found 3 of 3 Munsell and Garlock Witnesses page 18 and they checked. Also found 3 of 3 Larry A. Bryan Witnesses, page 22 and hey checked.

Area is open in all directions for G.P.S..

Conclusion: Distance found to belong on Section Line North and South, which coincides with original G.L.O. notes and existing surveys in this Dossier. All witnesses point to one corner, therefore we find that the 1/2" inch Iron in Monument Box is the correct West 1/4 Corner of Section 25.

file: S-100005

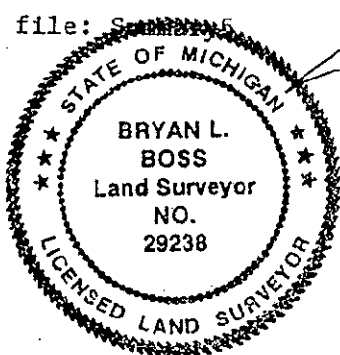

*Bryan L. Boss*

Boss Engineering Company • 3121 East Grand River • Howell Michigan 48843  
Phone (517) 546-4836 • Brighton (313) 229-4773 • Fax (517) 548-1670