

1993

DEC 29 11 25 AM '93

COMMISSION

LAND CORNER RECORDATION CERTIFICATE  
Filing Requirement of Act 74, Mich. P.A. 1970

NANCY HAVILAND  
REGISTER OF DEEDS  
LIVINGSTON COUNTY, MI  
48843

For corners in

<u>Livingston</u> <small>(County)</small>	Located In:	Corner Code =#
1. Public Land Survey	T <u>2N</u> R <u>5E</u>	<u>K-11</u>
	T _____ R _____	_____
	T _____ R _____	_____
	T _____ R _____	_____
2. Property Controlling in Section	S _____ T _____ R _____	_____
	S _____ T _____ R _____	_____
3. Miscellaneous Property in Sec.	S _____ T _____ R _____	_____
	S _____ T _____ R _____	_____
4. Lot No. _____, Recorded Plat _____		
5. Private Claims _____		

L.S.C. #172m  
Register of Deeds Stamp & File Number

	A	B	C	D	E	F	G	H	I	J	K	L	M
2	6	5	4	3	2	1							
3													
4	7	8	9	10	11	12							
5													
6	13	17	16	15	14	13							
7													
8	19	20	21	22	23	24							
9													
10	30	29	28	27	26	25							
11													
12	31	32	33	34	35	36							
13													

I, Bryan Boss, in a field survey on December 22, 1993, do hereby certify that under requirements of P.A. 74, Michigan P.A. of 1970, the corner points mentioned in lines 1 and 2 above were in conformance with regulations and rules therefore as required in the current manual of survey instructions of the United States Department of the Interior, Bureau of Land Management or by a decree of a Court of Law and/or that the corner points mentioned in lines 3, 4 and 5 above were in conformance with the rules of the Michigan Board of Land Surveyors or by a Decree of a Court of Law; established, re-established, monumented, re-monumented, recovered, found as expressed below:

NOTE: Not more than 4 corners, all in the same town and range, may be recorded on this certificate.

A. Description of original monument and accessories and/or subsequent restoration:

Surveyed May 1st, 2nd and 3rd 1879  
Fairchild

B. Description of corner evidence found and/or method applied in restoring or reestablishing corner:

Found 1/2" Pipe 6 Feet ± West of Centerline Bauer Road  
No Evidence of Tree Row East or West

C. Description of monument for corner and accessories established to perpetuate locating the position of the corner:

Reset with 1 1/4" x 36" Breakaway Iron  
Pipe with Livingston Co. Brass Cap on Top

S65°E 37.14' Spike W/Side 12" Cedar	Approved by Livingston Co. Monumentation Peer Group on November 3, 1993
S85°W 34.67' Spike S/Side 14" Twin Cherry	
N42°W 47.87' Spike NE/Side 14" Twin Mulberry	
East 30.10' Spike N/Side Fence Post	

Signed by \_\_\_\_\_  
Surveyor's Michigan License No. 29238

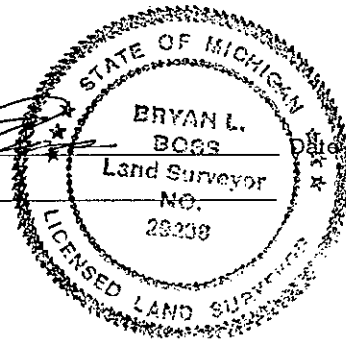

December 28, 1993

Summary

K-11           NORTHEAST CORNER, SECTION 35, T2N-R5E,  
              GENOA TOWNSHIP, LIVINGSTON COUNTY, MICHIGAN

Surveyed May 5th 1823, again in May 1879. Deputy County Surveyor found distance from North 1/4 corner to Northeast corner said Section (not measured) but evidently is 2 chains short of the half mile.

1973 Boss survey shows line 2660.66' and 1/2" pipe found.

Lime Lake is on Section line to the East. Found 1/2" pipe 9'+/- West of centerline of Bauer Road (28' gravel). Centerline Bauer Road North of Brighton projected southerly 400' +/- is on line with iron found.

No other irons found.

Witnessed same 1/2" pipe in 1979.

In 1986 Arvin Butterfield witnesses check to 1/2" pipe

1993 Boss survey in Section 26 used same corner.

Also Brighton Estates Subdivision, Liber 23, Pages 35-39.

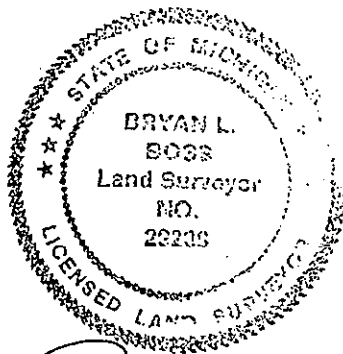

A handwritten signature in cursive script, appearing to read "Bryan L. Boss", written over the bottom portion of the professional seal.

file: Witness