

DEC 29 11 25 AM '93

LAND CORNER RECORDATION CERTIFICATE
Filing Requirement of Act 74, Mich. P.A. 1970
LIVINGSTON COUNTY, MI 48843

For corners in

Livingston Located In: _____ Corner Code # K-13
(County)

1. Public Land Survey T 2N R 5E _____
T _____ R _____
T _____ R _____
T _____ R _____

2. Property Controlling S _____ T _____ R _____
in Section S _____ T _____ R _____

3. Miscellaneous S _____ T _____ R _____
Property in Sec. S _____ T _____ R _____

4. Lot No. _____, Recorded Plat _____

5. Private Claims _____

L.S.C. #169m
Register of Deeds Stamp & File Number

I, Bryan Boss, in a field survey on December 22, 1993, do hereby certify that under requirements of P.A. 74, Michigan P.A. of 1970, the corner points mentioned in lines 1 and 2 above were in conformance with regulations and rules therefore as required in the current manual of survey instructions of the United States Department of the Interior, Bureau of Land Management or by a decree of a Court of Law and/or that the corner points mentioned in lines 3, 4 and 5 above were in conformance with the rules of the Michigan Board of Land Surveyors or by a Decree of a Court of Law; established, re-established, monumented, re-monumented, recovered, found as expressed below:

NOTE: Not more than 4 corners, all in the same town and range, may be recorded on this certificate.

A. Description of original monument and accessories and/or subsequent restoration:

B. Oak 16 in. Dia. N83E 80 Lks
Surveyed 1866 E. N. Fairchild Co. Surveyor

	A	B	C	D	E	F	G	H	I	J	K	L	M
2	6		5		4		3		2		1		
3													
4	7		8		9		10		11		12		
5													
6	18		17		16		15		14		13		
7													
8	19		20		21		22		23		24		
9													
10	30		29		28		27		26		25		
11													
12	31		32		33		34		35		36		
13													

SUBMITTED
REMAINING SECTION
1993
COMMISSION

B. Description of corner evidence found and/or method applied in restoring or reestablishing corner:

Found L-Shaped Steel Fence Post 40 Feet ± East of Centerline
Bauer Road

C. Description of monument for corner and accessories established to perpetuate locating the position of the corner:

Set 1 1/4" x 36" Iron Pipe with
Brass Cap (Livingston Co. Mon. Corner)

West 38.50' Iron Fd. SE Cor. Sec. 2 Hamburg
N25°E 54.62' Spike W/Side 26" Oak
S65°W 122.72' Spike S/Side 28" Oak
S30°W 181.57' Spike E/Side 32" Oak
West 19.80' 1 1/2" Pipe Centerline Gravel Dr.

Approved by Livingston Co.
Monumentation Peer Group
on November 6, 1993

Signed by Bryan L. Boss Date December 28, 1993
Surveyor's Michigan License No. 29238

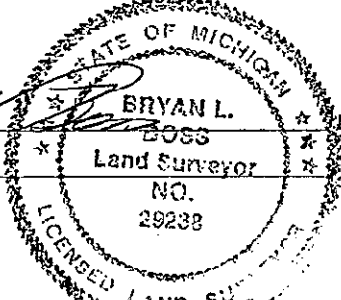

BOSS ENGINEERING
ENGINEERS & SURVEYORS

November 5, 1993

SUMMARY

K-13 SW Corner, Section 36, Genoa Township,
Livingston County, Michigan

Originally surveyed by Fairchild in 1866.

In 1985 Arvin Butterfield found L-shaped steel fence post.
Also found K-1, Section 1, Hamburg Township, West 38.47.

G.L.O. notes call for N.E. Corner Section 2 to be 39.60 (60
links) West of N.E. Corner, Section 35. Boss measured 38.55.

Found Hughes-Butterfield-Boss Tags. L-shaped post found in
marsh area 31' +/- West of N & S fence and 26' +/- East of
East edge Bauer Road (gravel).

Found 1/2" rod 12' +/- West of East edge Bauer Road.

Only two witness trees could be found.

file: K-13

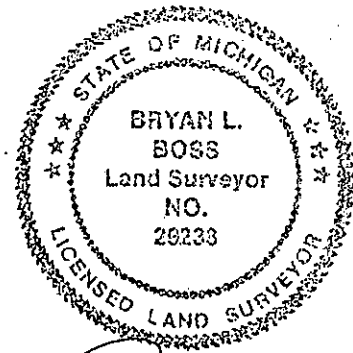

A handwritten signature in cursive script, appearing to read "Bryan L. Boss", written over the bottom portion of the professional seal.