

LAND CORNER RECORDATION CERTIFICATE
Filing Requirement of Act 74, Mich. P.A. 1970

9-

For Corners In GENOA TWP.

FILED

<u>LIVINGSTON</u> (COUNTY)	Located In	Corner Code #
1. Public Land Survey	T2N R5E	L-1
	T___ R___	_____
	T___ R___	_____
	T___ R___	_____
2. Property Controlling in Section	S___ T___ R___	_____
	S___ T___ R___	_____
3. Miscellaneous Property in Sec.	S___ T___ R___	_____
	S___ T___ R___	_____

1996 DEC 19 A 11:27

NANCY HAVILAND
REGISTER OF DEEDS
LIVINGSTON COUNTY, MI.
48843

L.S.C.#636m

REGISTER OF DEEDS STAMP & FILE NUMBER

4. Lot No. _____, Recorded Plat _____
 5. Private Claims _____

A B C D E F G H I J K L M

2	6	5	4	3	2	1
3						
4	7	8	9	10	11	12
5						
6	18	17	16	15	14	13
7						
8	19	20	21	22	23	24
9						
10	30	29	28	27	26	25
11						
12	31	32	33	34	35	36
13						

I, BRYAN L. BOSS in a field survey on OCTOBER 30, 1996, do hereby certify that under requirements of P.A. 74, Michigan P.A. of 1970, the corner points mentioned in lines 1 and 2 above were in conformance with regulations and rules therefore as required in the current manual of survey instructions of the United States Department of the Interior, bureau of Land Management or by a decree of a Court of Law and/or that the corner points mentioned in lines 3, 4 and 5 above were in conformance with the rules of the Michigan Board of Land Surveyors or by a Decree of a Court of Law, established, re-established, monumented, re-monumented, recovered, found as expressed below:

NOTE: Not more than 4 corners, all in the same town and range, may be recorded on this certificate.

A. Description of original monument and accessories and/or subsequent restoration:

NORTH LINE OF SECTION SURVEYED BY ALEX HOLMES IN 1816
 BLACK OAK 12" S 61° E 36 LINKS
 WHITE OAK 8" S 73° W 45 LINKS

B. Description of corner evidence found and/or applied in restoring or reestablishing corner:

AMENDED CORNER

FOUND ½" IRON ROD IN CENTERLINE OF GOLF CLUB ROAD. TREE ROW OCCUPATION SOUTHERLY TO CENTER OF SECTION.

"TRUE"
CLOSING CORNER

N 00° 16'30" E 5.06 FEET FROM AMENDED CORNER

C. Description of monument for corner and accessories established to perpetuate location the position of the corner:

SET 1 ½ X 30" PIPE AND 6" BREAKAWAY WITH CAP
 AMENDED CORNER

SET 1 ½ X 30" PIPE AND 6" BREAKAWAY WITH BRASS CAP
 STAMPED "LIVINGSTON COUNTY MONUMENT CORNER"

N 40° E 2" STEEL FENCE CORNER POST 48.00'
 S 35° E NAIL & TAG SOUTH SIDE 24" HICKORY 60.59'
 S 35° W NAIL & TAG NORTH SIDE 18" TWIN ASH 35.81'
 N 50° W NAIL & TAG SOUTH SIDE 24" OAK 47.66'
 EAST ½" IRON ROD SOUTH ¼ CORNER SECTION 36, T3N-R5E, 28.66'

N 45° E STEEL FENCE CORNER POST 44.15'
 S 60° E NAIL & TAG SOUTH SIDE 24" HICKORY 62.59'
 S 45° W NAIL & TAG NORTH SIDE 18" TWIN ASH 39.02'
 N 70° W NAIL & TAG SOUTH SIDE 24" OAK 45.30'
 S 0° 16' 30" W AMENDED CORNER

PA. 345 1990, APPROVED BY LIVINGSTON COUNTY
 PEER GROUP ON 9-11-96 CO. REP JED

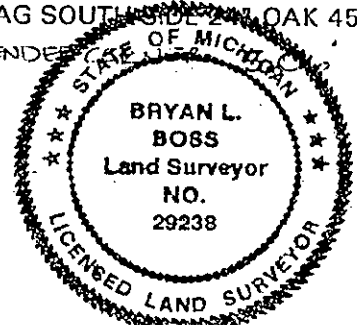

Signed by Bryan L. Boss
 Surveyor's Michigan License No. 29238

Date 12-17-1996

SUMMARY

L-1

North ¼ Corner, Section 1, T2N-R5E Genoa Township, Livingston County, Michigan.

Found ½' Iron Rod in Centerline of Golf Club Road (Gravel Surface). Overhanging branches will make this corner a difficult G.P.S. Station. There is tree row occupation Southerly to Center of Section. The North Boundary Line of Genoa Township was surveyed in 1816 by Alex Holmes and Section Lines run by Sylvester Sibley in 1823.

The summary of recorded and unrecorded distances, on page 6, finds 1971 survey by Finney & Kostecke measured from Northeast corner of Section 1 to the North ¼ corner of said Section, while Patrick L. Benton's 1976 survey measured to South ¼ corner, Section 36, Oceola Township. This Township jog computes 28.41 feet. In comparison, Tri-County Surveys 1989 distance measured 2678.73 feet from the Northeast Corner, Section 1, to the North ¼ Corner of said section, and Boss Engineering 1992 Survey measured 2649.95 feet to the South ¼ Corner of Section 36, Oceola Township. This Township jog computes 28.81 feet.

Boss Engineering witnesses dated March 25, 1996, found Pat Benton August 12, 1974, witness number two and they both checked.

We recommend accepting ½" Iron as found.

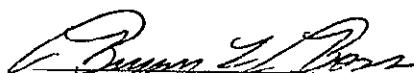
Bryan L. Boss No. 29238

