

1996 NOV 25 A 9:39

LAND CORNER RECORDATION CERTIFICATE
Filing Requirement of Act 74, Mich. P.A. 1970

NANCY HAVILAND
REGISTER OF DEEDS
LIVINGSTON COUNTY, MI.
48843

For Corners in GENOA TWP.

<u>LIVINGSTON</u> (COUNTY)	Located In	Corner Code #
1. Public Land Survey	T2N R5E	L-3
	T___ R___	_____
	T___ R___	_____
	T___ R___	_____
2. Property Controlling in Section	S___ T___ R___	_____
	S___ T___ R___	_____
3. Miscellaneous Property in Sec.	S___ T___ R___	_____
	S___ T___ R___	_____
4. Lot No. _____, Recorded Plat _____		
5. Private Claims _____		

L.S.C. #602m

REGISTER OF DEEDS STAMP & FILE NUMBER

	A	B	C	D	E	F	G	H	I	J	K	L	M
2	6	5	4	3	2	1							
3													
4	7	8	9	10	11	12							
5													
6	18	17	16	15	14	13							
7													
8	19	20	21	22	23	24							
9													
10	30	29	28	27	26	25							
11													
12	31	32	33	34	35	36							
13													

I, BRYAN L. BOSS in a field survey on OCTOBER 30, 1996, do hereby certify that under requirements of P.A. 74, Michigan P.A. of 1970, the corner points mentioned in lines 1 and 2 above were in conformance with regulations and rules therefore as required in the current manual of survey instructions of the United States Department of the Interior, bureau of Land Management or by a decree of a Court of Law and/or that the corner points mentioned in lines 3, 4 and 5 above were in conformance with the rules of the Michigan Board of Land Surveyors or by a Decree of a Court of Law, established, re-established, monumented, re-monumented, recovered, found as expressed below:

NOTE: Not more than 4 corners, all in the same town and range, may be recorded on this certificate.

A. Description of original monument and accessories and/or subsequent restoration:
 CORNER SET IN 1823 BY SYLVESTER SIBLEY
 WHITE OAK 10" N 86° W 53 LINKS
 WHITE OAK 8" N 75° E 24 LINKS
 WHITE OAK 24" S 13° E 33

B. Description of corner evidence found and/or applied in restoring or reestablishing corner:
 FOUND 3/4" PIPE BELOW GRAVEL SURFACE.
 TREE ROW AND OLD FENCE OCCUPATION NORTH AND SOUTH

C. Description of monument for corner and accessories established to perpetuate location the position of the corner:

SET 1 1/4 X 30" PIPE 1 FOOT BELOW GRAVEL SURFACE WITH A 6" BREAKAWAY AND BRASS CAP STAMPED "LIVINGSTON COUNTY REMONUMENTATION CORNER."

N 45° E NAIL & TAG SOUTH SIDE 24" OAK 26.11
 S 2° E NAIL & TAG WEST SIDE UTILITY POLE 34.10
 S 70° W NAIL & TAG NORTH SIDE 36" OAK 74.48
 NORTH 3/4" IRON ROD 33.00

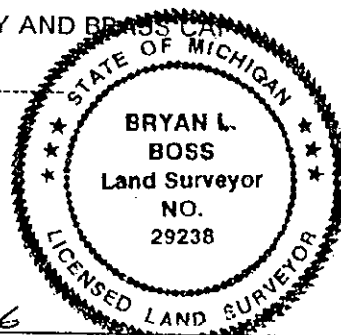

Signed by Bryan L. Boss
 Surveyor's Michigan License No. 29238

Date 11-15-1996

FORM APPROVED BY MICHIGAN STATE BOARD OF LAND SURVEYORS, JAN. 28, 1975

REVISED MAY 14, 1975
 REVISED JAN., 1983

PA. 345 1990, APPROVED BY LIVINGSTON COUNTY
 PEER GROUP ON 9-11-96, CO. REP JEP

SUMMARY

L-3

North 1/4 Corner, Section 12, T2N-R5E, Genoa Township, Livingston County, Michigan.

Found 3/4" Iron Pipe 0.4 tenths below gravel surface and 2 feet \pm North of the centerline of McClements Road. Tree row and old fence occupation North and South. Also, found 3/4" Iron Rod 33.00 feet North of 1/4 corner.

This information agrees with Atwell-Hicks's June 2, 1962 survey on page 11 of this dossier. On October 20, 1970, Munsell and Garlock measured East along McClements Road 1359.00 feet to the centerline of Hacker Road. This agrees with Washtenaw Engineering's November 6, 1972 survey split of 1359.00 feet Easterly to the Southeast corner of Section 1, Genoa Township. Charles Wilson's witness to a 26" Oak 74.57 feet now measures 36" Oak 74.48 feet. We find the 3/4" Iron Pipe found by Atwell-Hicks in 1962 to be same as found by Charles Garlock on March 3, 1993 and Boss Engineering on March 15, 1996. Therefore, we recommend accepting 3/4" pipe as found. Over hanging branches may hinder G.P.S. location.

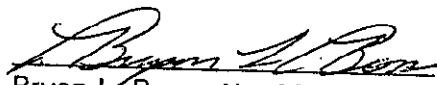
Bryan L. Boss No. 29238

