

FILED

DEC 29 11 25 AM '93

LAND CORNER RECORDATION CERTIFICATE

Filing Requirement of Act 74, Mich. P.A. 1970

NANCY HAVILAND
REGISTER OF DEEDS
LIVINGSTON COUNTY, MI
48843

For corners in

Livingston Located In: Corner Code #

1. Public Land Survey	T	2N	R	5E	L-11
	T		R		
	T		R		
	T		R		
2. Property Controlling in Section	S		T		R
	S		T		R
3. Miscellaneous Property in Sec.	S		T		R
	S		T		R

4. Lot No. _____, Recorded Plat _____

5. Private Claims _____

L.S.C. #178m
Register of Deeds Stamp & File Number

	A	B	C	D	E	F	G	H	I	J	K	L	M
2	6		5		4		3		2		1		
3													
4	7		8		9		10		11		12		
5													
6	18		17		16		15		14		13		
7													
8	19		20		21		22		23		24		
9													
10	30		29		28		27		26		25		
11													
12	31		32		33		34		35		36		
13													

I, Bryan Boss, in a field survey on December 22, 1993 do hereby certify that under requirements of P.A. 74, Michigan P.A. of 1970, the corner points mentioned in lines 1 and 2 above were in conformance with regulations and rules therefore as required in the current manual of survey instructions of the United States Department of the Interior, Bureau of Land Management or by a decree of a Court of Law and/or that the corner points mentioned in lines 3, 4 and 5 above were in conformance with the rules of the Michigan Board of Land Surveyors or by a Decree of a Court of Law; established, re-established, monumented, re-monumented, recovered, found as expressed below:

NOTE: Not more than 4 corners, all in the same town and range, may be recorded on this certificate.

A. Description of original monument and accessories and/or subsequent restoration:

- W. Oak 14 in. Dia. S66E 62 Lks
- W. Oak 8 in. Dia. N64 1/2W 4.10 Lks
- B. Walnut 9" N20 1/2W 15 1/2' - 1915
- W. Oak 15" S3 1/4W 62' - 1915

SURVEY &
RECORDS
1993
COUNTY

B. Description of corner evidence found and/or method applied in restoring or reestablishing corner:

Corner Obliterated - Conflicting Corner 17.30 North in Centerline Brighton Road also obliterated.
Reestablished Corner by Retracement of Oct. 1928 Field Notes of C. W. Gordon and Measurement of the Mile Between NW and NE Section Corners

C. Description of monument for corner and accessories established to perpetuate locating the position of the corner:

Set 1 1/4" x 36" Breakaway Iron Pipe with Livingston Co. Brass Cap on Top

- North 74.80' Spike W/Side 12" Locust
- S80°W 25.05' Spike N/Side Power Pole
- S15°E 50.72' Spike W/Side 16" Oak
- S80°E 94.0' Top of Curb North End of Island
- North 19.3 Centerline Brighton Road

Approved by Livingston Co. Monumentation Peer Group on December 15, 1993

Signed by _____
Surveyor's Michigan License No. 29238

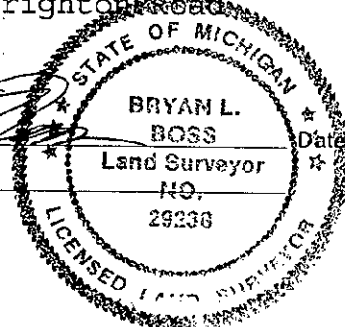

December 28, 1993