

9

1996 NOV 25 A 9 39

LAND CORNER RECORDATION CERTIFICATE
Filing Requirement of Act 74, Mich. P.A. 1970

NANCY HAVILAND
REGISTER OF DEEDS
LIVINGSTON COUNTY, MI.
48843

For Corners in GENOA TWP.

<u>LIVINGSTON</u> (COUNTY)	Located In	Corner Code #
1. Public Land Survey	T <u>2</u> N R <u>5</u> E	<u>M-2</u>
	T___ R___	_____
	T___ R___	_____
	T___ R___	_____
2. Property Controlling in Section	S___ T___ R___	_____
	S___ T___ R___	_____
3. Miscellaneous Property in Sec.,	S___ T___ R___	_____
	S___ T___ R___	_____
4. Lot No. _____, Recorded Plat _____		
5. Private Claims _____		

L. S. C. #604m
REGISTER OF DEEDS STAMP & FILE NUMBER

	A	B	C	D	E	F	G	H	I	J	K	L	M
2	6	5	4	3	2	1							
3													
4	7	8	9	10	11	12							
5													
6	18	17	16	15	14	13							
7													
8	19	20	21	22	23	24							
9													
10	30	29	28	27	26	25							
11													
12	31	32	33	34	35	36							
13													

I, BRYAN L. BOSS in a field survey on OCTOBER 29, 1996, do hereby certify that under requirements of P.A. 74, Michigan P.A. of 1970, the corner points mentioned in lines 1 and 2 above were in conformance with regulations and rules therefore as required in the current manual of survey instructions of the United States Department of the Interior, bureau of Land Management or by a decree of a Court of Law and/or that the corner points mentioned in lines 3, 4 and 5 above were in conformance with the rules of the Michigan Board of Land Surveyors or by a Decree of a Court of Law, established, re-established, monumented, re-monumented, recovered, found as expressed below:

NOTE: Not more than 4 corners, all in the same town and range, may be recorded on this certificate.

A. Description of original monument and accessories and/or subsequent restoration:

TOWNSHIP LINES AND CORNERS SET BY ALEX HOLMES IN 1816
WHITE OAK 20" S 5° E 121 LINKS
WHITE OAK 18" N 15° W 103 LINKS
YELLOW OAK 20" N 75° E 53

B. Description of corner evidence found and/or applied in restoring or reestablishing corner:

FOUND 1/2" IRON. WITNESSES CHECK SURVEY BY LESTOR DRAGOO RECORDED ON 7-10-72. NO OTHER CORNER LOCATED BY FIELD EVIDENCE, DESCRIPTION OR PREVIOUS SURVEYS.

C. Description of monument for corner and accessories established to perpetuate location the position of the corner:

SET 1 1/4 X 36" PIPE WITH A BRASS CAP MARKED, "LIVINGSTON COUNTY MONUMENTATION CORNER".

N 80° E NAIL & TAG SOUTH SIDE 4" CHERRY 7.96
S 10° E NAIL & TAG WEST SIDE 18" TRIPLE BASSWOOD 14.12
WEST NAIL & TAG NORTH SIDE 10" OAK 13.94
N 10° W NAIL & TAG EAST SIDE 14" OAK 13.78



Signed by Bryan L. Boss

Date 11-12-1996

Surveyor's Michigan License No. 29238

FORM APPROVED BY MICHIGAN STATE BOARD OF LAND SURVEYORS, JAN 28, 1971

REVISED MAY 14, 1975
REVISED JAN, 1983

P.A. 345 1990, APPROVED BY LIVINGSTON COUNTY
PEER GROUP ON 9-11-96, CO. REP VED

**SUMMARY
M-2**

East 1/4 Corner, Section 1, T2N-R5E, Genoa Township, Livingston County, Michigan.

Found 1/2" iron rod and 1/2" iron pipe side by side, and adjacent to a 2" pipe 4 feet above ground surface. The 2" pipe appears to be a protective marking pipe and not a survey point. The old Hacker Road bed Northerly is still open for vehicle travel. The area is heavily wooded and will be a difficult G.P.S. corner.

All witnesses on page 7, this dossier, refer to found 1/2" iron rod and these witnesses points check to the 1/2" iron.

(see page 6, this dossier).

Five surveyors measured Westerly to the Center of Section 1, approximately same.

Three surveyors measured Northerly to Northeast Corner approximately the same.

Two surveyors measured Southerly to Southeast Corner approximately the same.

The distance between the West 1/4 corner of Section 6, T2N-R6E, and the East 1/4 corner of Section 1, T2N-R5E, can be found on Charles Wilson's survey on pages 23 and 24. Mr. Wilson set the closing Corner (West 1/4 Corner, Sec. 6, T2N-R6E) by using the established Corner (M-1) and this Corner (M-2).

No other Corner location for M-2 has been found by: 1) Field evidence 2) Description or 3) previous surveys, THEREFORE,

We recommend acceptance of the 1/2" iron rod (witnessed by others) as the location of the East 1/4 corner, Section 1, T2N-R5E. (M-2).

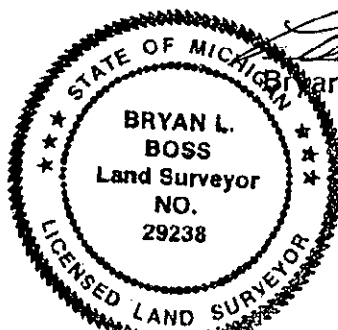

Bryan L. Boss
Bryan L. Boss No. 29238