

**SURVEY &  
REMONUMENTATION**

FILED

APR 28 1995

Nov 16 2 06 PM '94

COMMISSION

**LAND CORNER RECORDATION CERTIFICATE**

Filing Requirement of Act 74, Mich. P.A. 1970

NANCY HAVILAND  
REGISTER OF DEEDS  
LIVINGSTON COUNTY, MI  
48843

For corners in  
Livingston  
(County)

Located In: Corner Code ##

1. Public Land Survey	T	2N	R	5E	M-6
	T		R		
	T		R		
	T		R		
2. Property Controlling In Section	S		T	R	
	S		T	R	
3. Miscellaneous Property in Sec.	S		T	R	
	S		T	R	

L.S.C.#367m

Register of Deeds Stamp & File Number

4. Lot No. \_\_\_\_\_, Recorded Plat \_\_\_\_\_  
5. Private Claims \_\_\_\_\_

	A	B	C	D	E	F	G	H	I	J	K	L	M
2	6		5		4		3		2		1		
3													
4	7		8		9		10		11		12		
5													
6	18		17		16		15		14		13		
7													
8	19		20		21		22		23		24		
9													
10	30		29		28		27		26		25		
11													
12	31		32		33		34		35		36		
13													

I, Bryan BOSS, in a field survey on 10-27, 19 94, do hereby certify that under requirements of P.A. 74, Michigan P.A. of 1970, the corner points mentioned in lines 1 and 2 above were in conformance with regulations and rules therefore as required in the current manual of survey instructions of the United States Department of the Interior, Bureau of Land Management or by a decree of a Court of Law and/or that the corner points mentioned in lines 3, 4 and 5 above were in conformance with the rules of the Michigan Board of Land Surveyors or by a Decree of a Court of Law; established, re-established, monumented, re-monumented, recovered, found as expressed below:

NOTE: Not more than 4 corners, all in the same town and range, may be recorded on this certificate.

A. Description of original monument and accessories and/or subsequent restoration:

White Oak 12" S 19 W 11 Links  
Black Oak 8" N 44 E 68 Links  
Maple 5" S 45 E 43½

Additional data on back.

B. Description of corner evidence found and/or method applied in restoring or reestablishing corner:

Found ¼" inch iron rod 5 feet West of centerline of Hacker Road. At the surface near South edge of Driveway to house # 2626.

C. Description of monument for corner and accessories established to perpetuate locating the position of the corner:

Cored and set Monument Box. Set 1½" x 30" iron pipe with brass cap marked Livingston County Monument Corner.

West 29.55' N&T N/S 18"Walnut  
S45°W 48.48' N&T N/S 14"Walnut  
S80°E 32.33' N&T N/S 20" Cherry  
N50°E 34.78' N&T N/S 18"Cherry

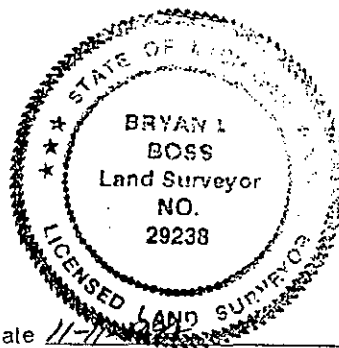

signed by Bryan L. Boss  
Surveyor's Michigan License No. 29238

Date 11-11-94

T2N-R5E  
M-6  
Page 1

SUMMARY

M-6

EAST 1/4 CORNER SECTION 13, T2N-R5E GENOA TOWNSHIP, LIVINGSTON COUNTY, MICHIGAN.

East Boundary Genoa Township originally surveyed 12-16-1815 by Holmes, Deputy Surveyor. Sections Surveyed by S. Sibley in 1823.

Found 1/2 " Inch Iron Rod 5' feet West of Centerline Hacker Road ( 22' feet asphalt) at the surface near South edge of Driveway to house #2626. Also found West 1/4 Corner of Section 18, T2N-R6E Brighton Township. Measured 101.50' feet jog which coincides with Clay Gordon & Garlock Field Notes, pages 13, 14 of this Dossier.

Measured to Witnesses found. Found 2 of 3 Clay Gordon Witnesses and they fall 1 foot ± East of existing Iron, pages 12, 13 and 36 this Dossier.

Found 3 of 3 Oscar Boss Witnesses, page 15, and they checked. Found 2 of 2 Garlock Witnesses and they fall 1 foot ± East of relocated Iron, page 14, this Dossier.

Found 3 of 3 Boss Engineering Witnesses and the checked, pages 16, 28 and 5 of 5 Witnesses Boss Engineering pages 30 and 35 also checked. Found 4 of 4 Munsell & Garlock Witnesses, pages 17, and they checked. Found 3 of 3 Patrick Benton Witnesses page 18 and they checked. Found 4 of 4 John Albright Witnesses, page 19 and 20 they checked. Found 4 of 4 Tri-County Surveys Witnesses and they checked, page 26.

Distances from the Southeast Corner of Section 13 to the East 1/4 Corner of said Section is 2656.7' feet Garlock Survey page 14 this Dossier. 2651.45' feet page 25 and 2651.42' feet page 34 Boss Engineering Surveys. 2651.30 FFinney Survey page 24 this Dossier.

Distances from Northeast Corner of Section 13 to the East 1/4 Corner of said Section is 2645.08' feet Pat Benton Survey page 29 this Dossier; 2644.93' feet page 22, 2645.09' feet page 23, 2644.97' feet page 32 Boss Engineering Surveys. Distances from E 1/4 Corner Section 13 to center of said Section is 2674.25' feet page 21; 2674.23' feet page 22 and 27; 2674.20' feet page 31, Boss Engineering Surveys. 2674.65' feet Tri-County Surveys page 26 this Dossier.

2675.29' feet Benton Survey page 29 this Dossier. This Corner located in a Residential Area with large overhanging trees (difficult for G.P.S.).

Conclusion: Clay Gordon 1947 Witnesses page 13, Garlock 1965 Witnesses page 14, and Patrick Benton distance page 29, place 1/4 Corner 1.06 East of existing Iron.

East 1/4 Corner may have been relocated to its present location in 1965. ( see field notes) page 14.

All distances North are consistent. Witnesses for Southeast Corner Section 13 show possibility of multiple Corner, which would justify difference East & West.

We recommend 1/2 inch iron as found to be the East 1/4 Corner of Section 13.



*Bryan L. Boss*